

DASH NO.	M CODE	MADE FROM
----------	--------	-----------

GSD

KC-59-294

REVISIONS	
ISSUE	CHANGES

6	CN 32932 E REDRAWN WJM 03/27/91
7	CN 36876 D MJB 03/22/96

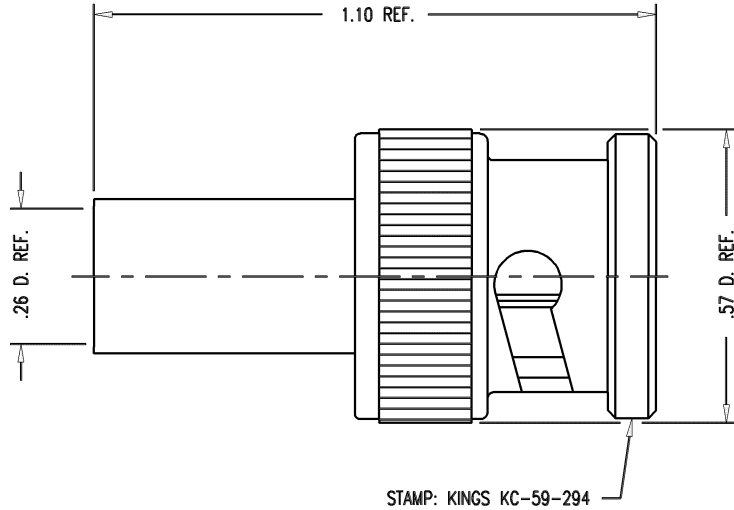

NOTES:

- FOR USE WITH RG-59, 59A, 59B, 62, 62A, 62C & 210/U CABLES.
- FOR CABLING INSTRUCTIONS SEE CP-401.
- FOR CABLE TRIMMING USE KTJ-57 & KTD-26.(KTD-27 USED ON INS. BUSHING)
- FOR CRIMPING USE DIE KTH-2002.
- CENTER CONTACT TO BE SUPPLIED UNASSEMBLED.
- INTERFACE PER MIL-STD-348, FIG. 301-1.
- MATERIALS:
 INSULATORS: TEFLON: ASTM-D-1457
 K-GRIP SLEEVE: COM. BRONZE TUBE, ALLOY 220
 GASKET: SILICONE RUBBER: ZZ-R-765
 OUTER CONTACT } BER. COPPER, ASTM-B-196
 SPRING WASHER }
 ALL OTHER METAL PARTS: BRASS, QQ-B-626
- FINISHES:
 SPRING WASHER: SILVER PLATE PER QQ-S-365
 CENTER CONTACT: HARD GOLD PLATE PER MIL-G-45204
 ALL OTHER METAL PARTS: KINGS TARNISH RESISTANT FINISH (TR-5)
- ELECTRICAL CHARACTERISTICS:
 NOMINAL IMPEDANCE: 50 OHMS
 WORKING VOLTAGE: 500 VRMS
 FREQUENCY RANGE: DC TO 4 GHz.

SCALE 4:1

APPROX SURFACE AREA

USED ON

REF:

PLUG, BNC

DRAWN	WJM	DATE	03/27/91
DESIGN	MJB	DATE	04/22/91
APPR.		DATE	

GSD

KINGS
ELECTRONICS CO., INC.
TUCKAHOE, NEW YORK 10707

KC-59-294