

Date - 4th August, 1998

e-mail = sales@casa.co.nz

Ref - BRACK-SS.FRP

## Angle BRACKET (Aerial Fixing etc.)

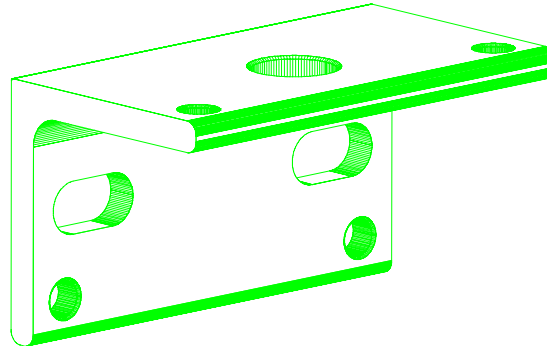

Our STANDARD 90 x 50 x 6 Brackets for fixing apparatus to Aerial Masts and Towers etc. (using CASA's Stainless U-Bolts or Coach Screws etc.) has been designed to provide durable fixing for Telecommunications Aerials, EMP Devices and externally mounted Electrical, Electronic and other equipments.

### Special Features Include:-

- 1) 4 x M8 Tapped Holes (UNC and other thread forms can be made to order) for grounding and other attachments
- 2) **Wide range** of Tube and Pipe sizes can be accommodated using CASA's U-Bolts etc.
- 3) "**Standard**" Coaxial "N" Connector mounting or custom fixing holes to suit EMP devices etc.
- 4) Pre-packaged **KITS** including all related, U-Bolts + nuts, washers etc. can be supplied to customer specifications
- 5) Manufactured in **New Zealand** using CNC machining.
- 6) **Professional Quality** at every level of design and manufacture.

**Other Accessories** including clamps and ancillary brackets "J-Bolts" and "Hook-Bolts" etc. can also be manufactured to customer drawing and specifications. Materials include Stainless, Aluminum, Brass, Copper, etc. Please enquire giving relevant details.

### Provisional Specification Details:- (see physical details on reverse of this data sheet)

<p><b>Standard Sizes:-</b>                      (others available subject design details)</p>	<p><b>Length = 90mm</b> (3-1/2 inch)  <b>Width = 50mm</b> (2 inch)  <b>Height = 50mm</b> (2 inch)  <b>Thickness = 6mm</b> (1/4 inch)</p>
<p><b>Tapped Threads Available:-</b>                      (other thread forms undertaken to special order)</p>	<p><b>M6, M8, M10, M12 etc.</b>                      (1/4", 5/16", 3/8" UNC/UNEF etc.)</p>
<p><b>Materials:-</b>                      (other alloys &amp; materials subject to special order)</p>	<p><b>Stainless 304</b>                      (316, Aluminum, Steel etc.)</p>
<p><b>Fixing / Clearance Holes:-</b>                      (generally depends upon requirements of other parts)</p>	<p><b>Diameter + 0.5mm</b>                      (recommended)</p>
<p><b>Tensile Rating:-</b></p>	<p><b>(to be calculated)</b></p>
<p><b>Weight:-</b>  <b>Size:-</b> (Length x Flange Width x Thickness as below)</p>	<p><b>(type / model specific)</b>  <b>(type / model specific)</b></p>
<p><b>Packaging:-</b> (CASA's welded Polyethylene bags and labels)</p>	<p><b>Loose or as required</b></p>

### Part Number:- BKT-LxWxT-FH-MD-MAT(suffix)

Please compose a Part Number according to this system and use on your official order.

**BKT-** Prefix to indicate "**BracKeT**"  
**LxWxT-** Profile Size of Angle Length x Width x Thickness in mm.  
**FH-** The "**Fixing Hole**" for the attached device in mm  
**MD-** Tube "**Mast**" Diameter **MAXIMUM** in millimeters  
**MAT** **MAT**erial designator where "**SS**" = Stainless Steel, "**AL**" = Aluminum etc.  
**(suffix)** Special adder/suffix, drawing, job ref. etc.