

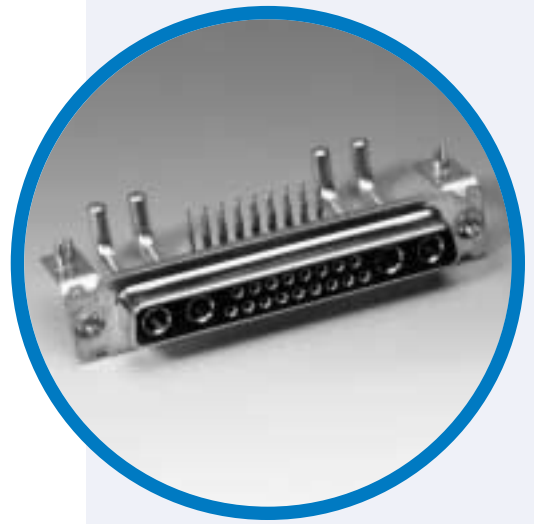

# TW

## Hybrid D'Sub series



### CONTENTS

#### Specifications

UL file: E64911 - CSA file: LR57744

Connectors according to: MIL C24308 - NFC93425 - HE507

Materials and platings		Electrical Data	
Shells	Steel - Tin plating or yellow chromate	Current rating	
Insulators	High temperature black thermoplastic	Signal contacts	7.5 A. with 10 A. peaks
Signal contacts	Female: machined bronze	Power contacts	
Material	Male: machined brass	PCB terminations	10 to 40 A.
Plating finish	16µ "Au over 79µ" Ni min.	Solder cup terminations	10 to 40 A.
Or	30µ "Au over 79µ" Ni min.	Crimp terminations	10 to 40 A.
Shielded contacts	Female: machined bronze	Shielded contacts	0.5 A.
Material	Male: machined brass	Voltage rating	
Plating		Signal and power contacts	300 V. R. M. S. at 50 Hz
Inner conductor	16µ "Au or 30µ Au over 79µ" Ni	Shielded contacts	150 V. R. M. S. at 50 Hz
Outer ring	10µ "Au over 79µ" Ni	Shielded contacts	
Terminations	Tinned	Frequency range	0 - 1 GHz
Except solder cup and crimp terminations	gold flash	Attenuation	0.2 dB
Power contacts	Female: machined bronze	V.S.W.R.	1.4 (+ 0.04/GHz)
Material	Male: machined brass	Characteristic impedance	50 Ohms
Plating		Dielectric withstanding voltage	≥ 1000 V.R.M.S. at 50Hz
Contacts	16µ "Au or 30µ" Au over 79µ" Ni	Insulation resistance	≥ 5000 M Ohms at 500 VDC
Terminations	Tinned	Contact resistance	≤ 5m Ohms
Except solder cup and crimp terminations	gold flash	Shell resistance (electrical grounding)	≤ 1m Ohm
Brackets	Steel - Tin plating or yellow chromate		
Front jackscrews	Brass - Tin plating or yellow chromate		
Rear clinch nuts	Brass - Tin plating or yellow chromate		
Boardlocks	Bronze - Tin plating		
Stand - off	Brass - Tin plating		

Climatic Data		Mechanical data	
Operating temperature	- 55°C + 155°C (with peaks up to 180°C)	Shells	With or without dimples
Damp heat	56 days (40°C - 95% HR)	Contact retention force in dielectric material	> 40N
Salt spray	48 hours	Maximum mating and unmating force	
		With dimples	E size = 70 N A size = 80 N B size = 100 N C size = 150 N D size = 180 N
		Without dimples	E size = 30 N A size = 50 N B size = 80 N C size = 120 N D size = 160 N
		Compatible with process	
		IR - Air convectioned	260° for 20 s.
		Resistance to solder iron heat	260° C for 30 s.
		Mating cycles	≥ 200 (classe II) or 500 (classe I)
		Blind mating system	Available upon request
		Polarization	Available with locking accessories Consult factory

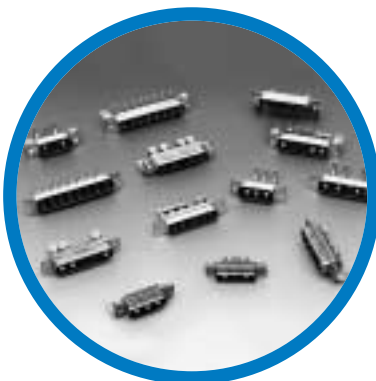

### DESCRIPTION

The new Amphenol D'Sub TW Hybrid Series permits a mix of contacts including signal, power, shielded, high voltage and fiber optics in the same housing with 18 different contacts arrangements.

This new economic series was developed from combination military series, and has improved features:

- new contacts
- new high temperature black thermoplastic insert
- PCB configurations come preloaded with fixed contacts and brackets.

These connectors are supplied with screw - machined contacts which are fixed in the insulator.

A complete range of housings is also available for cable application.

*A full range of arrangements compatible with reflow process*

### APPLICATIONS

- Industrial
- Military
- Telecom
- Any application requiring optimization of space

TW / E1



**Amphenol**

## Shells and contacts plating

### CLASS II

0.4µm (16µ") Au contacts gold plating  
200 mating cycles

Types	Shells and plating
17 TW	Yellow chromated shell <i>Male and female</i>
77 TW	Tin plated shell <i>Male and female</i>
717 TW	Tin plated shell with dimples <i>Male only</i>
	NOTE: Tin plated shells standard



### CLASS I

0.76µm (30µ") Au contacts gold plating  
500 mating cycles

Types	Shells and plating
117 TW	Yellow chromated shell <i>Male and female</i>
177 TW	Tin plated shell <i>Male and female</i>
777 TW	Tin plated shell with dimples <i>Male only</i>
	NOTE: Tin plated shells standard

## Housing arrangements

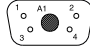
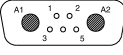
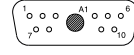
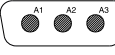
Male front view

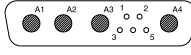
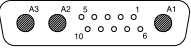
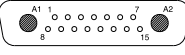
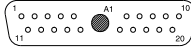
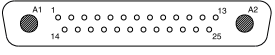
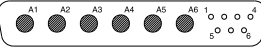
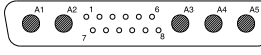
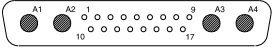
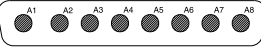
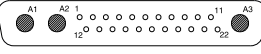
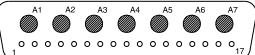
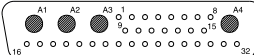
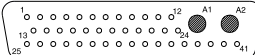
Arrangement ..... Shell size .....	 <b>5W1</b> <b>E</b>	 <b>7W2</b> <b>A</b>	 <b>11W1</b> <b>A</b>
Arrangement ..... Shell size .....	 <b>3W3</b> <b>A</b>	 <b>5W5</b> <b>B</b>	 <b>9W4</b> <b>B</b>
Arrangement ..... Shell size .....	 <b>13W3</b> <b>B</b>	 <b>17W2</b> <b>B</b>	 <b>21W1</b> <b>B</b>
Arrangement ..... Shell size .....	 <b>27W2</b> <b>C</b>	 <b>13W6</b> <b>C</b>	 <b>17W5</b> <b>C</b>
Arrangement ..... Shell size .....	 <b>21WA4</b> <b>C</b>	 <b>8W8</b> <b>C</b>	 <b>25W3</b> <b>C</b>
Arrangement ..... Shell size .....	 <b>24W7</b> <b>D</b>	 <b>36W4</b> <b>D</b>	 <b>43W2</b> <b>D</b>

## Shell size dimensions

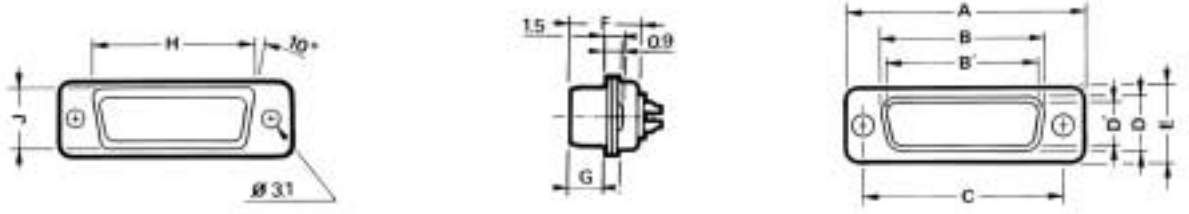

Shell size	Contact P: Pin S: Socket	A +0.25 (±.010)	B 0/-0.20 (0/- .008)	B' +0.20/0 (+.008/0)	C ±0.10 (±.004)	D 0/-0.25 (0/- .010)	D' +0.25/0 (+.010/0)	E ±0.20 (±.008)	F +0.05/-0.20 (+.002/- .008)	F' +0.10/-0.20 (+.004/- .008)	G +0.10/-0.20 (+.004/- .008)	G' ±0.10 (±.004)	H +0.10/-0.40 (+.004/- .016)	J 0/-0.50 (0/- .020)
E	P	30.7 (1.209")		16.8 (.661")	25.0 (.984")		8.2 (.323")	12.4 (.488")		10.9 (.429")		5.9 (.232")	19.4 (.764")	11.0 (.433")
	S		16.4 (.646")			8.0 (.315")			11.1 (.437")		6.2 (.244")			
A	P	39.0 (1.535")		25.1 (.988")	33.3 (1.311")		8.2 (.323")	12.4 (.488")		10.9 (.429")		5.9 (.232")	27.7 (1.091")	11.0 (.433")
	S		24.8 (.976")			8.0 (.315")			11.1 (.437")		6.2 (.244")			
B	P	52.9 (2.083")		38.8 (1.528")	47.0 (1.850")		8.2 (.323")	12.4 (.488")		11.0 (.433")		5.8 (.228")	41.4 (1.630")	11.0 (.433")
	S		38.5 (1.513")			8.0 (.315")			11.1 (.437")		6.2 (.244")			
C	P	69.2 (2.724")		55.3 (2.177")	63.5 (2.500")		8.2 (.323")	12.4 (.488")		11.0 (.433")		5.8 (.228")	57.9 (2.280")	11.0 (.433")
	S		54.9 (2.161")			8.0 (.315")			11.1 (.437")		6.2 (.244")			
D	P	66.8 (2.630")		52.7 (2.075")	61.1 (2.406")		11.0 (.433")	15.2 (.598")		11.0 (.433")		5.8 (.228")	55.5 (2.185")	13.8 (.543")
	S		52.5 (2.067")			10.9 (.429")			11.1 (.437")		6.2 (.244")			

## Panel cutouts

Optimal cutout for rear mounting

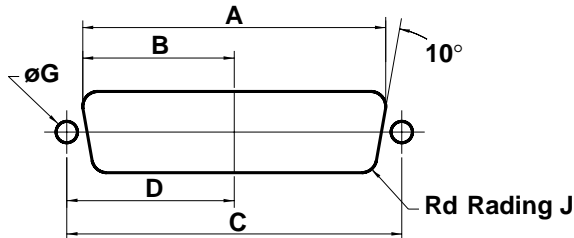

Standard cutout

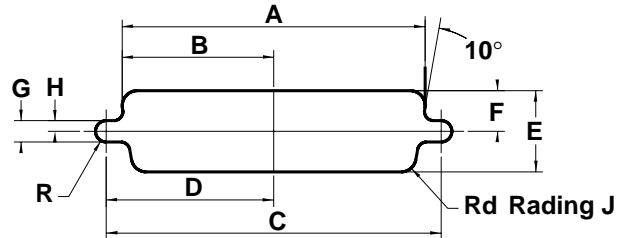

Shell size	Mounting method	A ±0.20 (±.008)	B ±0.20 (±.008)	C ±0.20 (±.008)	D ±0.20 (±.008)	E ±0.20 (±.008)	F ±0.20 (±.008)	G ±0.20 (±.008)	H ±0.20 (±.008)	J ±0.20 (±.008)
E	Front	22.2 (.874")	11.1 (.437")	25.0 (.984")	12.5 (.492")	13.0 (.512")	6.5 (.256")	3.0 (.118")	1.5 (.059")	2.1 (.083")
	Rear	20.5 (.807")	10.2 (.402")			11.4 (.449")	5.7 (.224")			3.4 (.134")
A	Front	30.5 (1.201")	15.3 (.602")	33.3 (1.311")	16.7 (.657")	13.0 (.512")	6.5 (.256")	3.0 (.118")	1.5 (.059")	2.1 (.083")
	Rear	28.8 (1.134")	14.4 (.567")			11.4 (.449")	5.7 (.224")			3.4 (.134")
B	Front	44.3 (1.744")	22.1 (.870")	47.0 (1.850")	23.5 (.925")	13.0 (.512")	6.5 (.256")	3.0 (.118")	1.5 (.059")	2.1 (.083")
	Rear	42.5 (1.673")	21.3 (.839")			11.4 (.449")	5.7 (.224")			3.4 (.134")
C	Front	60.7 (2.390")	30.4 (1.197")	63.5 (2.500")	31.7 (1.248")	13.0 (.512")	6.5 (.256")	3.0 (.118")	1.5 (.059")	2.1 (.083")
	Rear	59.1 (2.327")	29.5 (1.161")			11.4 (.449")	5.7 (.224")			3.4 (.134")
D	Front	58.3 (2.295")	29.2 (1.150")	61.1 (2.406")	30.6 (1.205")	15.8 (.622")	7.9 (.311")	3.0 (.118")	1.5 (.059")	2.1 (.083")
	Rear	56.3 (2.217")	28.2 (1.110")			14.1 (.555")	7.1 (.280")			3.4 (.134")

## Straight connector footprint

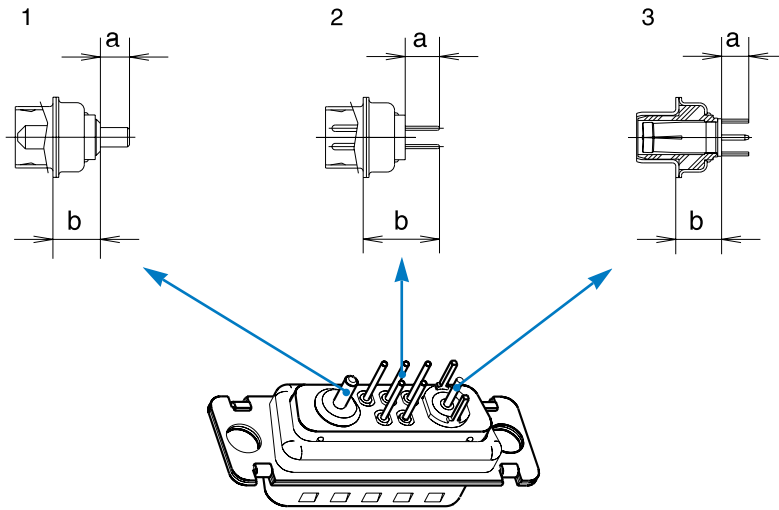

Signal tail 0.6 mm Dia. (.0236")  
 1.6 mm (.063")PCB  
 For other PCB thickness: consult factory.

Description		Dimensions	
		a	b
Power (.126" tail dia.)	1	4.50 mm (.177")	7.2 mm (.283")
Power (.0787" tail dia.)	1	4.50 mm (.177")	7.2 mm (.283")
Shielded	3	4.00 mm (.157")	7.2 mm (.283")
Signal	2	5.00 mm (.196")	11.50 mm (.453")

## Straight contact combinations

Arrangement with signal contacts

Arrangement without signal contacts  
 3W3 - 5W5 - 8W8

See above dimensions	Size 8 and 20 Contacts	See above dimensions	Size 8 Contacts
P 3SY	Power 3.2 mm DIA. (.126") (20 to 40 A) and signal	P 3Y	Power only 3.2 mm DIA. (.126") (20 to 40 A)
P 2SY	Power 2 mm DIA. (.0787") (10 to 20 A) and signal	P 2Y	Power only 2 mm DIA. (.0787") (10 to 20 A)
CSY	Shielded and signal	CY	Shielded only
SY	Signal only		
No reference	Signal (Size 20) with solder cup terminations Housing preloaded with contacts		



## Right angle connector footprint

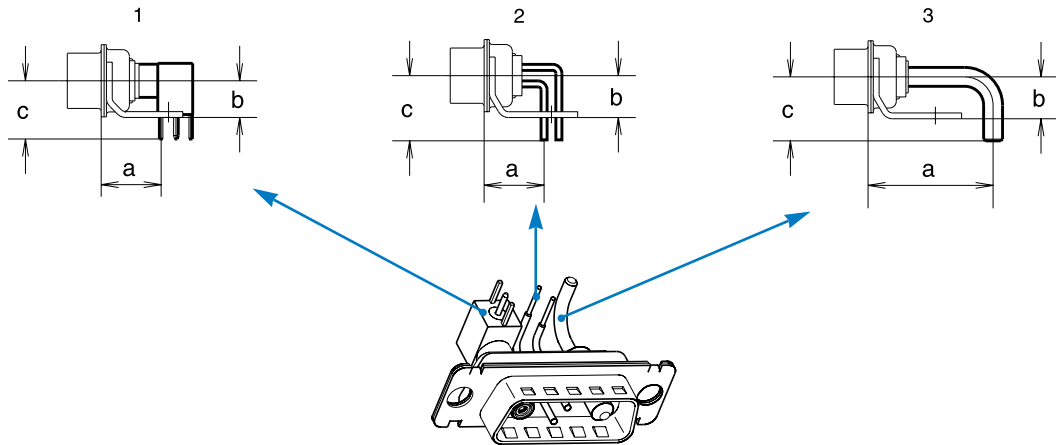

Signal tail 0.6 mm Dia. (.0236")  
 1.6 mm (.063") PCB  
 For other PCB thickness: consult factory.

Description	Europe			Mix			MIL			
	a	b	c	a	b	c	a	b	c	
Shielded	1	-	-	10.30mm (.406")	6.30mm (.248")	10.00mm (.394")	10.30mm (.406")	6.30mm (.248")	10.00mm (.394")	
Signal	2	10.30mm (.406")	7.20mm (.283")	11.20mm (.441")	10.30mm (.406")	6.30mm (.248")	9.50mm (.374")	8.10mm (.319")	6.30mm (.248")	9.50mm (.374")
Power (.0787" tail dia.)	3	11.57mm (.456")	7.20mm (.283")	10.50mm (.413")	11.57mm (.456")	6.30mm (.248")	9.50mm (.374")	9.52mm (.375")	6.30mm (.248")	9.50mm (.374")
Power (.126" tail dia.)	3	21.46mm (.845")	7.20mm (.283")	10.50mm (.413")	21.46mm (.845")	6.30mm (.248")	9.50mm (.374")	21.46mm (.845")	6.30mm (.248")	9.50mm (.374")

Note: above dimensions correspond to sizes E to C. Consult factory for D sizes.

Connector comes equipped with contacts and brackets.

## Right angle contacts combinations

Arrangements with signal contacts

Arrangement without signal contacts

3W3 - 5W5 - 8W8

European footprint	Mixed footprint	MIL (U.S.) footprint	Size 8 and 20 contacts	European footprint	Mixed footprint	MIL (U.S.) footprint	Size 8 contacts only
EP3SV	HP3SV	MP3SV	Power 3.2 mm DIA. (.126") (20 to 40 A) and signal	EP3V	HP3V	MP3V	Power only 3.2 mm DIA. (.126") (20 to 40 A)
EP2SV	HP2SV	MP2SV	Power 2 mm DIA. (.0787") (10 to 20 A) and signal	EP2V	HP2V	MP2V	Power only 2.0 mm DIA. (.0787") (10 to 20 A)
-	HCSV	MCSV	Shielded and signal	-	HCV	MCV	Shielded only
ESV	HSV	MSV	Signal only				

## Mounting options

### Right angle version

Connectors come equiped with metal brackets

BLANK: 3,10 (.122") dia mounting hole

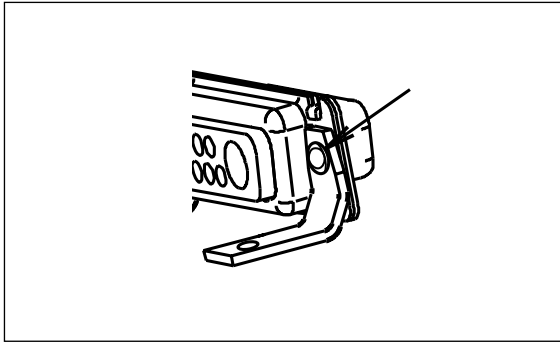

RM6: metal brackets + boardlock

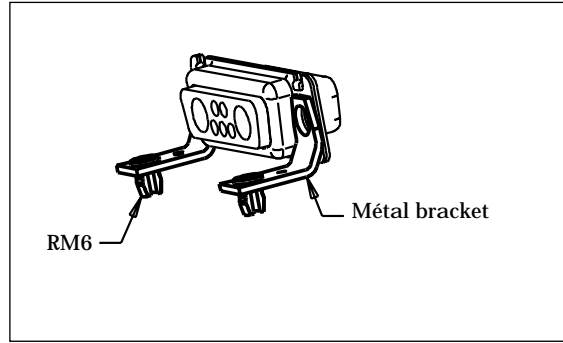

### Straight version

BLANK: 3,10 (.122") dia mounting hole

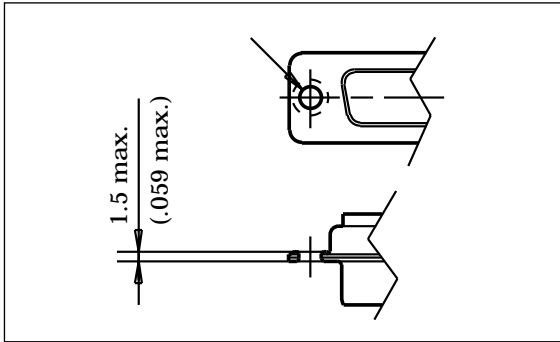

RM54: RM5 4.40 threaded  
RM53: RM5 M3 threaded

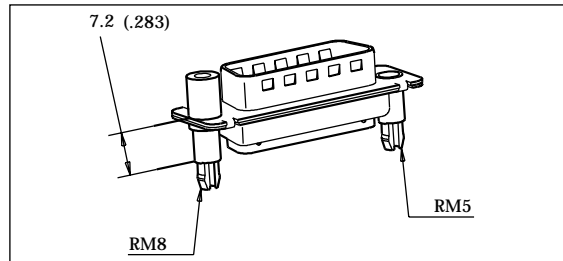

RM84: RM8 4.40 threaded  
RM83: RM8 M3 threaded

A514: blind mating system

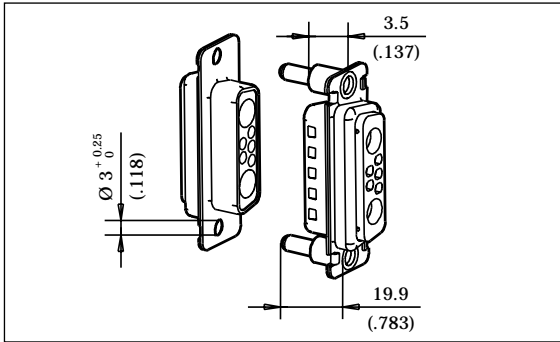

FM: float mounting system

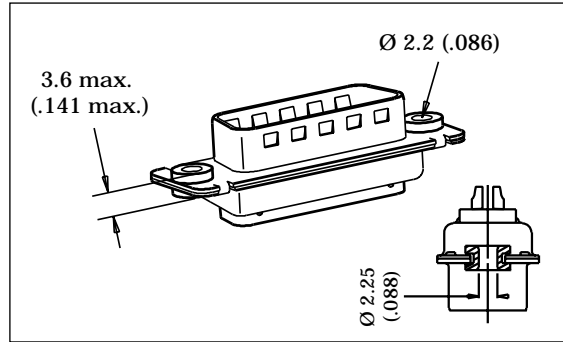

### Straight and right angle version

4R: 4.40 rear nut  
3R: M3 rear nut

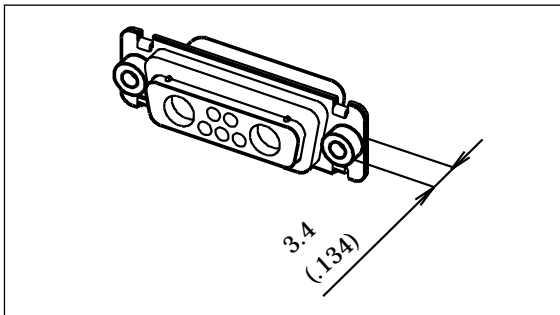

4F: 4.40 front female screwlock  
3F: M3 front female screwlock

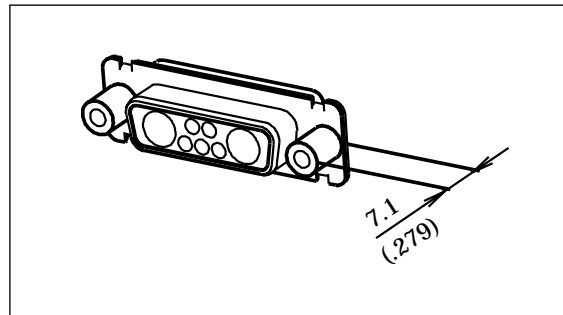

## High power contacts

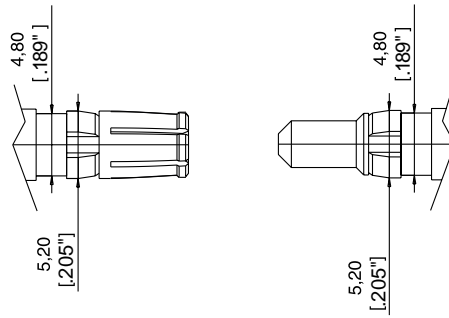

## Solder cup version

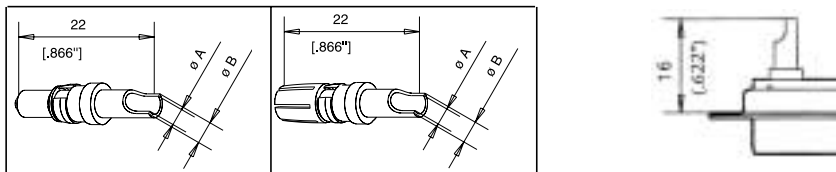

Plug	P/N Socket	Current	Dimensions	
			A mm (inch)	B mm (inch)
17DM 53745-8	17DM 53744-7	10 to 20 Amp.	1.80 (.071")	2.55 (.100")
17DM 53745-7	17DM 53744-6	20 to 30 Amp.	2.80 (.110")	3.70 (.145")
17DM 53745-1	17DM 53744-1	30 to 40 Amp.	4.80 (.189")	5.60 (.220")

Trim dimensions: 7.5 mm (.295")

## Crimp version

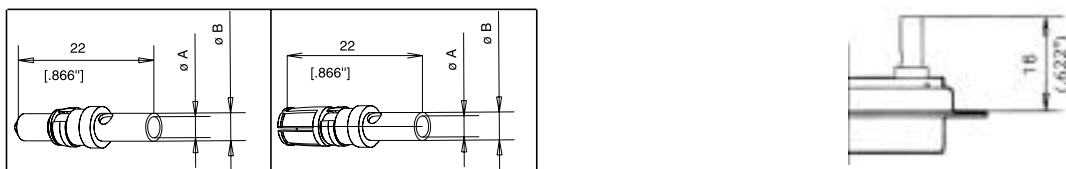

Plug	P/N Socket	Current	Dimensions	
			A mm (inch)	B mm (inch)
17DM 53745-208	17DM 53744-207	10 to 20 Amp.	1.80 (.071")	2.55 (.100")
17DM 53745-207	17DM 53744-206	20 to 30 Amp.	2.80 (.110")	3.70 (.145")
17DM 53745-201	17DM 53744-201	30 to 40 Amp.	4.80 (.189")	5.60 (.220")

Trim dimensions: 7.5 mm (.295")

Crimping tool for all sizes  
17D479SP



Extraction tool for sizes 8 cts  
17D429SP



## Straight shielded contacts

Crimp ferrule/Inner solder

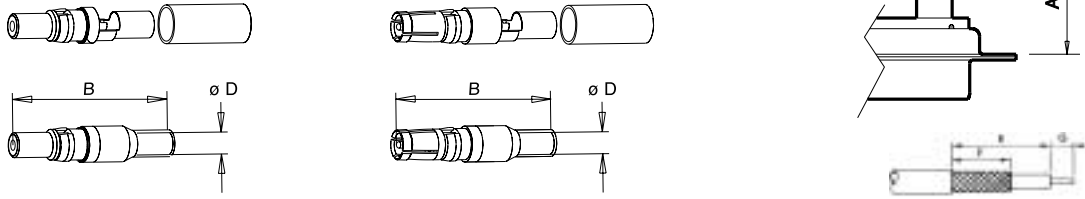

Type	P/N	Dimensions (inch)			Cable - RG	Trim dimensions (inch)		
		A Max	B	D		E	F	G
plug	17DM 53740	18.8 (.740")	23.6 (.929")	1.0 (.039")	178 B/U	7.9 (.311")	6.3 (.248")	2 (.078")
plug	17DM 53740-1	18.8 (.740")	23.6 (.929")	1.7 (.066")	179 B/U 316 B/U	7.9 (.311")	6.3 (.248")	2 (.078")
plug	17DM 53740-3	21.5 (.846")	23.6 (.929")	2.8 (.110")	180 B/U	9.5 (.374")	7.9 (.311")	2 (.078")
plug	17DM 53740-5	21.5 (.846")	23.6 (.929")	3.2 (.126")	58 C/U	9.5 (.374")	7.9 (.311")	2 (.078")
socket	17DM 53742	18.8 (.740")	23.6 (.929")	1.0 (.039")	178 B/U	7.9 (.311")	6.3 (.248")	2 (.078")
socket	17DM 53742-1	18.8 (.740")	23.6 (.929")	1.7 (.066")	179 B/U 316 B/U	7.9 (.311")	6.3 (.248")	2 (.078")
socket	17DM 53742-3	21.5 (.846")	23.6 (.929")	2.8 (.110")	180 B/U	9.5 (.374")	7.9 (.311")	2 (.078")
socket	17DM 53742-5	21.5 (.846")	23.6 (.929")	3.2 (.126")	58 C/U	9.5 (.374")	7.9 (.311")	2 (.078")

Ferrule and inner solder

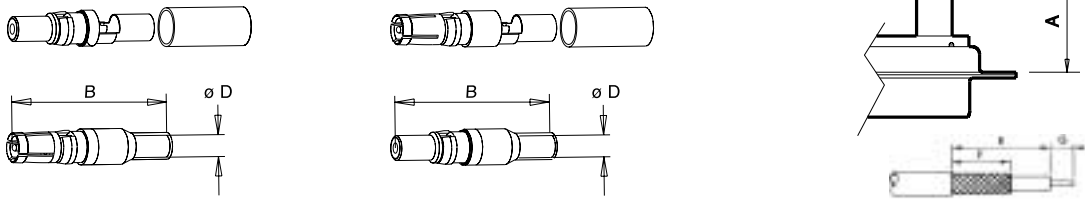

Type	P/N	Dimensions (inch)			Cable - RG	Trim dimensions (inch)		
		A Max	B	D		E	F	G
short plug	17DM 53740-5000	17.0 (.669")	21.8 (.858")	1.0 (.039")	178 B/U	7.9 (.311")	6.3 (.248")	2 (.078")
plug	17DM 53740-5001	18.8 (.740")	23.6 (.929")	1.7 (.066")	179 B/U 316 B/U	7.9 (.311")	6.3 (.248")	2 (.078")
plug	17DM 53740-5002	21.5 (.846")	26.3 (1.035")	2.8 (.110")	180 B/U	9.5 (.374")	7.9 (.311")	2 (.078")
plug	17DM 53740-5005	21.5 (.846")	26.3 (1.035")	3.2 (.126")	58 C/U	9.5 (.374")	7.9 (.311")	2 (.078")
plug	17DM 53740-5008	18.8 (.740")	23.6 (.929")	1.0 (.039")	178 B/U	7.9 (.311")	6.3 (.248")	2 (.078")
short socket	17DM 53742-5000	17.0 (.669")	21.8 (.858")	1.0 (.039")	178 B/U	7.9 (.311")	6.3 (.248")	2 (.078")
socket	17DM 53742-5001	18.8 (.740")	23.6 (.929")	1.7 (.066")	179 B/U 316 B/U	7.9 (.311")	6.3 (.248")	2 (.078")
socket	17DM 53742-5002	21.5 (.846")	26.3 (1.035")	2.8 (.110")	180 B/U	9.5 (.374")	7.9 (.311")	2 (.078")
socket	17DM 53742-5004	21.5 (.846")	26.3 (1.035")	3.2 (.126")	58 C/U	9.5 (.374")	7.9 (.311")	2 (.078")
socket	17DM 53742-5006	18.8 (.740")	23.6 (.929")	1.0 (.039")	178 B/U	7.9 (.311")	6.3 (.248")	2 (.078")



## Right angled shielded contact

Crimp ferrule/Inner solder

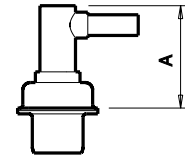
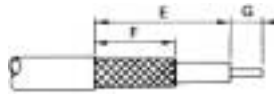
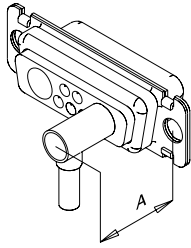

Type	P/N	Dimensions (inch)				Cable - RG	Trim dimensions (inch)		
		A Max	B	C	D		E	F	G
plug	17DM 53741	13.5 (.531")	18.6 (.732")	12.5 (.492")	1.0 (.039")	178 B/U	9.5 (.374")	5.9 (.232")	1.6 (.062")
plug	17DM 53741-1	13.5 (.531")	18.6 (.732")	12.5 (.492")	1.7 (.066")	179 B/U 316 B/U	9.5 (.374")	5.9 (.232")	1.6 (.062")
plug	17DM 53741-3	13.5 (.531")	18.6 (.732")	15.3 (.602")	2.8 (.110")	180 B/U	10.7 (.421")	7.9 (.311")	2.4 (.094")
plug	17DM 53741-4	13.5 (.531")	18.6 (.732")	15.3 (.602")	3.2 (.126")	58 C/U	10.7 (.421")	7.9 (.311")	2.4 (.094")
socket	17DM 53743-2	13.5 (.531")	18.6 (.732")	12.5 (.492")	1.0 (.039")	178 B/U	9.5 (.374")	5.9 (.232")	1.6 (.062")
socket	17DM 53743-3	13.5 (.531")	18.6 (.732")	12.5 (.492")	1.7 (.066")	179 B/U 316 B/U	9.5 (.374")	5.9 (.232")	1.6 (.062")
socket	17DM 53743-5	13.5 (.531")	18.6 (.732")	15.3 (.602")	2.8 (.110")	180 B/U	10.7 (.421")	7.9 (.311")	2.4 (.094")
socket	17DM 53743-6	13.5 (.531")	18.6 (.732")	15.3 (.602")	3.2 (.126")	58 C/U	10.7 (.421")	7.9 (.311")	2.4 (.094")

Ferrule and inner solder

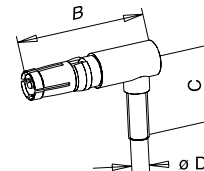
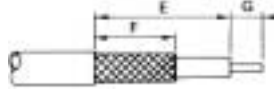
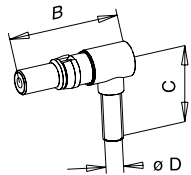

Type	P/N	Dimensions (inch)				Cable - RG	Trim dimensions (inch)		
		A Max	B	C	D		E	F	G
plug	17DM 53741-5000	13.5 (.531")	18.6 (.732")	12.5 (.492")	1.0 (.039")	178 B/U	9.5 (.374")	5.9 (.232")	1.6 (.062")
plug	17DM 53741-5001	13.5 (.531")	18.6 (.732")	12.5 (.492")	1.7 (.066")	179 B/U 316 B/U	9.5 (.374")	5.9 (.232")	1.6 (.062")
plug	17DM 53741-5003	13.5 (.531")	18.6 (.732")	13.9 (.547")	2.8 (.110")	180 B/U	10.7 (.421")	7.9 (.311")	2.4 (.094")
plug	17DM 53741-5004	13.5 (.531")	18.6 (.732")	13.9 (.547")	3.2 (.126")	58 C/U	10.7 (.421")	7.9 (.311")	2.4 (.094")
socket	17DM 53743-5000	13.5 (.531")	18.6 (.732")	12.5 (.492")	1.0 (.039")	178 B/U	9.5 (.374")	5.9 (.232")	1.6 (.062")
socket	17DM 53743-5001	13.5 (.531")	18.6 (.732")	12.5 (.492")	1.7 (.066")	179 B/U 316 B/U	9.5 (.374")	5.9 (.232")	1.6 (.062")
socket	17DM 53743-5003	13.5 (.531")	18.6 (.732")	13.9 (.547")	2.8 (.110")	180 B/U	10.7 (.421")	7.9 (.311")	2.4 (.094")
socket	17DM 53743-5004	13.5 (.531")	18.6 (.732")	13.9 (.547")	3.2 (.126")	58 C/U	10.7 (.421")	7.9 (.311")	2.4 (.094")

## Crimping tool

Hand crimp tool

227-0944 (without dies) (M 22 520/5-01)

RG cables	MIL reference	Amphenol P/N	dim. between 2 flat surface	
			cavity A	cavity B
RG 58 C/U	M 22 520/5-05	227 1221-05	5.41	-
RG 178 B/U	M 22 520/5-03	227 1221-03	-	2.67
RG 179 B/U	M 22 520/5-03	227 1221-03	3.25	-
RG 180 B/U	M 22 520/5-05	227 1221-05	-	4.52

## Extraction tool

Crimping tool for all sizes  
Amphenol ref: 227-0994 - MIL ref: M22520/5-01



Extraction tool for sizes 8 cts  
17D429SP



## Cabling instructions for shielded contacts

**Straight crimp shielded contacts:** *inner solder contact*  
*outer crimp contact*

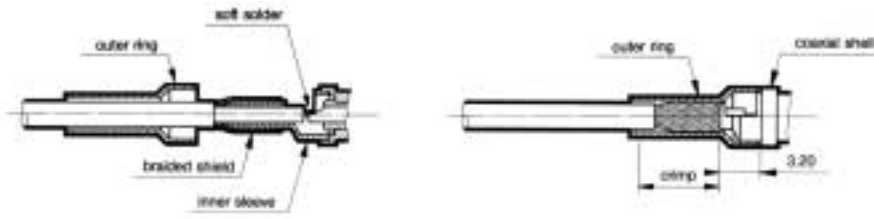

**Right angle crimp shielded contacts:** *inner solder contact*  
*outer crimp contact*

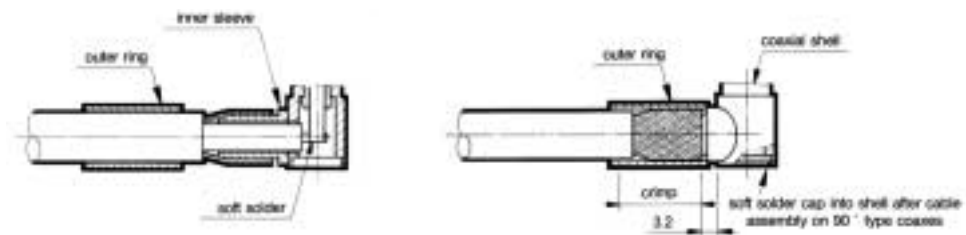

### Assembly method

- Slide the outer ring over the cable jacket. Trim the cable according to the recommended dimensions.
- Insert the cable dielectric and the center conductor inside the inner sleeve.
- Solder the central conductor to the shielded center contacts.
- Slide the outer ring towards the inner sleeve and recover the braid.
- Using crimp hand tool equipped with the appropriate dies, crimp in the area defined.

### Solder straight shielded contacts

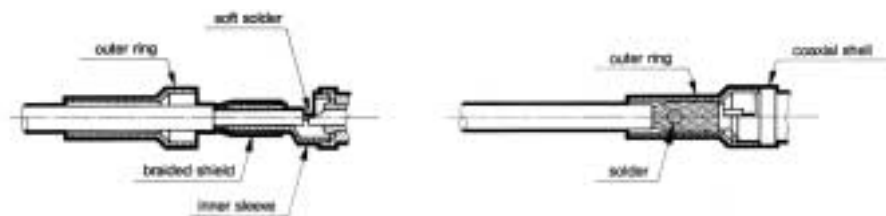

### Solder right angle shielded contacts

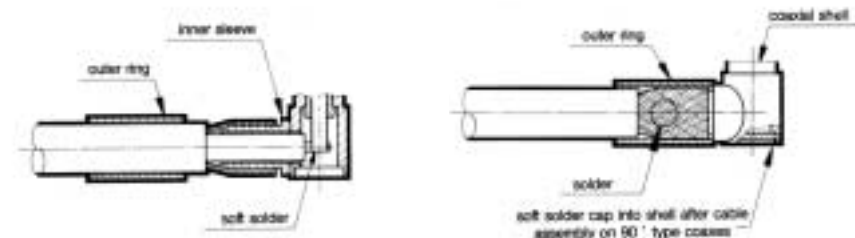

### Assembly method

- Slide the outer ring over the cable jacket. Trim the cable according to the recommended dimensions.
- Insert the cable dielectric and the center conductor inside the inner sleeve.
- Solder the central conductor to the shielded center contacts.
- Slide the outer ring towards the inner sleeve and recover the braid.
- Solder by introducing metal through the outer ring hole.

# How to build your part number

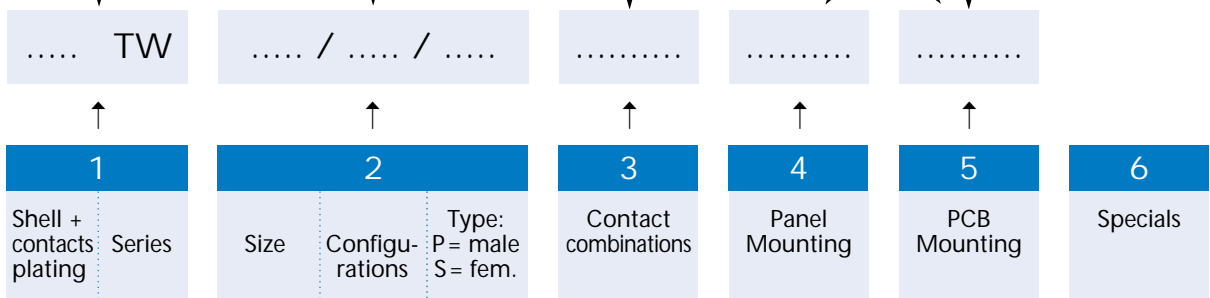
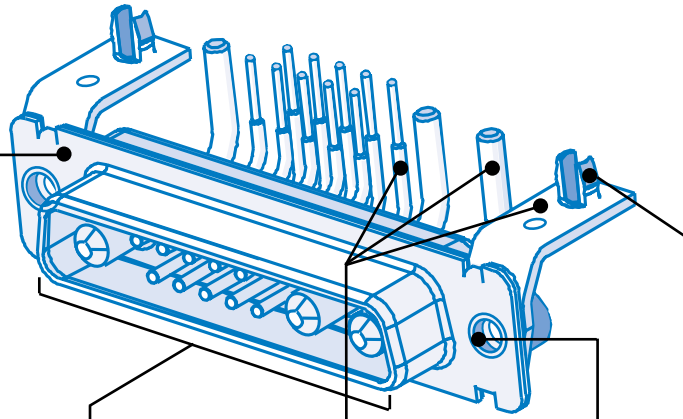

Page 2		Page 2			Page 4/5	Page 6	Page 6	
17	TW	E	5W1	P/S	XP3SV	4F	RM6	Consult factory
77	TW	A	3W3	P/S	XP2SV	4R	RM53	
717	TW	A	7W2	P/S	XP2V	3F	RM54	
117	TW	A	11W1	P/S	XP3V	3R	RM83	
177	TW	B	5W5	P/S	P2Y	A514	RM84	
777	TW	B	9W4	P/S	P3Y	FM		
		B	13W3	P/S	XCSV			
		B	17W2	P/S	XHCV			
		B	21W1	P/S	CY			
		C	8W8	P/S	XSV			
		C	13W6	P/S	SY			
		C	17W5	P/S	P3SY			
		C	21WA4	P/S	P2SY			
		C	25W3	P/S	CSY			
		C	27W2	P/S				
		D	24W7	P/S				
		D	36W4	P/S				
		D	43W2	P/S				

Blank: solder cup signal contacts size 20 only

Consult factory for D size configurations

