

Series AW

Type AW

Wirewound single turn rotary potentiometers

Basic design: encased, nominal width 24 mm,
wire tag terminations

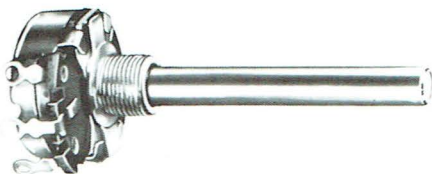

Ordering code no. 310460....

Also available as ganged potentiometer

Ordering code no. 310470....

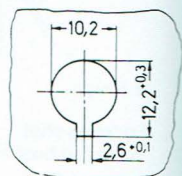
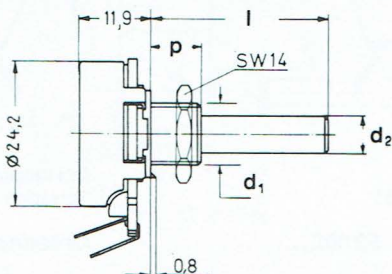
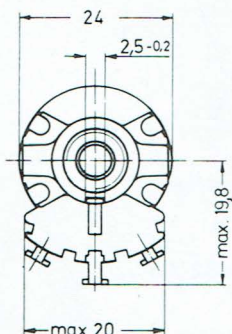

Electrical Specification

Rated resistance range: 1 Ω - 25 k Ω
 Law (resistance taper): lin
 Tolerance of rated resistance: $\pm 10\%$, < 10 Ω $\pm 20\%$
 $\pm 5\%$, $\pm 2\%$ on request
 Rated dissipation: 4 W / 40 $^\circ$ C
 Independent linearity: $\pm 2\%$
 Limiting element voltage: 500 V
 Isolation voltage: 1 kV~
 Total electr. travel: 280 $^\circ$ $\pm 5^\circ$

Mechanical Specification

Starting torque: 0,7 - 3,6 Ncm
 End stop torque: 115 Ncm
 Total mech. travel: 300 $^\circ$ $\pm 10^\circ$
 Spindle: metal
 plastic moulded on request

l	p	d ₂	d ₁
standard 50 mm	8 or 12 mm	6 mm	M 10 x 75

Temperature coefficient and resolution

Rated resistance	10 Ω	22 Ω	47 Ω	100 Ω	220 Ω	470 Ω	1 k Ω	2,2 k Ω	4,7 k Ω	10 k Ω	22 k Ω
T.C. value, 10 $^{-6}$ / $^\circ$ C	+400	+400	+40 -80	+40 -80	+40 -80	+140	± 20	± 20	± 20	± 20	± 20
Resolution, %	0,75	0,75	0,7	0,5	0,35	0,35	0,3	0,3	0,2	0,15	0,13

Technical details subject to change.



AB Elektronik GmbH

Postbox 11 51 · D-59 354 Werne

Tel. (0 23 89) 788-0

Telefax (0 23 89) 788 190