

SMA

In-Series Adapters

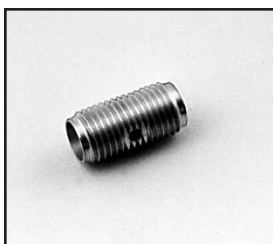

Female to Female Adapter

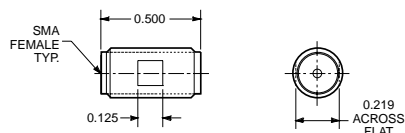

Tensolite Part No.	Max. VSWR DC - 18.0 GHz
5191CC	1.05 + .005 fGHz

Center conductor is captivated.

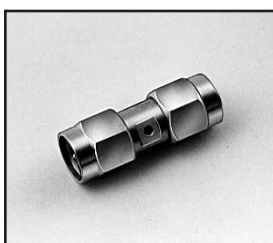

Male to Male Adapter

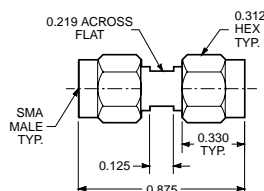

Tensolite Part No.	Max. VSWR DC - 18.0 GHz
5390CC	1.05 + .005 fGHz

Center conductor is captivated.

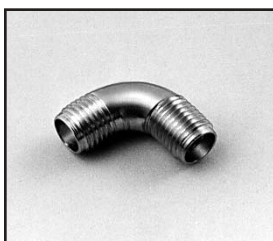

Radius Right Angle Female to Female Adapter

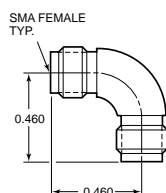

Tensolite Part No.	Max. VSWR DC - 18.0 GHz
5095	1.06 + .005 fGHz

Add suffix CC to Part No. for captivated contact.



Radius Right Angle Male to Male Adapter

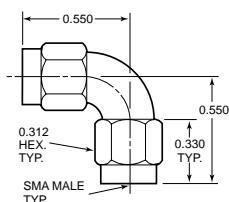

Tensolite Part No.	Max. VSWR DC - 18.0 GHz
5065	1.06 + .005 fGHz

Add suffix CC to Part No. for captivated contact.