

**SQUARE FLANGE JACK RECEPTACLE  
WITH SPECIAL CONTACT**

**R608.405.007**  
**SERIES TQ**

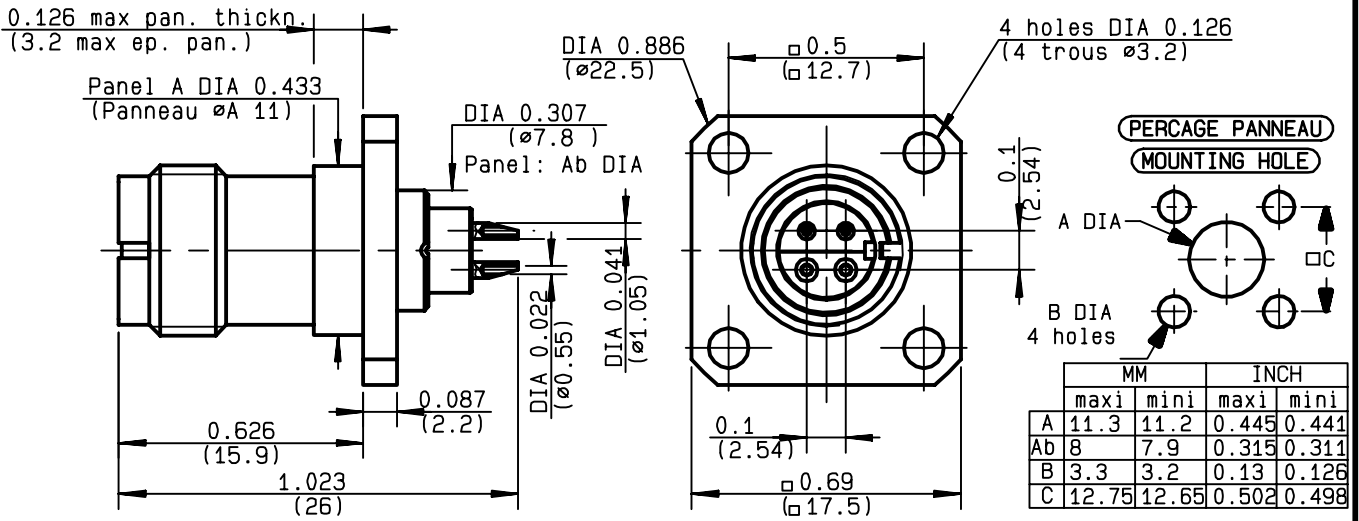

NOMINAL IMPEDANCE	<b>120</b>	Ω
FREQUENCY RANGE	<b>0-0.03</b>	GHz
TEMPERATURE RATING	<b>-55/+155</b>	°C
V.S.W.R	<b>NA</b> +	x F(GHz)Maxi
RF INSERTION LOSS	<b>NA</b>	√F(GHz) dB Maxi
VOLTAGE RATING	<b>250</b>	Veff Maxi
DIELECTRIC WITHSTANDING VOLTAGE	<b>750</b>	Veff Mini
INSULATION RESISTANCE	<b>5000</b>	MΩMini
HERMETIC SEAL	<b>NA</b>	Atm.cm <sup>3</sup> /s
LEAKAGE (pressurized only)	<b>NA</b>	
MECHANICAL DURABILITY	<b>100</b>	Cycles
WEIGHT	<b>10.84</b>	gr
SPECIFICATION		

CABLES :

OTHERS CHARACTERISTICS

**According to Spec. :B4R062631AB issue X3**

CABLE RETENTION	<b>NA</b>	N Mini
CENTER CONTACT RETENTION		
Axial force - mating end	<b>10</b>	N Mini
Axial force - opposite end	<b>10</b>	N Mini
Torque	<b>NA</b>	cm.N Mini
RECOMMENDED TORQUES		
Mating	<b>NA</b>	cm.N
Panel nut	<b>NA</b>	cm.N
Clamp nut	<b>NA</b>	cm.N

CONNECTOR PARTS:	MATERIALS	FINISH	(all values are given in micrometers)
BODY	BRASS	BBR 2	
OUTER CONTACT			
CENTER CONTACT	BERYLLIUM COPPER, BRASS	GOLD 1.3 OVER COPPER 0.5	
INSULATOR	PTFE	-	
GASKET		-	
OTHERS PIECES			

ISSUE	CREATION DATE	FILE PART-NUMBER
<b>9937B00</b>	<b>31/07/1996</b>	<b>96-0132-048</b>



LELEU

The information given here is subject to change without notice.  
Design changes may be in order to improve the product .

*Connect to the future*