



L309/1 Terminal

A heavy current terminal with a non-rotating head for lettering. The rotating collar is captive and the clamping gap is free from threads.

Current rating: ___ 30 A

Temperature

range: ___ -25 °C to + 85 °C

Materials: ___ Head, phenolic resin
Disc, tenite butyrate
Stem, brass, nickel
plated

Colours: ___ Head, black
Disc, red or black

Weight: ___ 25,5 g average



L309/1
with F Fitting.

F panel fittings

Comprises: ___ Phenolic resin
moulding. SRBP
insulating washer.
Metal washer
2 locknuts

Breakdown

voltage: ___ >3 kVd.c.

Insulation

resistance: ___ $\geq 10^3$ megohms

Panel thickness: 1,6 mm to 23,8 mm

Temperature

range: ___ -25 °C to + 85 °C
(ambient)

Fixing torque: ___ 2,1 Nm to 3,5 Nm

Colour: ___ Black

Ordering reference:
L309/1/Colour
F panel fittings

(Terminals and fittings are supplied
unassembled and must be ordered as
individual items.)

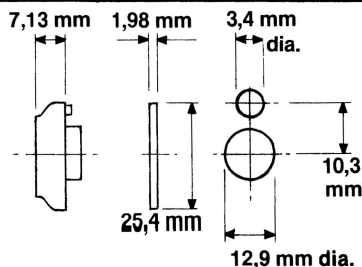
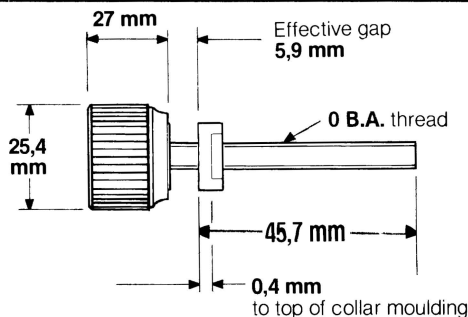

Panel cut-out