

Panel Mounted Hermetic Feedthrough Capacitors

**[Key Characteristics**

**Applications**

- High density panels
- Bulkhead filter arrays

**Performance**

- ≤ 4μF
- ≤ 600Vdc
- High Frequency
- Temperature -55° to 125°C

**Resilient**

- Discoidal construction

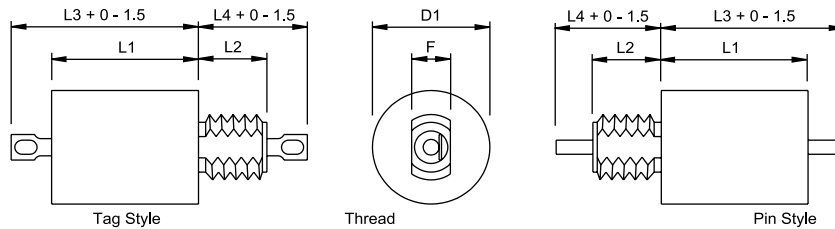
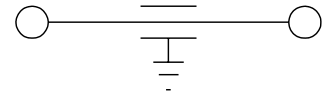

ALL DIMENSIONS ARE MAX AND IN MM UNLESS OTHERWISE STATED

**CASE DIMENSIONS**

/ _	D1	F	L1	L2			L3		L4		Thread		Tag Hole	Pin dia	Max Panel Thickness STD (long)
				STD (long)	Tag	Pin	Tag	STD (long)	Pin	UNF2A	Metric				
/12	6.35	3.21	5.7	4.83	9.7	15.5	8.64	15.0	8-32	-	1.27	1.7	1.5 (3.0)		
/13	6.35	3.21	8.2	4.83	12.0	18.0	8.64	15.0	8-32	-	1.27	1.7	1.5 (3.0)		
/14	6.35	3.21	10.7	4.83	14.5	20.5	8.64	15.0	8-32	-	1.27	1.7	1.5 (3.0)		
/17	6.35	3.21	13.1	4.83	17.0	23.0	8.64	15.0	8-32	-	1.27	1.7	1.5 (3.0)		
/26	9.78	5.08	6.0	4.85 (7.92)	10.1	18.4	8.9 (12.0)	17.2 (20.3)	1/4-28	M6x0.75	1.27x1.78	1.55	1.5 (3.0)		
/27	9.78	5.08	8.0	4.85 (7.92)	12.1	20.4	8.9 (12.0)	17.2 (20.3)	1/4-28	M6x0.75	1.27x1.78	1.55	1.5 (3.0)		
/28	9.78	5.08	10.8	4.85 (7.92)	14.9	23.2	8.9 (12.0)	17.2 (20.3)	1/4-28	M6x0.75	1.27x1.78	1.55	1.5 (3.0)		
/40	17.53	6.58	7.55	8.0	12.6	17.5	14.0	20.0	5/16-24	M8x1.0	1.45x3.0	2.15	3.0		
/41	17.53	6.58	12.35	8.0	17.4	24.3	14.0	20.0	5/16-24	M8x1.0	1.45x3.0	2.15	3.0		
/42	17.53	6.58	17.45	8.0	22.6	29.4	14.0	20.0	5/16-24	M8x1.0	1.45x3.0	2.15	3.0		

**[Ordering Information**

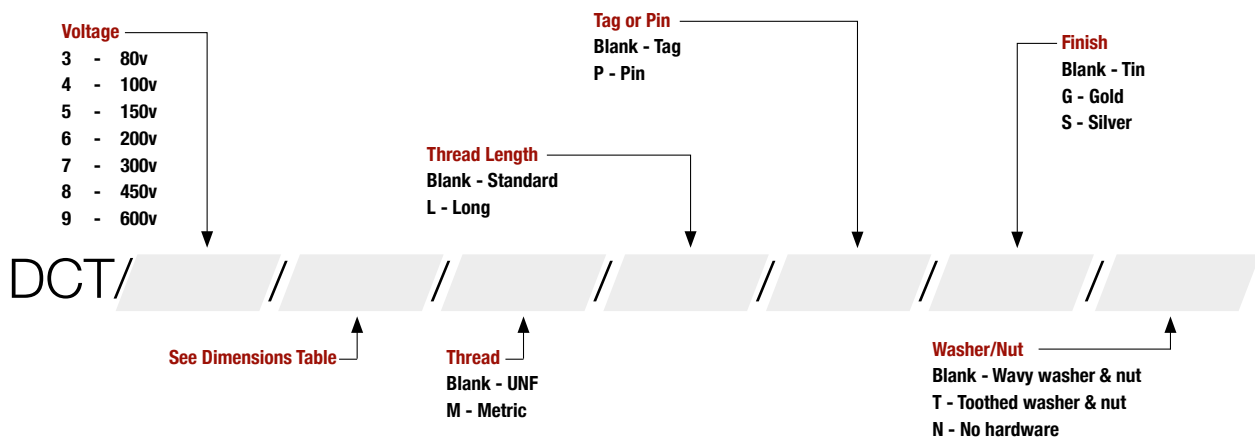

## Electrical Characteristics

Min. Cap ( $\mu$ F)	Rated Current (Amps)	Voltage dc (-55°C to 85°C)	Voltage dc (+125°C)	Voltage AC 400Hz (+125°C)	Min IR (M $\Omega$ )	Min. Insertion Loss (dB) (50 $\Omega$ system)							Part prefix
						30 kHz	100 kHz	150 kHz	300 kHz	1 MHz	10 MHz	1 GHz	
0.15	10	50v	43v		1000	-	-	10	16	26	45	60	DCT112N
0.3	10	50v	43v		100	-	-	16	22	30	50	60	DCT113N
0.45	10	50v	43v		100	-	-	19	25	35	55	60	DCT114N
0.6	10	50v	43v		100	-	-	22	27	38	57	60	DCT117N
1.2	15	80v	70v	50v	100	14	24	28	34	44	54	70	DCT326P
3	15	80v	70v	50v	100	20	28	35	41	51	54	70	DCT340P
4	15	80v	70v	50v	50	23	33	36	42	52	63	70	DCT328P
0.7	15	100v	87v	62v	500	10	20	23	28	38	52	65	DCT426P
1.4	15	100v	87v	62v	250	14	24	28	34	44	58	65	DCT428P
0.039	10	125v	105v		1000	-	-	2	5	13	32	50	DCT4112N
0.079	10	125v	105v		500	-	-	6	10	20	40	60	DCT4113N
0.11	10	125v	105v		300	-	-	8	13	23	40	60	DCT4114N
0.16	10	125v	105v		200	-	-	11	17	27	47	60	DCT4117N
0.3	15	150v	130v	90v	1000	4	13	16	22	32	48	65	DCT527P
0.7	15	150v	130v	90v	500	9	20	23	28	37	55	60	DCT540P
0.9	15	150v	130v	90v	250	12	22	25	31	41	58	65	DCT528P
2.1	15	150v	130v	90v	150	18	29	33	39	50	60	65	DCT541P
0.028	10	175v	150v		1000	-	-	1	3	12	30	50	DCT5112N
0.057	10	175v	150v		500	-	-	3	7	16	33	50	DCT5113N
0.12	10	175v	150v		250	-	-	9	14	24	44	60	DCT5114N
0.11	10	175v	150v		200	-	-	8	13	23	40	60	DCT5117N
0.1	15	200v	175v	125v	1000	-	5	8	13	23	38	60	DCT626P
0.3	15	200v	175v	125v	250	4	12	16	21	31	47	60	DCT628P
0.45	15	200v	175v	125v	500	6	16	19	24	34	51	60	DCT640P
1.2	15	200v	175v	125v	100	14	25	28	34	45	50	65	DCT641P
0.017	10	250v	215v		1000	-	-	-	1	7	24	40	DCT6112N
0.034	10	250v	215v		500	-	-	1	3	12	30	50	DCT6113N
0.051	10	250v	215v		300	-	-	2	6	15	33	55	DCT6114N
0.068	10	250v	215v		200	-	-	5	10	20	40	60	DCT6117N
0.06	15	300v	260v	185v	1000	-	2	4	8	18	33	50	DCT726P
0.1	15	300v	260v	185v	1000	-	3	6	11	21	35	55	DCT726P1
0.12	15	300v	260v	185v	500	-	6	9	14	24	39	50	DCT728P
0.25	15	300v	260v	185v	1000	2	10	13	18	27	45	65	DCT740P
0.75	15	300v	260v	185v	250	9	19	23	28	37	54	65	DCT741P
0.02	15	450v	400v	280v	1000	-	-	-	-	9	26	50	DCT826P
0.04	15	450v	400v	280v	500	-	-	-	6	15	30	50	DCT828P
0.12	15	450v	400v	280v	1000	-	4	7	13	23	40	60	DCT840P
0.21	15	450v	400v	280v	500	-	10	13	19	30	49	60	DCT841P
0.008	15	600v	530v	375v	1000	-	-	-	-	-	14	35	DCT926P1
0.01	15	600v	530v	375v	1000	-	-	-	-	5	19	40	DCT926P
0.02	15	600v	530v	375v	500	-	-	-	2	11	25	40	DCT928P
0.07	15	600v	530v	375v	1200	-	-	-	7	17	36	60	DCT940P
0.21	15	600v	530v	375v	400	-	7	10	16	26	42	60	DCT942P

## Technical Information

BODY & NUT	Tin or Silver
ENVIRONMENTAL CLASSIFICATION	55/125/56 Hermetic



SAI GLOBAL  
AS9100  
Aerospace

\*ROHS versions available upon request - please speak to the sales department