

# D Type (DIAZED)

## FUSE-LINKS & SCREW CAP HOLDERS



### 500 VOLT D TYPE DIAZED FUSE-LINKS, SCREW CAPS AND FUSE BASES

Ferraz Shawmut D fuse-links, also called Diazed type, are 500 Volts AC rated with 75kA interrupting rating. They have 4 physical sizes, DI, DII, DIII, and DIV and fit into special screw caps. All fuse-links have blown-fuse indicators which are visible through the screw cap. Screw caps fit onto single pole bases which are screw or DIN rail mounted. All accessories such as covers, adapter rings, and gauge rings are described.

Ferraz Shawmut is also comprised of Lindner GmbH, a major supplier of D Type Diazed fuses. These fuses are now being sold to markets worldwide through the Ferraz Shawmut distribution network. For Lindner information please contact your local representative.

#### Ratings

- **AC:** 500 Volts AC, 75kA interrupting rating
- **gL-gG** Performance Characteristic

#### Approvals

- Meet IEC, VDE and UNE Standards:  
IEC 269-3, 3A  
VDE 0636  
UNE 21103
- Approved by Lloyd's Register of Shipping and Bureau Veritas

### D FUSES — Catalog Numbers, Ratings

SIZE	RATED In CURRENT (A)	CAP THREAD	CATALOG NUMBER	STANDARD PACK/CTN
DI	2	E 16	28013-G	50
	4		28019-G	
	6		28023-G	
	10		28031-G	
	16		28035-G	
	20		28037-G	
	25		28040-G	
DII	2	E 27	28113-G	5/25
	4		28119-G	
	6		28123-G	
	10		28131-G	
	16		28135-G	
	20		28137-G	
	25		28139-G	
DIII	35	E 33	28145-G	5/25
	50		28151-G	
	63		28155-G	
DIV	80	R 1-1/4"	28159-G	5
	100	R 1-1/4"	28163-G	5

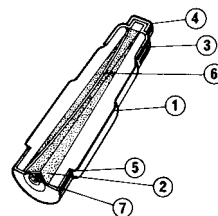

- 1 Ceramic body
- 2 Sand
- 3 Upper contact
- 4 Contact top
- 5 Lower contact
- 6 Melting element
- 7 Indicator



28139-G



28159-G



28031-G



28113-G

# D Type (DIAZED)

## FUSE-LINKS & SCREW CAP HOLDERS

### Dimensions

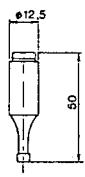

D I

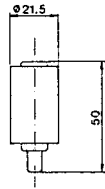

D II (2-6A)

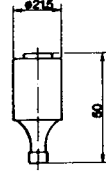

D II (10-25A)

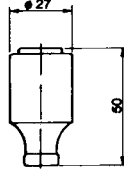

D III

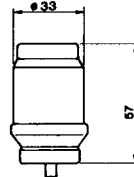

D IV

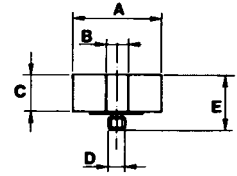

Gauge Ring

### Gauge Ring Dimensions

	SII	SIII	SIV
A	23.5	29	14
B	7	7	-
C	12.5	12.5	13.5
D	5	5	-
E	17	17	-

### Gauge Rings

SIZE	RATED In CURRENT (A)	CAP THREAD	CATALOG NUMBER	STANDARD PACK
SII	2	E 27	27913-G	50
	4		27919-G	
	6		27923-G	
	10		27931-G	
	16		27935-G	
	20		27937-G	
SIII	25	27939-G	50	
	35	27945-G		
	50	27951-G		
SIV	63	27955-G	50	
	80	R 1-1/4"		27959-G



27959-G



27935-G



### Screw Caps

SIZE	RATED In CURRENT (A)	CAP THREAD	CATALOG NUMBER	STANDARD PACK
KII	25	E 27	28039-G	50
KIII	63	E 33	28055-G	50
KIV	100	R 1-1/4"	28063-G	24



28063-G

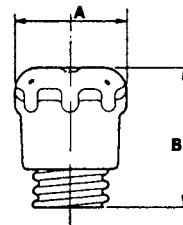

### Dimensions

	KII	KIII	KIV
A	38	48	63
B	43.5	44	53

### Adapter Rings

DIII - DII			28100-G	24
------------	--	--	---------	----



28100-G

# D Type (DIAZED)

## FUSE-LINKS & SCREW CAP HOLDERS



28202-G



28312-G

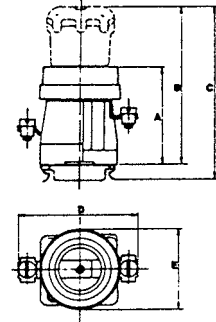

### Single Pole Fuse Bases

MOUNTING METHOD	SIZE	RATED In CURRENT (A)	CAP THREAD	CATALOG NUMBER	STANDARD PACK
SCREW	EZII	25	E 27	28202-G	36
	EZIII	63	E 33	28204-G	36
	EZIV	100	R 1-1/4"	28206-G	6

DIN RAIL	EZPII	25	E 27	28312-G	24
	EZPIII	63	E 33	28314-G	24

### Dimensions

	EZ II	EZ III	EZ IV	EZP II	EZP III
A	54	54	75	55	55
B	80	83	105	82	84
C	36	46	58	90	94
D	20	21	46	65	67
E	47	56	77	46	55
F	4.5	4.5	8	-	-
G	65	6	128	-	-

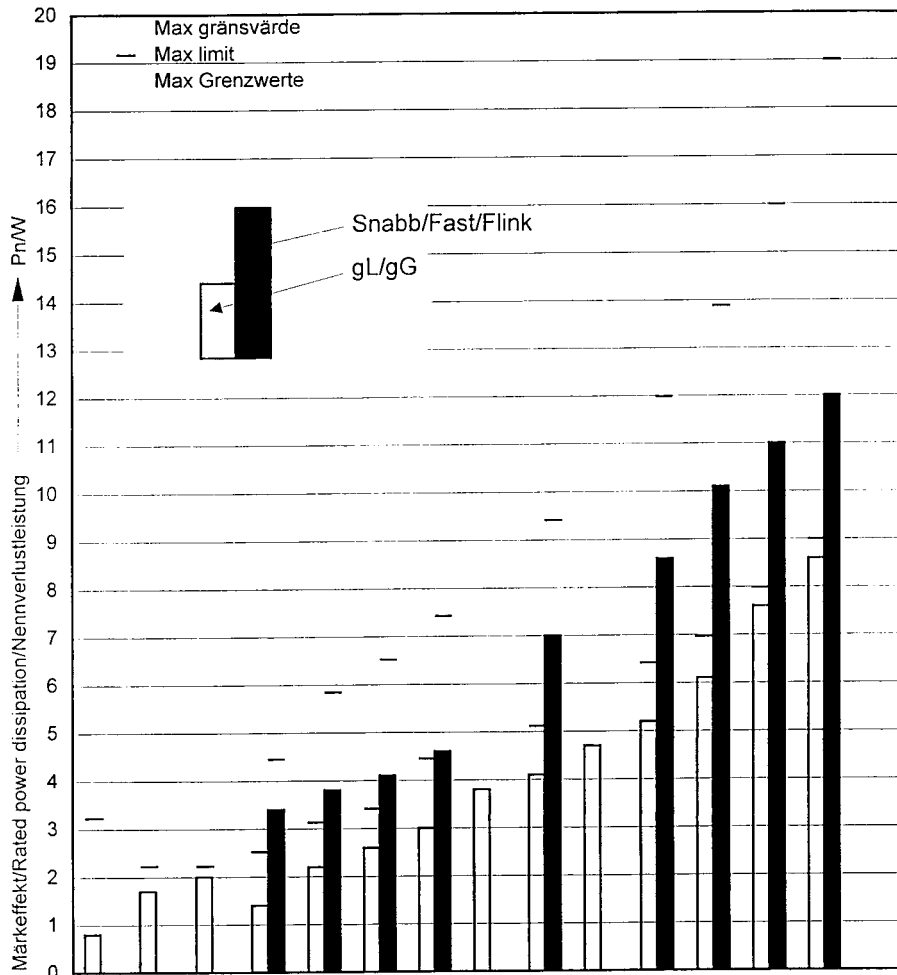

# D Type (DIAZED)

## FUSE-LINKS & SCREW CAP HOLDERS

**Melting Time - Current Data — 2-100 Amperes**

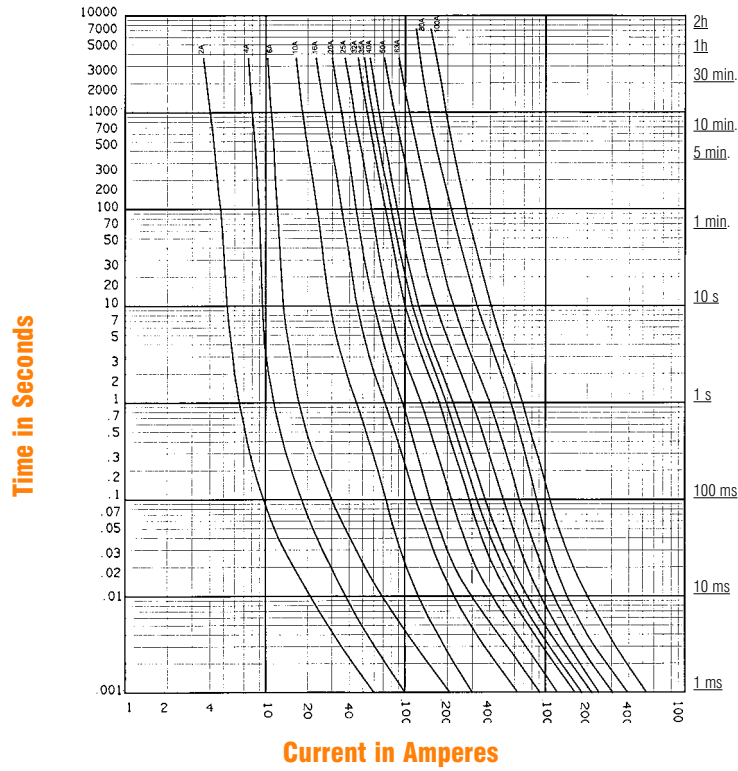

**Peak Let-Through Current Data — 16-100 Amperes**

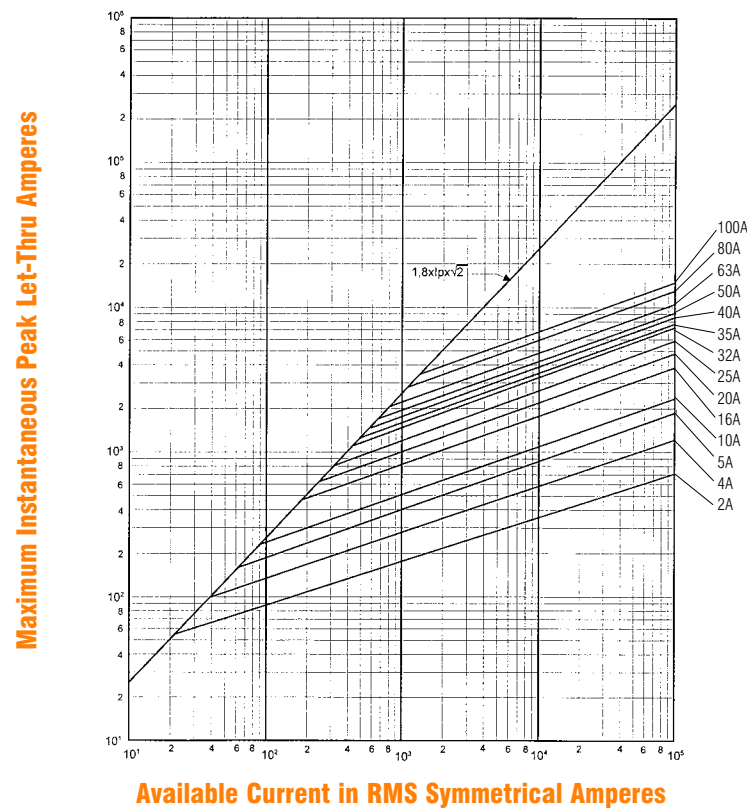

# D Type (DIAZED)

## FUSE-LINKS & SCREW CAP HOLDERS

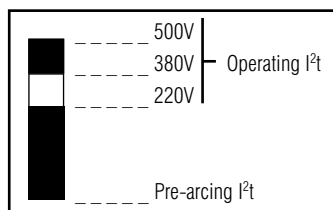
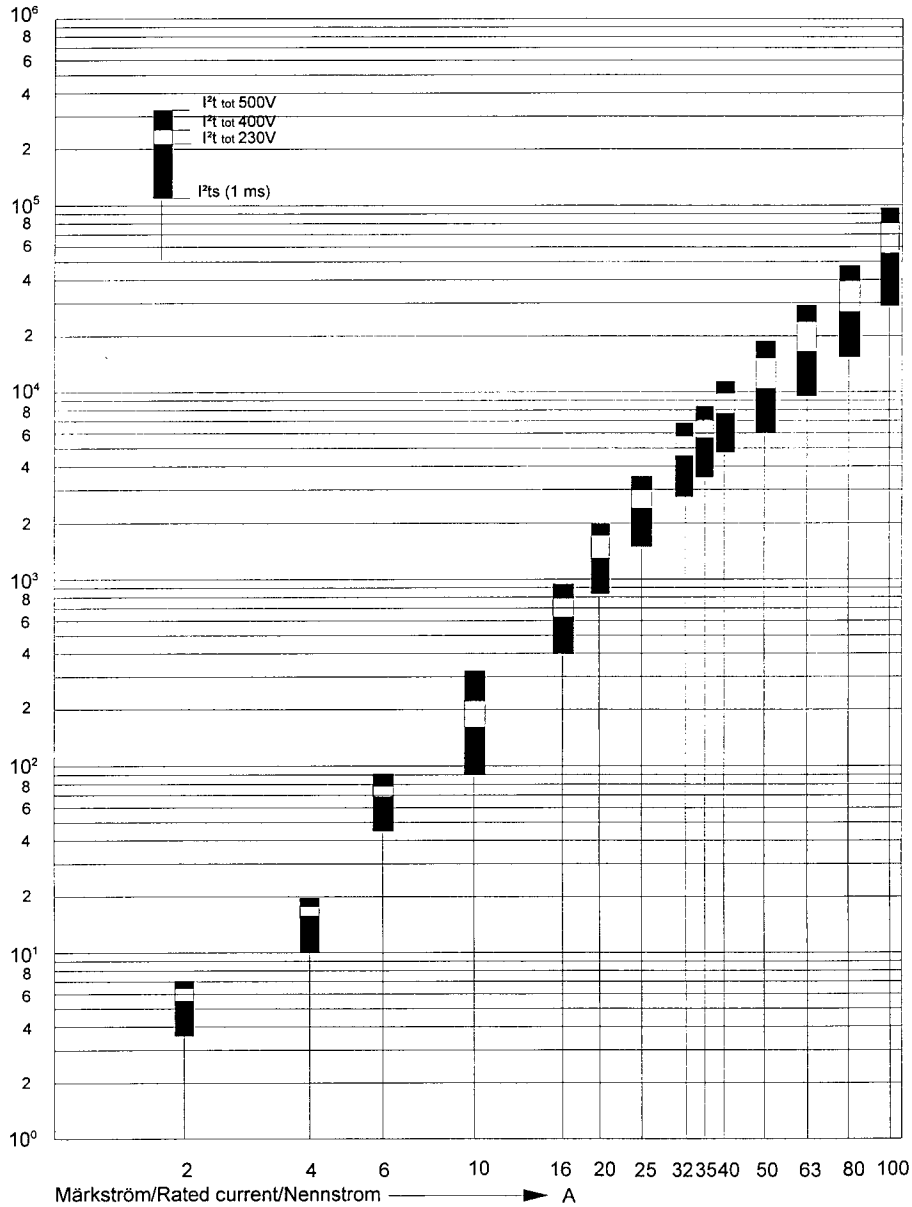

# gl-gL-gG, aM

## NH DIMENSION KNIFE-BLADE FUSE-LINKS



### NH DIMENSION KNIFE-BLADE FUSE-LINKS, FUSE BASES, AND ACCESSORIES

Ferraz Shawmut NH Fuse-links, sizes 00, 0, 1, 2, 3 and 4 are rated 500 or 690 Volts AC with breaking capacities of 80kA or 120kA. All fuse-links include an indicator or striker and can accept a microswitch for remote signaling. They all have silver-plated knife blades and ceramic bodies. Accessories include 1, 2, 3 or 4-pole bases, barriers, shields, terminals, microswitch, etc.

Ferraz Shawmut Circuit Protection Group is also comprised of Lindner GmbH, a major supplier of NH fuses. These fuses are now being sold to markets worldwide through the Ferraz Shawmut distribution network. For Lindner information please contact your local representative.

#### Standards

- DIN 57636
- NFC 63210-63211
- CEI 269-1-2-2A
- UNE 21103
- VDE 0636-2-1, 2-2
- DIN 43620

#### Approvals

- Lloyd's Register of Shipping
- Bureau Veritas



## gl-gL-gG

### FULL RANGE PROTECTION

- Sizes 00, 0, 1, 2, 3, 4
- 500 and 690 Volt ratings - 4A through 1250A
- All ratings include indicator
- All equipped for microswitch mounting

## gl-gL-gG

### FULL RANGE PROTECTION

#### Fuse-link with Striker

- Sizes 0, 1, 2, 3
- 500 and 690 Volt ratings - 32A through 630A
- All ratings include striker

## aM

### SHORT CIRCUIT PROTECTION

- Sizes 00, 0, 1, 2, 3
- 500 and 690 Volt ratings - 10A through 630A
- All ratings include indicator
- All equipped for microswitch mounting

## aM

### SHORT CIRCUIT PROTECTION

#### Fuse-link with Striker

- Sizes 0, 1, 2, 3
- 500 and 690 Volt ratings - 32A through 630A
- All ratings include striker
- Certification
  - DIN 57636
  - VDE 60269
  - NFC 63210, 63211
  - IEC 269-1, 2, 2A
  - UNE 21103
- Approved by Lloyds Register of Shipping and Bureau Veritas

- 1 Ceramic body
- 2 Quartz sand
- 3 Knife contact
- 4 Indicator
- 5 Melting element
- 6 End plate
- 7 Insulating joint

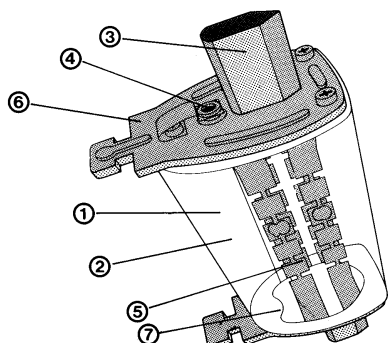

# gI-gL-gG

## NH DIMENSION KNIFE-BLADE FUSE-LINKS

### Catalog Numbers, Ratings – gI-gL-gG



30063-G



30169-G



30259-G



30469-G



30571-G



30679-G

SIZE	RATED In CURRENT (A)	RATED VOLTAGE	CATALOG NUMBER	INTERRUPTING RATING (A)	STANDARD PACK					
00	C-00	690V	30019-G	80,000	3					
			30023-G							
			30027-G							
			30031-G							
			30033-G							
			30035-G							
			30037-G							
			30039-G							
			30043-G							
			30045-G							
			30047-G							
			30051-G							
			30055-G							
			30059-G							
30063-G										
00	C-00	500V	30165-G	120,000	3					
			30169-G							
0	C-0	690V	30223-G	80,000	3					
			30231-G							
			30235-G							
			30237-G							
			30239-G							
			30243-G							
			30245-G							
			30247-G							
			30251-G							
			30255-G							
			30259-G							
			30263-G							
			0			C-0	500V	30365-G	120,000	3
								30369-G		
0S	C-0	690V	30465-G	80,000	3					
			30469-G							
		500V	30471-G			120,000				
			30473-G							
30475-G										
1	C-1	690V	30535-G	80,000	3					
			30537-G							
			30539-G							
			30543-G							
			30545-G							
			30547-G							
			30551-G							
			30555-G							
			30559-G							
			30563-G							
			30565-G							
			30569-G							
			30571-G							
			1			C-1	500V	30573-G	120,000	3
30575-G										
30579-G										
30581-G										
30581-G										

Table continued on next page.

# gI-gL-gG

## NH DIMENSION KNIFE-BLADE FUSE-LINKS

### Catalog Numbers, Ratings – gI-gL-gG (cont.)



30679-G

30787-G

### Indicator

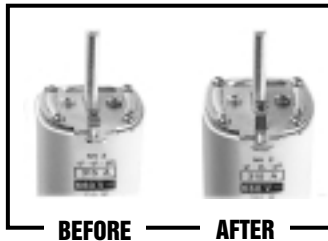

BEFORE AFTER

SIZE	RATED In CURRENT (A)	RATED VOLTAGE	CATALOG NUMBER	INTERRUPTING RATING (A)	STANDARD PACK				
2	32	690V	30643-G	80,000	3				
	35		30645-G						
	40		30647-G						
	50		30651-G						
	63		30655-G						
	80		30659-G						
	100		30663-G						
	125		30665-G						
	160		30669-G						
	200		30671-G						
	224		30673-G						
	250		30675-G						
	315		30679-G						
	3		355			500V	30681-G	120,000	3
400		30683-G							
425		30685-G							
500		30687-G							
3		315	690V	30779-G	80,000		3		
		355		30781-G					
	400	30783-G							
	425	30785-G							
	500	30787-G							
	4	630		500V		30789-G		120,000	3
800		30791-G							
4	800	500V	30891-G	120,000	1				
	1000		30893-G						
	1250		30895-G						

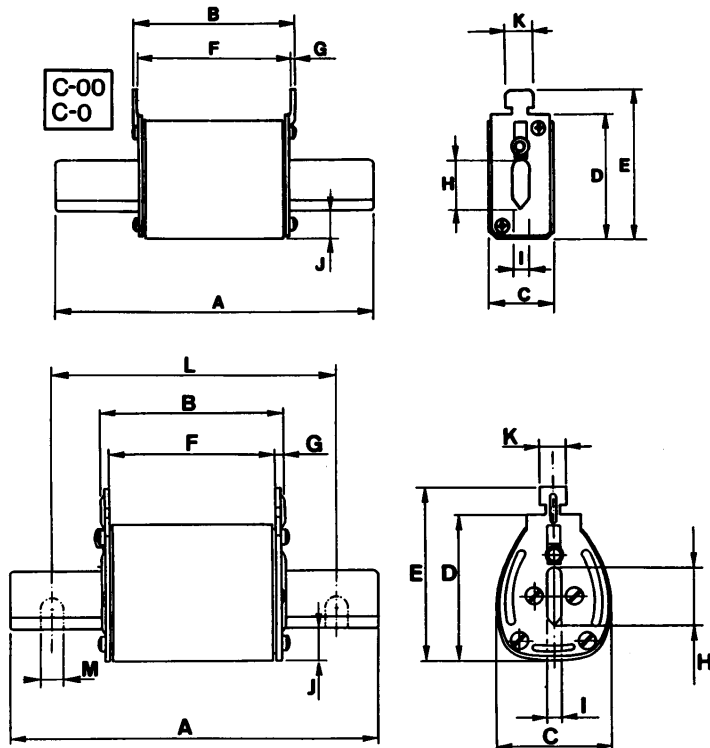

### Dimensions

	00		0			1	2	3	4
	C-00	00	C-0	0	O-S				
A	78	78	125	124.5	124.5	134	150	150	200
B	48	50	66.7	67	66	67	67	67	67
C	21	28	21	28	39	40	56	69	90
D	42	44	42	44	49	55	62.5	76	107
E	52	54	52	54	59	65	72.5	86	117
F	45	44	63.5	61	61	61	61	61	62
G	1.5	3	1.6	3	3	3	3	3	3
H	15	15	15	15	15	20	26	32	65
I	6	6	6	6	6	6	6	6	8
J	7	8.5	7	8.5	14	14	15	16	21
K	10	10	10	10	10	10	10	10	10
L	-	-	-	-	-	-	-	-	150
M	-	-	-	-	-	-	-	-	14



# gl-gL-gG

## NH DIMENSION KNIFE-BLADE FUSE-LINKS

### Catalog Numbers, Ratings – gl-gL-gG with Striker



SIZE	RATED In CURRENT (A)	RATED VOLTAGE	CATALOG NUMBER	INTERRUPTING RATING (A)	STANDARD PACK
0	OS	690V	36443-G	80,000	3
			36445-G		
			36447-G		
			36451-G		
			36455-G		
			36459-G		
125	500V	36463-G	120,000		
		36465-G			
		36469-G			
36471-G					
1	690V	36559-G	80,000	3	
		36563-G			
		36565-G			
		36569-G			
		36571-G			
	500V	36573-G	120,000		
		36575-G			
		36579-G			
		36581-G			
		36581-G			
2	690V	36665-G	80,000	3	
		36669-G			
		36671-G			
		36673-G			
		36675-G			
	500V	36679-G	120,000		
		36681-G			
		36683-G			
		36687-G			
		36687-G			
3	690V	36779-G	80,000	3	
		36781-G			
		36783-G			
		36787-G			
	630	500V	36789-G		120,000

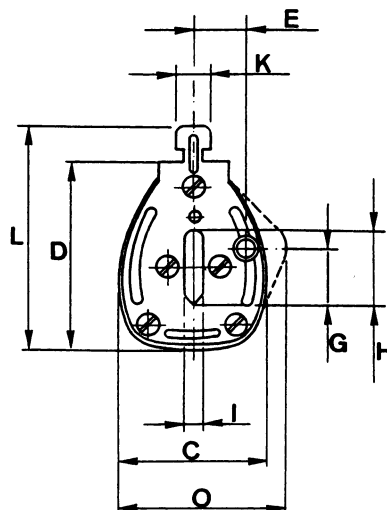
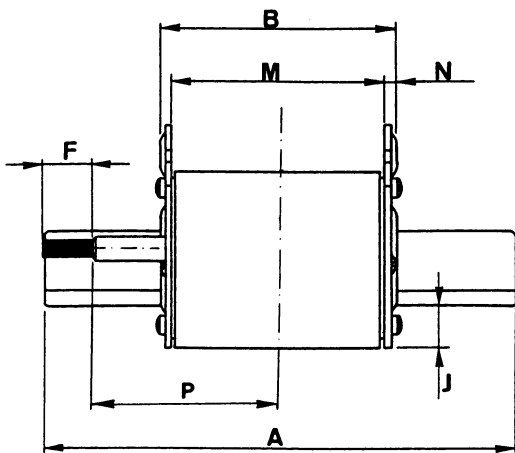

### Dimensions

	0	1	2	3
A	124.5	134.5	150	150
B	66	67	67	67
C	39	40	56	69
D	49	55	62.5	76
E	14.5	16	19	24
F	15.5	15.5	15.5	15.5
G	14	14.5	14.5	14.5
H	15	20	26	32
I	6	6	6	6
J	14	14	15	16
K	10	10	10	10
L	59	65	72.5	86
M	60	61	61	61
N	3	3	3	3
O	41.5	45	-	-
P	47	52	60	60

# gI-gL-gG

## NH DIMENSION KNIFE-BLADE FUSE-LINKS

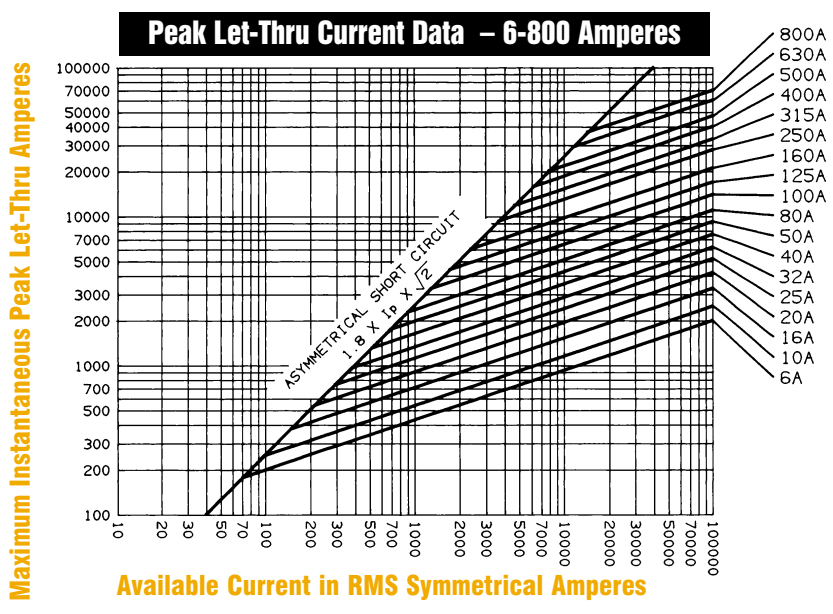
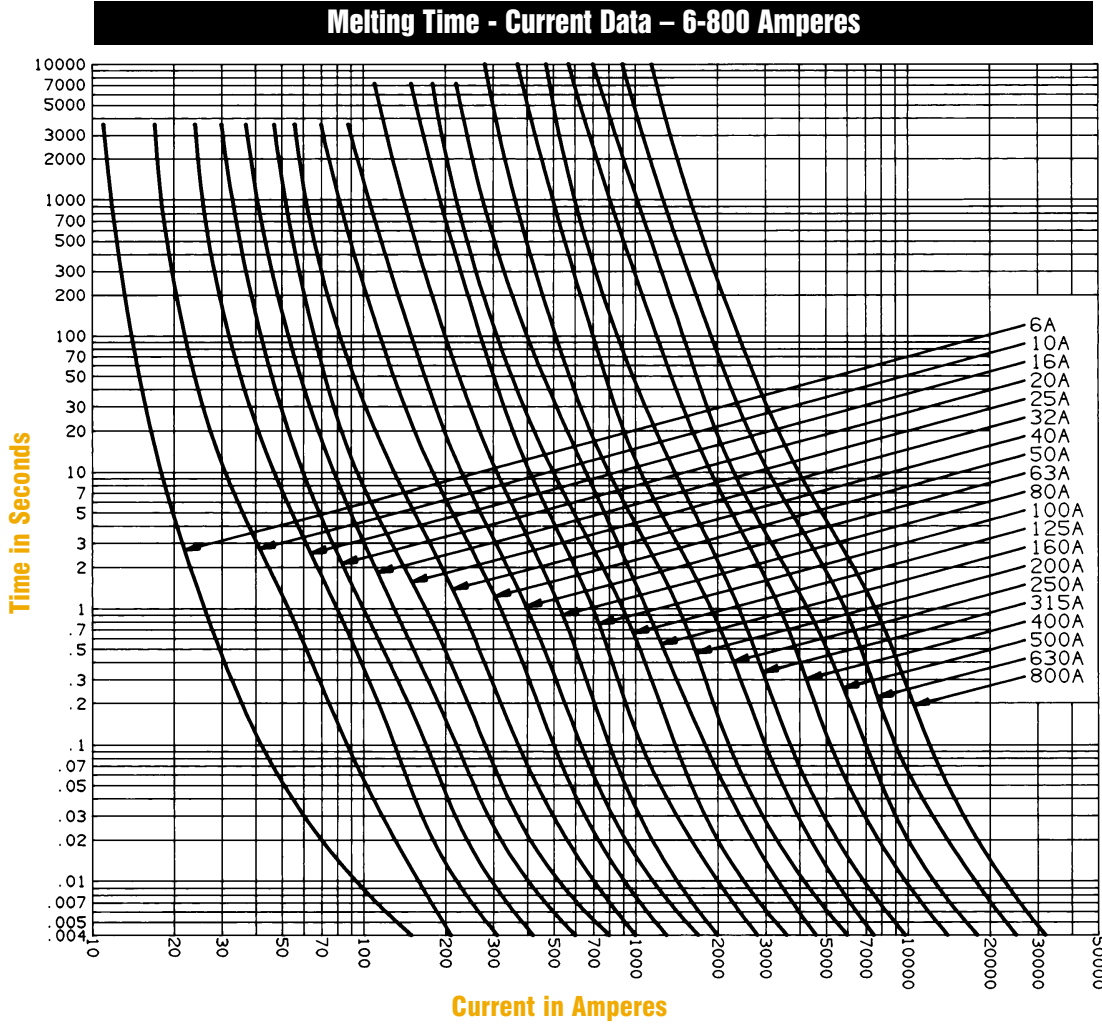

**Striker**



# gI-gL-gG

## NH DIMENSION KNIFE-BLADE FUSE-LINKS

### Power Loss (Watts) at Rated Current

RATED In CURRENT (A)	SIZE						
	00	0	0S	1	2	3	4
6	1.3 W	1.7 W					
10	1.5 W	1.8 W					
16	1.9 W	2.2 W		2.2 W			
20	2.2 W	2.6 W		2.5 W			
25	2.6 W	3.1 W		3.0 W			
32	3.1 W	3.7 W		3.6 W	3.5 W		
35	3.3 W	4.0 W		3.9 W	3.8 W		
40	3.7 W	4.5 W		4.4 W	4.3 W		
50	4.4 W	5.2 W		4.9 W	4.8 W		
63	5.1 W	6.2 W		5.8 W	5.8 W		
80	6.1 W	7.5 W		6.9 W	6.8 W		
100	6.9 W	8.5 W		8.1 W	7.9 W		
125	9.1 W	10.7 W	10.7 W	9.6 W	9.5 W		
160	11.8 W	13.5 W	13.5 W	11.9 W	11.5 W		
200		15.0 W	15.0 W	14.9 W	14.5 W		
224		16.2 W	16.2 W	16.7 W	16.0 W		
250		17.8 W	17.8 W	18.7 W	17.5 W		
315				25.0 W	23.8 W	23 W	
355				28.0 W	26.0 W	25 W	
400					30.0 W	30 W	
425					34.0 W	34 W	
500					40.0 W	40 W	
630						48 W	
800						57 W	67 W
1000							78 W
1250							104 W

RATED In CURRENT (A)	00	0	1	2	3	4
	100A	160A	250A	400A	630A	1000A
VDE 0660 (500V) IEC 269-2-1 (690V) UNE 21103 (500V) NFC 63210 (500V)	12.0 W	25 W	32 W	45 W	60 W	90 W
VDE 0636 (690V)	10.0 W	-	23 W	34 W	48 W	70 W
VDE 0636 (500V)	7.5 W	16 W	23 W	34 W	48 W	110 W
IEC 269 (500V)	7.5 W	16 W	23 W	34 W	48 W	90 W
UNESA (500V)	-	17 W	26 W	32 W	48 W	-
WDE W (500V)	7.5 W	16 W	21 W	32 W	42 W	-

Typical values allowed by the standards.

# gI-gL-gG

## NH DIMENSION KNIFE-BLADE FUSE-LINKS

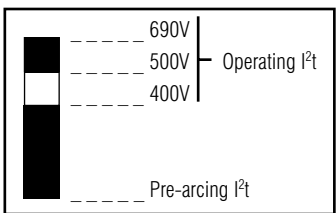
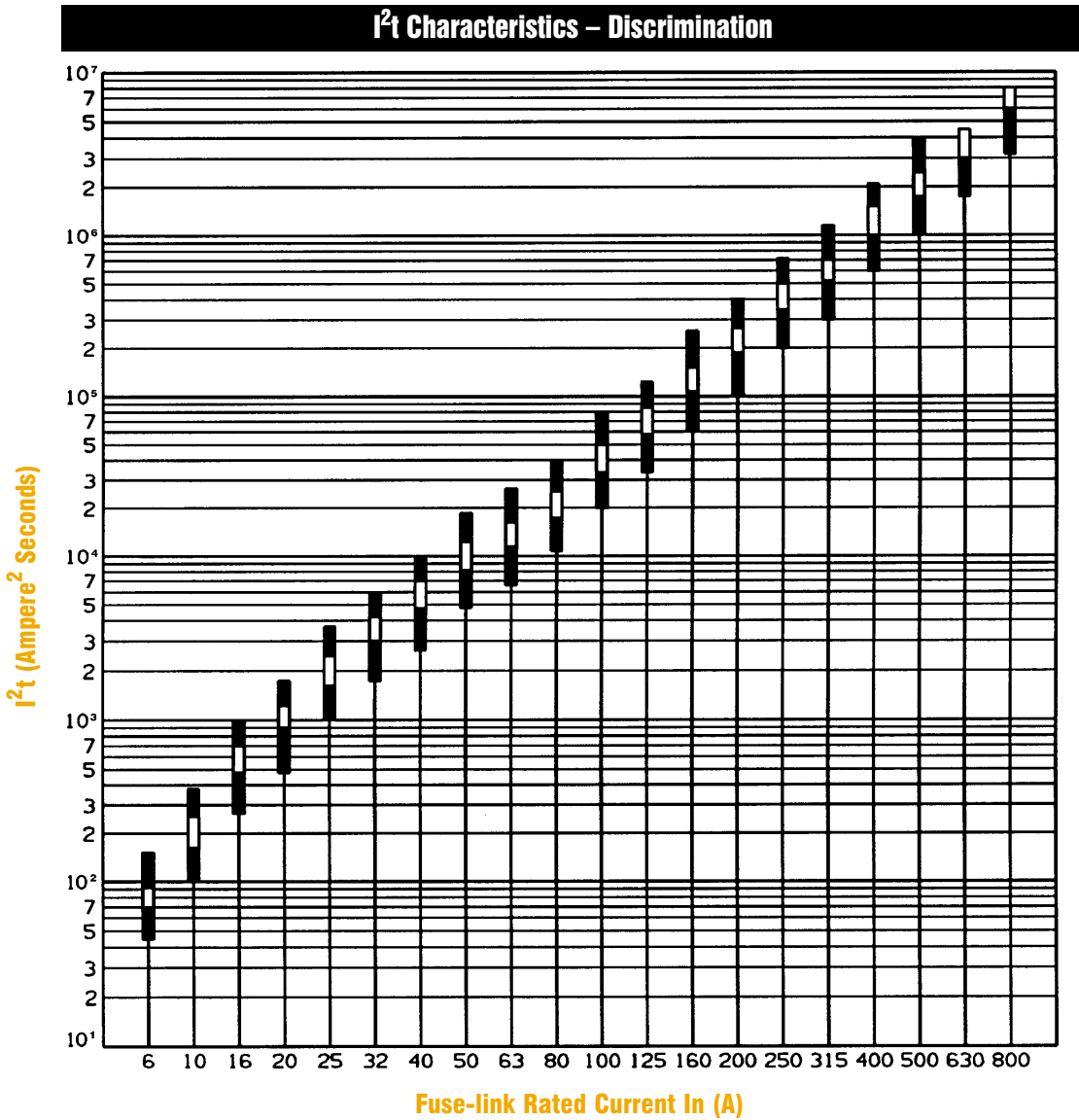

# aM

## NH DIMENSION KNIFE-BLADE FUSE-LINKS



### Catalog Numbers, Ratings – aM

SIZE	RATED In CURRENT (A)	RATED VOLTAGE	CATALOG NUMBER	INTERRUPTING RATING (A)	STANDARD PACK		
00	10	690V	32133-G	80,000	3		
	16		32135-G				
	20		32137-G				
	25		32139-G				
	32		32143-G				
	35		32145-G				
	40		32147-G				
	50		32151-G				
	63		32155-G				
	80		32159-G				
	100		32163-G				
	125		32165-G				
0	160	500V	32169-G	120 000	3		
	0	32	690V	32343-G		80,000	
		35		32345-G			
		40		32347-G			
		50		32351-G			
		63		32355-G			
		80		32359-G			
		100		32363-G			
		125		32365-G			
	OS	500V	32469-G	80,000			
	1	50	690V			32551-G	80,000
		63				32555-G	
80		32559-G					
100		32563-G					
125		32565-G					
160		32569-G					
200		32571-G					
250		32575-G					
315	500V	32579-G	80,000				
2	63	690V		32655-G	80,000		
	80			32659-G			
	100			32663-G			
	125			32665-G			
	160			32669-G			
	200			32671-G			
	250			32675-G			
	315		32679-G				
	355		32681-G				
	400		32683-G				
500	500V	32687-G	80,000				
3	315	690V		32779-G	80,000		
	355			32781-G			
	400			32783-G			
	500			32787-G			
	630		500V	32789-G		120,000	

### Microswitch – Sizes 00, 1, 2, 3 Only

00-1-2-3			45492-G		1
----------	--	--	---------	--	---

### Microswitch Mounted

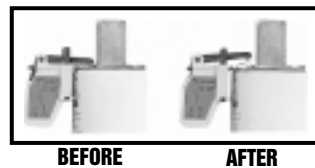

### Blown-Fuse Indicator

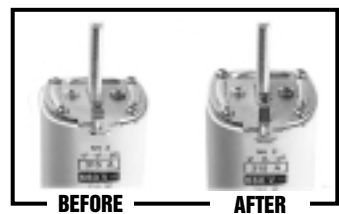

# aM

## NH DIMENSION KNIFE-BLADE FUSE-LINKS



37465-G



37675-G



37569-G



37787-G

**Striker**



BEFORE

AFTER

**Catalog Numbers, Ratings – aM with Striker**

SIZE	RATED In CURRENT (A)	RATED VOLTAGE	CATALOG NUMBER	INTERRUPTING RATING (A)	STANDARD PACK				
0S	32	690V	37443-G	80,000	5				
	40		37447-G						
	50		37451-G						
	63		37455-G						
	80		37459-G						
	100		37463-G						
	125		37465-G						
0	160	500V	37469-G	80,000	5				
	200		37471-G						
	1		80			690V	37559-G	80,000	5
			100				37563-G		
			125				37565-G		
			160				37569-G		
			200				37571-G		
224		37573-G							
2	250	500V	37575-G	80,000	5				
	125		690V			37665-G			
	160					37669-G			
	200					37671-G			
	224					37673-G			
	250					37675-G			
	315					37679-G			
355	37681-G								
3	400	500V	37683-G	80,000	3				
	500		37687-G						
	315		690V			37779-G			
	355					37781-G			
	400					37783-G			
	500					37787-G			
	630		500V			37789-G	120,000		

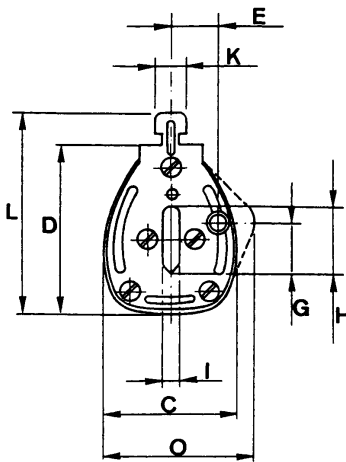
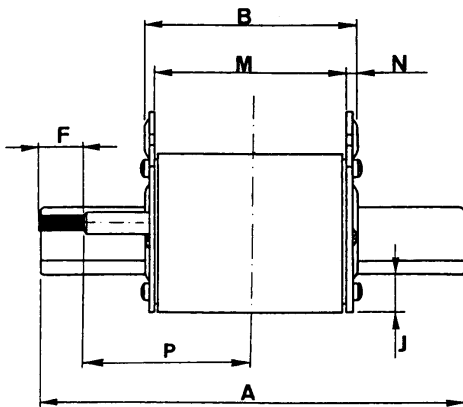

**Dimensions**

	0	1	2	3
A	124.5	134.5	150	150
B	66	67	67	67
C	39	40	56	69
D	49	55	62.5	76
E	14.5	16	19	24
F	15.5	15.5	15.5	15.5
G	14	14.5	14.5	14.5
H	15	20	26	32
I	6	6	6	6
J	14	14	15	16
K	10	10	10	10
L	59	65	72.5	86
M	60	61	61	61
N	3	3	3	3
O	41.5	45	-	-
P	47	52	60	60

**Melting Time - Current Data – 32-630 Amperes**

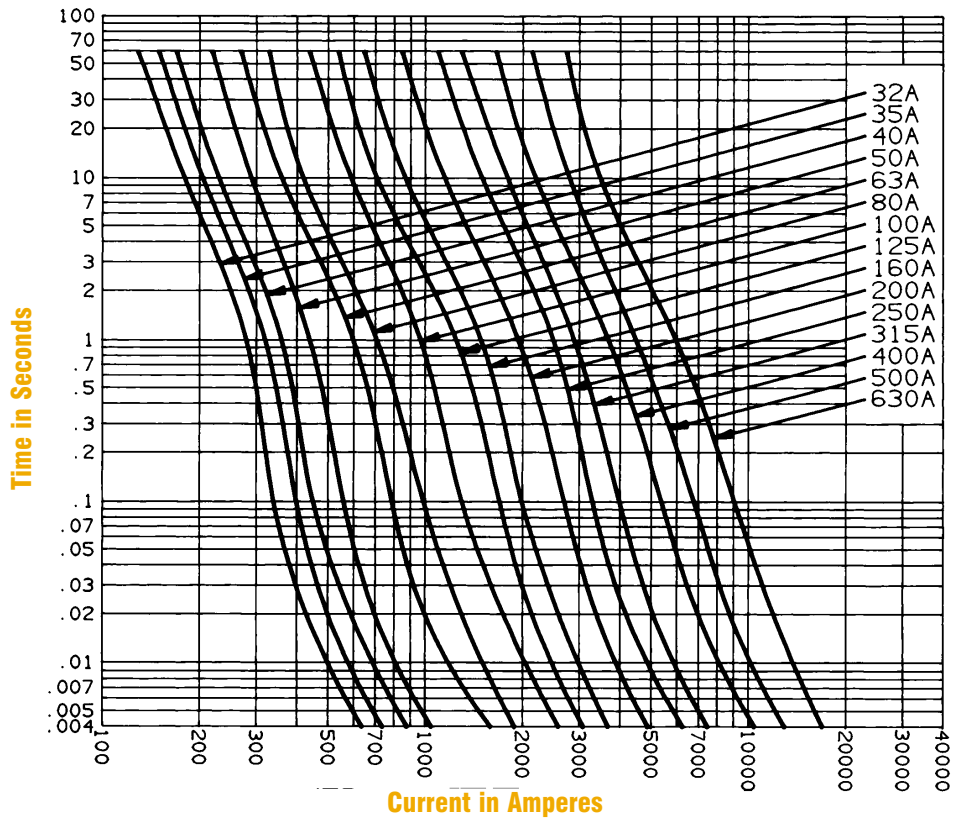

**Peak Let-Thru Current Data – 32-630 Amperes**

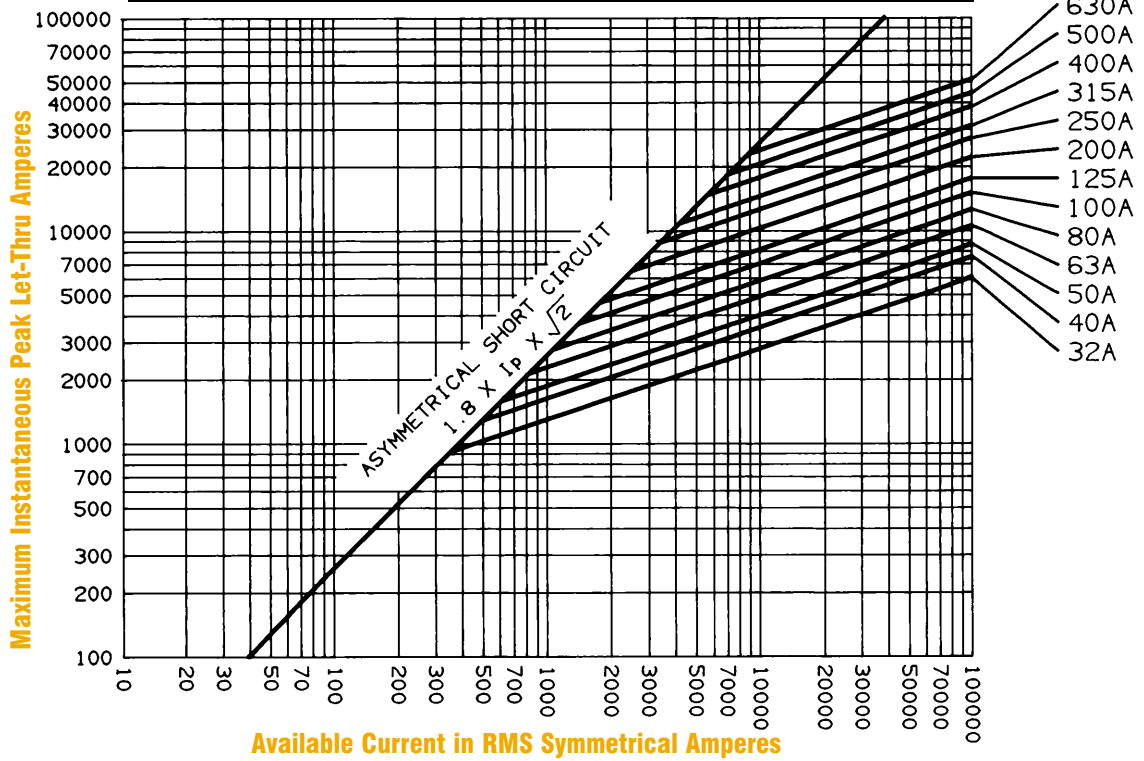

# aM

## NH DIMENSION KNIFE-BLADE FUSE-LINKS

### Power Loss (Watts) at Rated Current

RATED CURRENT In (A)	SIZE				
	00	0/0S	1	2	3
16	1.1 W				
20	1.4 W				
25	1.7 W				
32	2.2 W	2.2 W			
35	2.4 W	2.4 W			
40	2.8 W	2.8 W			
50	3.6 W	3.6 W	3.6 W		
63	4.6 W	4.6 W	4.6 W	4.6 W	
80	6.0 W	6.0 W	6.0 W	6.0 W	
100	7.5 W	7.5 W	7.5 W	7.5 W	
125	9.5 W	9.5 W	9.5 W	9.6 W	
160	10.7 W	12.0 W	12.7 W	12.7 W	
200		18.0 W	16.4 W	16.4 W	
224			21.5 W	18.7 W	
250			29.0 W	21.5 W	
315				29.0 W	25.0 W
355				32.0 W	29.0 W
400				34.0 W	34.0 W
425					38.5 W
500				45.0 W	45.0 W
630					60.0 W

### I<sup>2</sup>t Characteristics – Discrimination

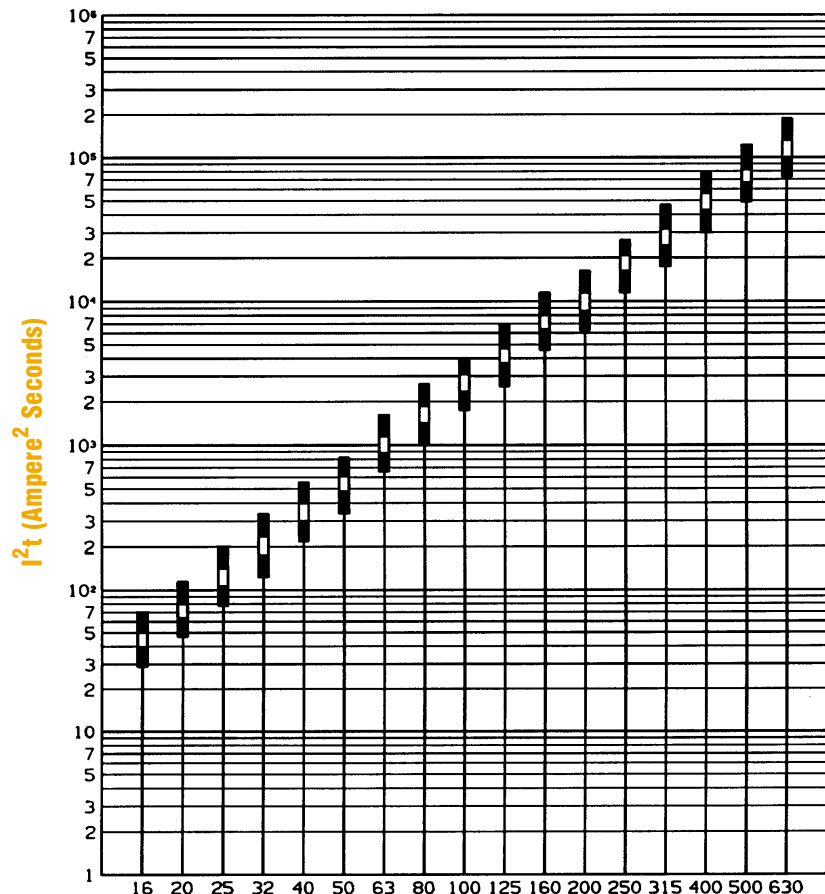
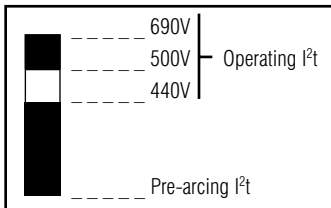

Fuse-link Rated Current In (A)



# gF, gI-gG, aM

## CYLINDRICAL FUSE-LINKS



### DOMESTIC AND INDUSTRIAL CYLINDRICAL FUSE-LINKS

Ferraz Shawmut gF, gI-gG and aM fuse-links cover a wide range of physical sizes and ampere ratings for 250, 400, 500, and 690 volts AC. gF fuse-links are for domestic use. gI-gG and aM fuse-links are for industrial applications. Most ratings are available with an optional indicator. All industrial fuse-links have the option of a built-in striker. All cylindrical fuse-links have ceramic bodies and silver-plated ferrules.

### gF

#### FULL RANGE PROTECTION

- 7 physical sizes from 6.3 x 23mm to 10.3 x 38 mm
- 250 and 400 Volt ratings - 0.5A through 32A
- Most ratings available with indicator
- Meet IEC, NFC, UNE and British standards

### gI-gG

#### FULL RANGE PROTECTION

- 4 physical sizes from 8 x 31mm to 22 x 58 mm
- 400, 500 and 690 Volt ratings - 0.5A through 125A
- Most ratings available with indicator
- Meet IEC, NFC and UNE standards
- Approved by Lloyds Register of Shipping and Bureau Veritas

### gI-gG

#### FULL RANGE PROTECTION

- Fuse-links with Striker**
- 2 sizes- 14 x 51mm and 22 x 58mm
  - 400, 500 and 690 Volt ratings - 4A through 125A
  - All ratings include striker
  - Meet IEC, NFC and UNE standards
  - Approved by Lloyds Register of Shipping and Bureau Veritas

### aM

#### SHORT CIRCUIT PROTECTION

- 4 physical sizes from 8 x 31mm to 22 x 58mm
- 400, 500 and 690 Volt ratings - .16A through 125A
- Most ratings available with indicator
- Meet IEC, NFC and UNE standards
- Approved by Lloyds Register of Shipping and Bureau Veritas

### aM

#### SHORT CIRCUIT PROTECTION

- Fuse-links with Striker**
- 2 sizes - 14 x 51mm and 22 x 58mm
  - 400, 500 and 690 Volt ratings - 2A through 125A
  - All ratings include striker
  - Meet IEC, NFC and UNE standards
  - Approved by Lloyds Register of Shipping and Bureau Veritas

Catalog Numbers, Ratings — gF (Optional Blown-Fuse Indicator)

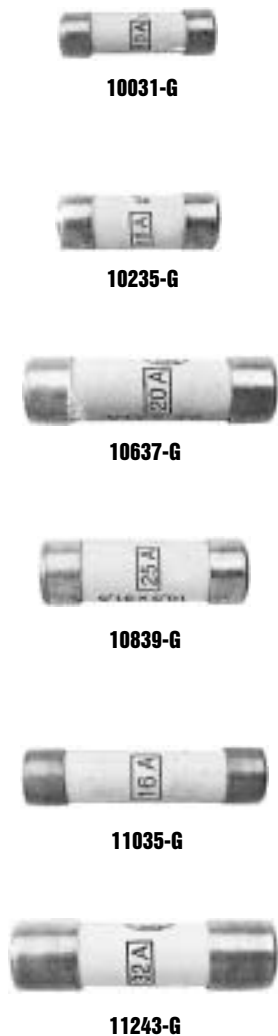

SIZE (mm x mm)	RATED In CURRENT (A)	RATED VOLTAGE	CATALOG NUMBER		INTERRUPTING RATING (A)	STANDARD PACK/CTN.
			w/o Indicator	w/Indicator		
6.3 x 23	2	250V	10013-G	-	6,000	10/100
	4		10019-G	-		
	6		10023-G	-		
	10		10031-G	-		
8.5 X 23	2	250V	10213-G	12213-G	6,000	10/100
	4		10219-G	12219-G		
	6		10223-G	12223-G		
	10		10231-G	12231-G		
	16		10235-G	12235-G		
10.3 X 25.8	6	250V	10423-G	12423-G	6,000	10/100
	10		10431-G	12431-G		
	16		10435-G	12435-G		
8.5 x 31.5	0.5	400V	10609-G	12609-G	20,000	10/100
	1		10611-G	12611-G		
	2		10613-G	12613-G		
	4		10619-G	12619-G		
	6		10623-G	12623-G		
	8		10627-G	12627-G		
	10		10631-G	12631-G		
	12		10633-G	12633-G		
	16		10635-G	12635-G		
	20		10637-G	12637-G		
25	10639-G	12639-G				
10.3 x 31.5	16	400V	10835-G	12835-G	20,000	10/100
	20		10837-G	12837-G		
	25		10839-G	12839-G		
8.5 x 36	2	400V	11013-G	13013-G	20,000	10/100
	4		11019-G	13019-G		
	6		11023-G	13023-G		
	10		11031-G	13031-G		
	16		11035-G	13035-G		
	20		11037-G	13037-G		
	25		11039-G	13039-G		
	32		11043-G	13043-G		
	10.3 x 38		25	400V		
32		11243-G	13243-G			



- 1 Ceramic body
- 2 Sand
- 3 Indicator contact
- 4 Lower contact
- 5 Contact ring
- 6 Melting element
- 7 Indicator

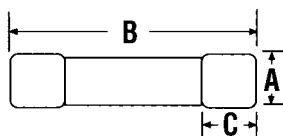
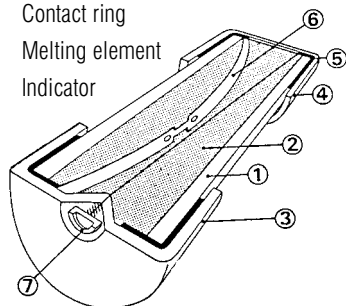

Dimensions

FUSE SIZE (mm x mm)	A	B	C
6.3 X 23	6.3	23	5
8.5 X 23	8.5	23	5
10.3 x 25.8	10.3	25.8	6.3
8.5 x 31.5	8.5	31.5	6.3
10.3 x 31.5	10.3	31.5	10
8.5 x 36	8.5	36	6.3
10.3 x 38	10.3	38	10

Blown-Fuse Indicator



# gF

## CYLINDRICAL FUSE-LINKS

**Melting Time - Current Data — 2-16 Amperes, 250V**

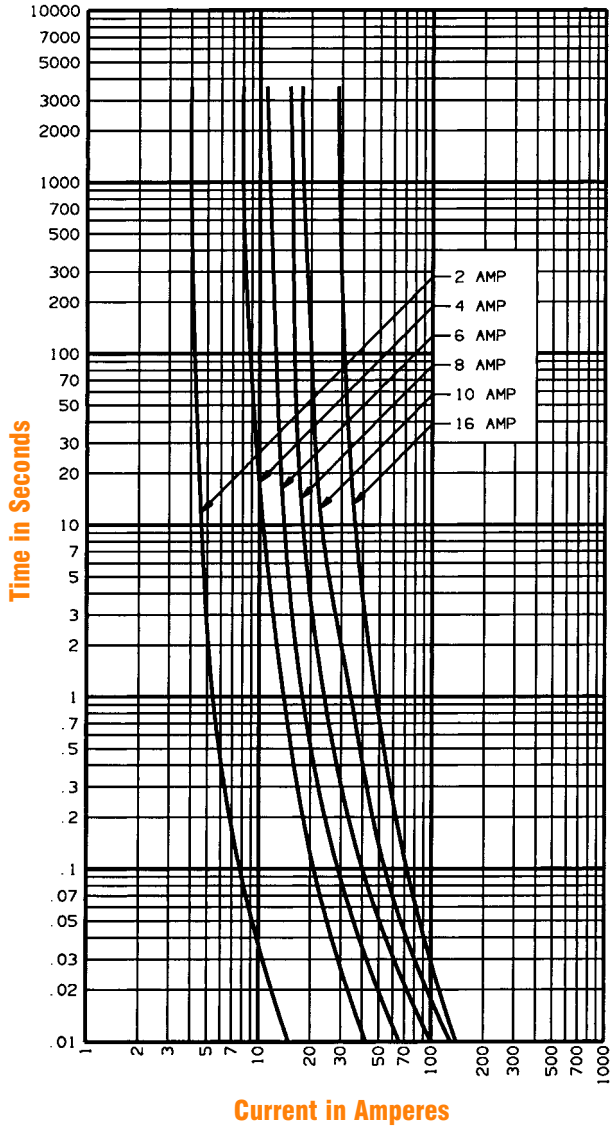

**Melting Time - Current Data — 2-32 Amperes, 400V**

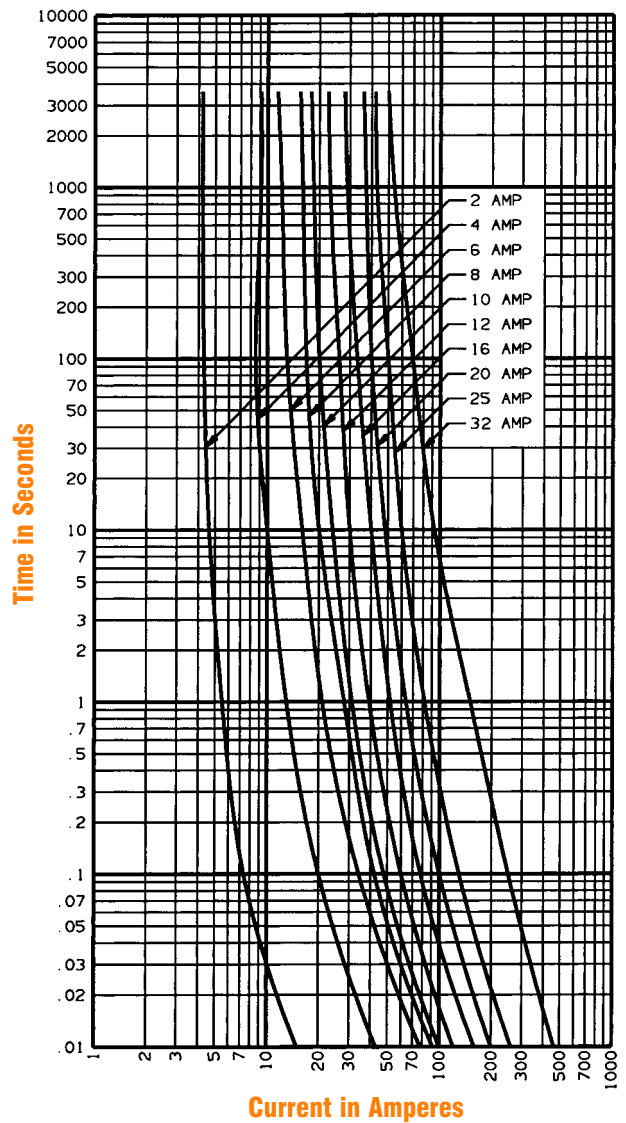

# gl-gG

## CYLINDRICAL FUSE-LINKS

Catalog Numbers, Ratings — gl-gG (Optional Blown-Fuse Indicator)



SIZE (mm x mm)	RATED In CURRENT (A)	RATED VOLTAGE	CATALOG NUMBER		INTERRUPTING RATING (A)	STANDARD PACK/CTN.				
			w/o Indicator	w/Indicator						
8 x 31	0.5	400V	15009-G	-	20,000	10/100				
	1		15011-G	15211-G						
	2		15013-G	15213-G						
	4		15019-G	15219-G						
	6		15023-G	15223-G						
	8		15027-G	15227-G						
	10		15031-G	15231-G						
	12		15033-G	15233-G						
	16		15035-G	15235-G						
	20		15037-G	15237-G						
10 X 38	0.5	500V	16009-G	-	120,000	10/100				
	1		16011-G	-						
	2		16013-G	16213-G						
	4		16019-G	16219-G						
	6		16023-G	16223-G						
	8		16027-G	16227-G						
	10		16031-G	16231-G						
	12		16033-G	16233-G						
	16		16035-G	16235-G						
	20		16037-G	16237-G						
	25		16039-G	16239-G						
	32		16043-G	16243-G						
	14 X 51		1	690V			17011-G	-	80,000	10/50
			2				17013-G	17213-G		
4		17019-G	17219-G							
6		17023-G	17223-G							
8		17027-G	17227-G							
10		17031-G	17231-G							
12		17033-G	17233-G							
16		17035-G	17235-G							
20		17037-G	17237-G							
25		17039-G	17239-G							
32		17043-G	17243-G							
40		17047-G	17247-G							
50	17051-G	17251-G								
22 x 58	2	690V	18013-G	-	80,000	10/50				
	4		18019-G	18219-G						
	6		18023-G	18223-G						
	8		18027-G	18227-G						
	10		18031-G	18231-G						
	12		18033-G	18233-G						
	16		18035-G	18235-G						
	20		18037-G	18237-G						
	25		18039-G	18239-G						
	32		18043-G	18243-G						
	40		18047-G	18247-G						
	50		18051-G	18251-G						
	63		18055-G	18255-G						
	80		18059-G	18259-G						
	100		18063-G	18263-G						
	125		18065-G	18265-G						
			500V					120,000		
			400V							



Blown-Fuse Indicator

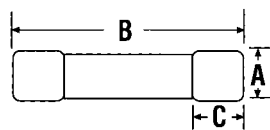

Dimensions

FUSE SIZE	A	B	C
8 x 31	8.5	31.5	6.3
10 x 38	10.3	38	10.5
14 x 51	14.3	51	13.8
22 x 58	22.2	58	16.2

# gl-gG

## CYLINDRICAL FUSE-LINKS



17447-G



18447-G

### Striker



- 1 Ceramic body
- 2 Sand
- 3 Indicator contact
- 4 Lower contact
- 5 Contact ring
- 6 Melting element
- 7 Indicator

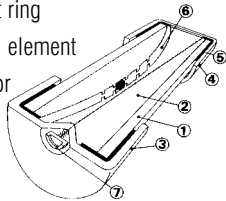

### Catalog Numbers, Ratings — gl-gG with Striker

SIZE (mm x mm)	RATED CURRENT In (A)	RATED VOLTAGE	CATALOG NUMBER	INTERRUPTING RATING (A)	STANDARD PACK/CTN.
14 X 51	2	500V	17413-G	120,000	10/50
	4		17419-G		
	6		17423-G		
	8		17427-G		
	10		17431-G		
	12		17433-G		
	16		17435-G		
	20		17437-G		
	25		17439-G		
	32		17443-G		
	40		17447-G		
	50		17451-G		
22 X 58	4	690V	18419-G	80,000	10/50
	6		18423-G		
	8		18427-G		
	10		18431-G		
	12		18433-G		
	16		18435-G		
	20		18437-G		
	25		18439-G		
	32		18443-G		
	40		18447-G		
	50		18451-G		
	63		18455-G		
	80		18459-G		
	100		18463-G		
	125		18465-G		
		500V		120,000	
		400V			

### Dimensions

FUSE SIZE	A	B	C	D	E
14 x 51	14.3	51	13.8	7.5	3.8
22 x 58	22.2	58	16.2	7.5	3.8

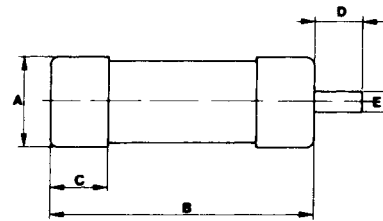

### Melting Time - Current Data — 2-125 Amperes

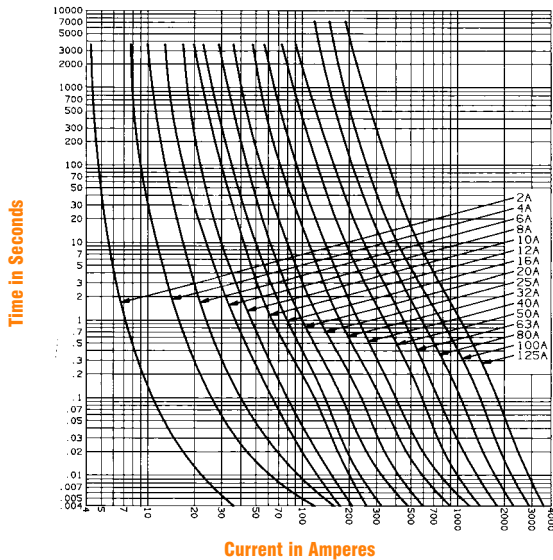

### Peak Let-Thru Current Data — 2-125 Amperes

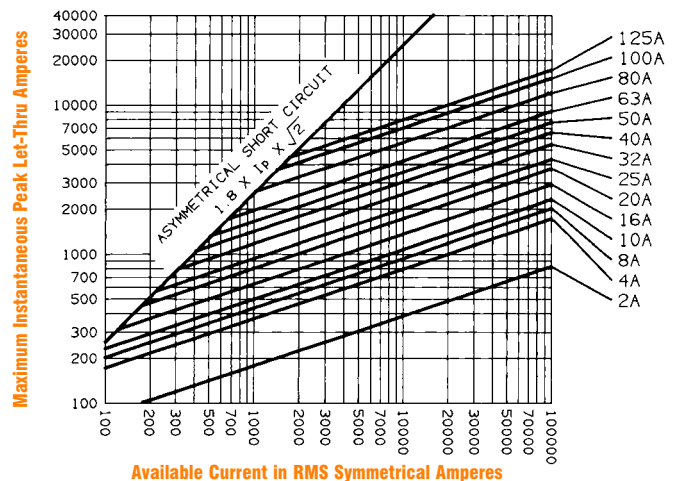

# gI-gG

## CYLINDRICAL FUSE-LINKS

### $I^2t$ Characteristics — Discrimination

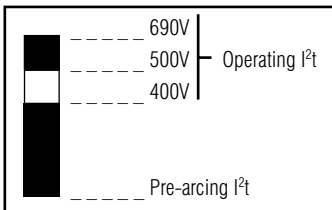
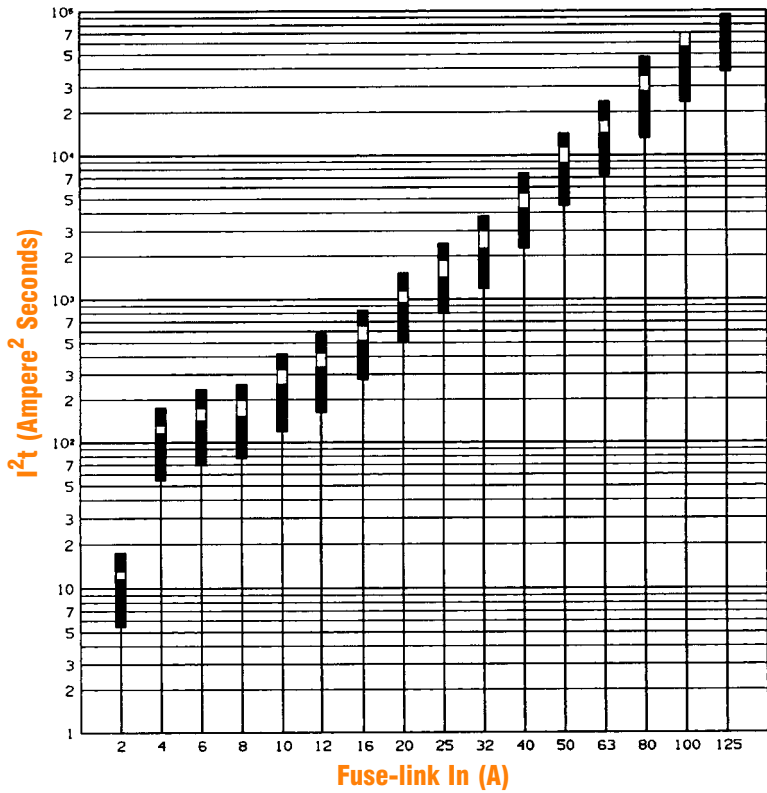

### Power Loss (Watts) at Rated Current In

RATED CURRENT (A)	SIZE		
	10 x 38	14 x 51	22 x 58
1	0.27 W		
2	0.4 W	0.5 W	
4	0.60 W	0.7 W	0.9 W
6	0.85 W	1.0 W	1.3 W
8	1.0 W	1.3 W	1.45 W
10	1.2 W	1.5 W	1.85 W
12	1.4 W	1.7 W	2.2 W
16	1.6 W	2.0 W	2.3 W
20	1.9 W	2.3 W	2.65 W
25	2.3 W	2.7 W	3.1 W
32	2.9 W	3.3 W	3.85 W
40		4 W	4.8 W
50		4.5 W	5.3 W
63			6.5 W
80			8 W
100			9 W
125			12.5 W

IEC 269-2	10 x 38	14 x 51	22 x 58
NFC 63210	25A	40A	100A
UBE 21103	3 W	5W	9.5 W

These values are much lower than those allowed by the standards.



### Temperature

Temperature rise reached by gI-gG fuse-links at  $I_n$ , measured on their upper contact.

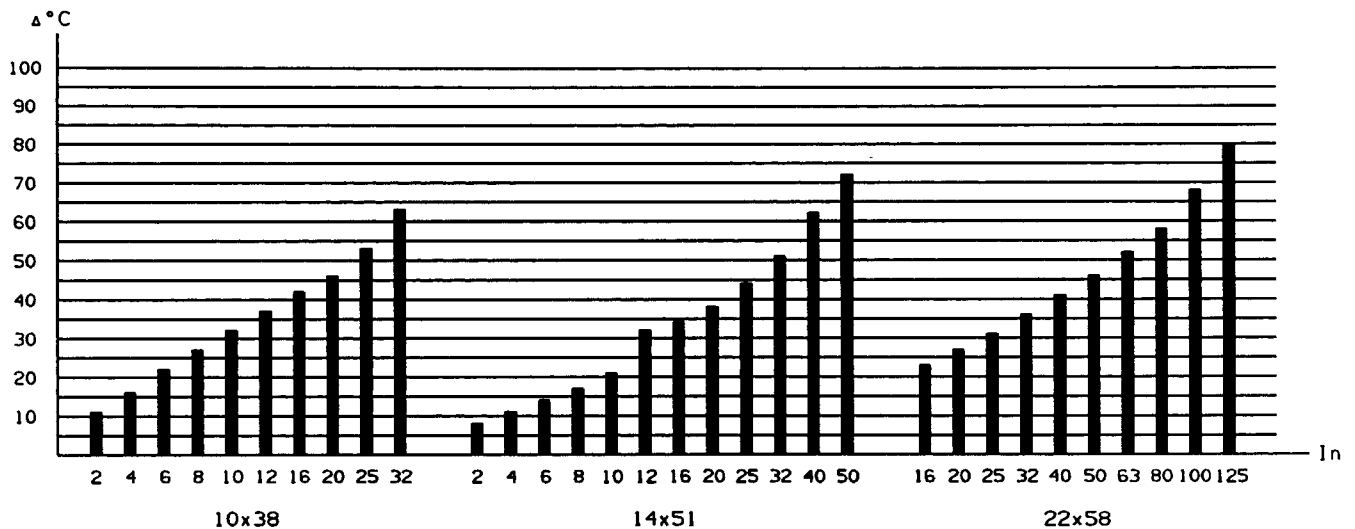

# aM

## CYLINDRICAL FUSE-LINKS

### Catalog Numbers, Ratings — aM (Optional Blown-Fuse Indicator)

SIZE (mm x mm)	RATED In CURRENT (A)	RATED VOLTAGE	CATALOG NUMBER		INTERRUPTING RATING (A)	STANDARD PACK/CTN.				
			w/o Indicator	w/Indicator						
8 x 31	1	400V	15511-G	-	20,000	10/100				
	2		15513-G	-						
	4		15519-G	-						
	6		15523-G	-						
	8		15527-G	-						
	10		15531-G	-						
10 X 38	0.16	500V	16503-G	-	120,000	10/100				
	0.25		16507-G	-						
	0.5		16509-G	-						
	1		16511-G	16711-G						
	2		16513-G	16713-G						
	4		16519-G	16719-G						
	6		16523-G	16723-G						
	8		16527-G	16727-G						
	10		16531-G	16731-G						
	12		16533-G	16733-G						
	16		16535-G	16735-G						
	20		16537-G	16737-G						
	25		16539-G	16739-G						
	32		16543-G	-						
14 X 51	0.25	690V	17507-G	-	80,000	10/50				
	0.5		17509-G	-						
	1		17511-G	17711-G						
	2		17513-G	17713-G						
	4		17519-G	17719-G						
	6		17523-G	17723-G						
	8		17527-G	17727-G						
	10		17531-G	17731-G						
	12		17533-G	17733-G						
	16		17535-G	17735-G						
	20		17537-G	17737-G						
	25		17539-G	17739-G						
	32		17543-G	17743-G						
	40		17547-G	17747-G						
	45		17549-G	17749-G						
	50		17551-G	17751-G						
	22 x 58		4	690V			18519-G	18719-G	80,000	10/50
			6				18523-G	18723-G		
8		18527-G	18727-G							
10		18531-G	18731-G							
12		18533-G	18733-G							
16		18535-G	18735-G							
20		18537-G	18737-G							
25		18539-G	18739-G							
32		18543-G	18743-G							
40		18547-G	18747-G							
50		18551-G	18751-G							
63		18555-G	18755-G							
80		18559-G	18759-G							
100		18563-G	18763-G							
125		18565-G	18765-G							
		400V				120,000				



15519-G



16535-G



17535-G



18555-G

### Blown-Fuse Indicator

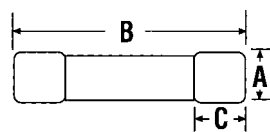

### Dimensions

FUSE SIZE	A	B	C
8 x 31	8.5	31.5	6.3
10 x 38	10.3	38	10.5
14 x 51	14.3	51	13.8
22 x 58	22.2	58	16.2



# aM

## CYLINDRICAL FUSE-LINKS

### Catalog Numbers, Ratings — aM with Striker



17947-G



18951-G

### Striker



BEFORE

AFTER

SIZE (mm x mm)	RATED In CURRENT (A)	RATED VOLTAGE	CATALOG NUMBER	INTERRUPTING RATING (A)	STANDARD PACK/CTN.
14 X 51	1	500V	17911-G	120,000	10/50
	2		17913-G		
	4		17919-G		
	6		17923-G		
	8		17927-G		
	10		17931-G		
	12		17933-G		
	16		17935-G		
	20		17937-G		
	25		17939-G		
	32		17943-G		
	40		17947-G		
	45		17949-G		
	50		17951-G		
22 X 58	4	690V	18919-G	80,000	10/50
	6		18923-G		
	8		18927-G		
	10		18931-G		
	12		18933-G		
	16		18935-G		
	20		18937-G		
	25		18939-G		
	32		18943-G		
	40		18947-G		
	50		18951-G		
	63		18955-G		
	80		18959-G		
	100		18963-G		
	125		18965-G		
		400V			



### Dimensions

FUSE SIZE	A	B	C	D	E
14 x 51	14.3	51	13.8	7.5	3.8
22 x 58	22.2	58	16.2	7.5	3.8

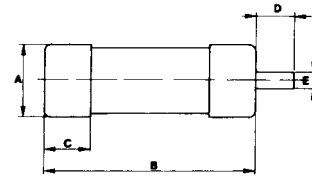

Melting Time - Current Data — 1-125 Amperes

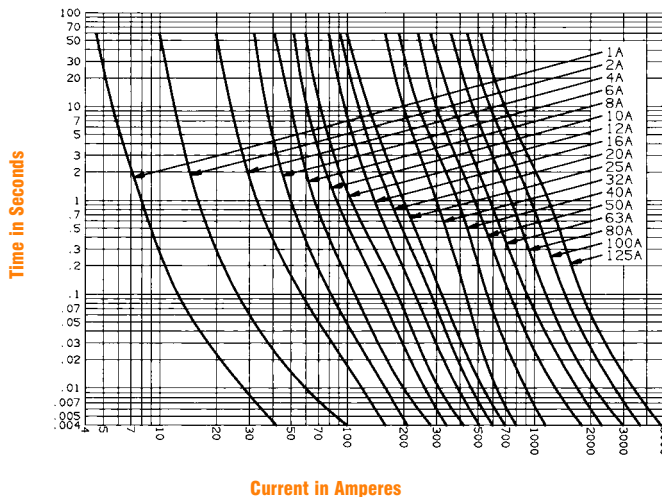

Peak Let-Through Current Data — 1-125 Amperes

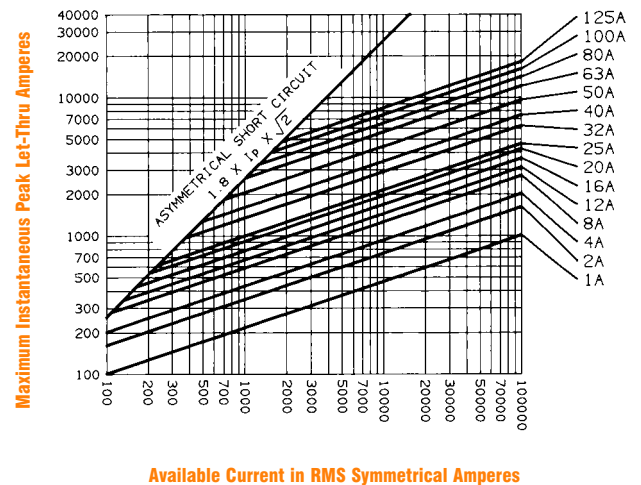



# aM

## CYLINDRICAL FUSE-LINKS

### $I^2t$ Characteristics — Discrimination

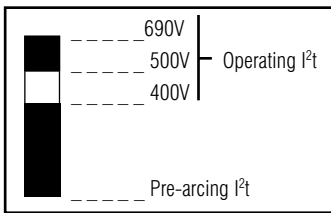
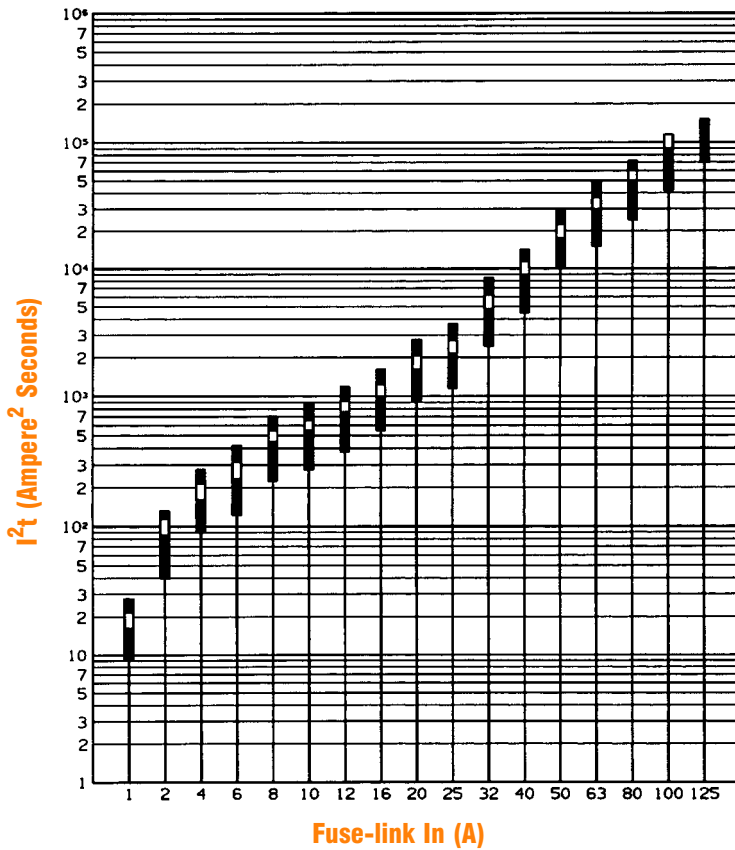

### Power Loss (Watts) at Rated Current $I_n$

RATED $I_n$ CURRENT (A)	SIZE		
	10 x 38	14 x 51	22 x 58
1	0.1 W		
2	0.2 W	0.3 W	
4	0.3 W	0.4 W	0.5 W
6	0.4 W	0.5 W	0.6 W
8	0.5 W	0.6 W	0.8 W
10	0.6 W	0.8 W	1.0 W
12	0.7 W	1.0 W	1.2 W
16	0.8 W	1.2 W	1.5 W
20	1.2 W	1.5 W	1.8 W
25	1.6 W	1.9 W	2.0 W
32	2.0 W	2.3 W	2.6 W
40		2.6 W	3.2 W
50		2.9 W	3.9 W
63			4.7 W
80			5.9 W
100			6.5 W
125			9.5 W

IEC 269-2	10 x 38	14 x 51	22 x 58
NFC 63210	16 A	50 A	100 A
UNE 21103	1.2 W	3 W	7 W

These values are much lower than those allowed by the standards.

### Temperature

Temperature rise reached by aM fuse-links at  $I_n$ , measured on their upper contact.

