

Introduction

Belling Lee is a brand name of BLP Components Ltd. BLP Components design, develop and manufacture a wide range of electrical and electronic products for diverse markets.

This catalogue provides a guide to the new **Belling Lee** range of commercial fuseholders. Available in a number of mounting styles and current ratings, these new fuseholders extend the range of circuit protection solutions provided by **Belling Lee**.

BLP Components operate a quality management system which complies with the requirements of BS EN ISO 9001: 1994 and QS 9000: March 1998. Detailed data sheets for the products listed in this catalogue are available on request.



L3311



Type: 20 x 5mm fuseholder

Rating: 10A @ 250Vac

Insulation Resistance: 100 Mohms @ 500v DC

Breakdown Voltage: 1500V AC for 1 Min

Approvals: UL/CSA

Fuse Size: 20 x 5mm

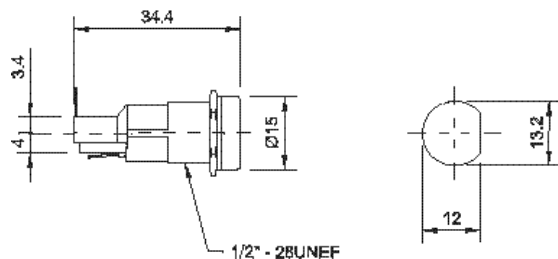

L3311B



Type: 20 x 5mm fuseholder

Rating: 10A @ 250Vac

Insulation Resistance: 100 Mohms @ 500v DC

Breakdown Voltage: 1500V AC for 1 Min

Approvals: UL/CSA

Fuse Size: 20 x 5mm

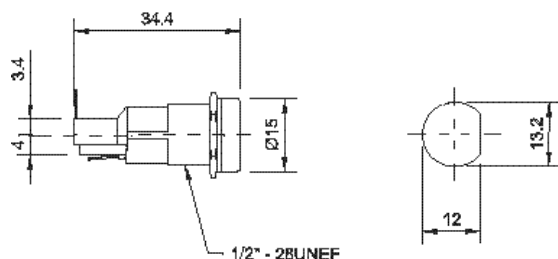

L3312



Type: 20 x 5mm fuseholder

Rating: 10A @ 250Vac

Insulation Resistance: 100 Mohms @ 500v DC

Breakdown Voltage: 1500V AC for 1 Min

Approvals: UL/CSA

Fuse Size: 20 x 5mm

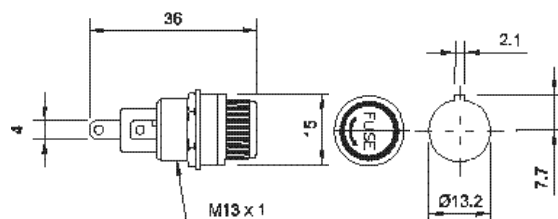

L3324



Type: 20 x 5mm fuseholder

Rating: 10A @ 250Vac

Insulation Resistance: 100 Mohms @ 500v DC

Breakdown Voltage: 1000V AC for 1 Min

Approvals: UL

Fuse Size: 20 x 5mm

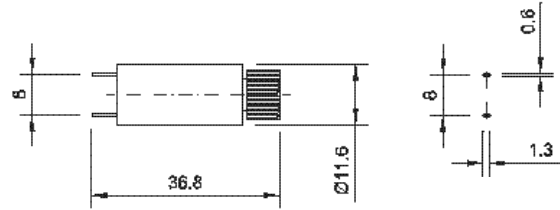

L3354



Type: 20 x 5mm fuseholder

Rating: 6.3A @ 250Vac

Insulation Resistance: 100 Mohms @ 500v DC

Breakdown Voltage: 1500V AC for 1 Min

Approvals: UL/CSA applied for

Fuse Size: 20 x 5mm

