



# MARUSHIN ELECTRIC MFG. CO., LTD. LAMP BRACKETS.

## No. MB-215

"A" TYPE LAMP BRACKET w/bayonet base

## No. MB-216

"A" TYPE LAMP BRACKET

w/screw and bayonet available base

Net Weight: 17 gr.

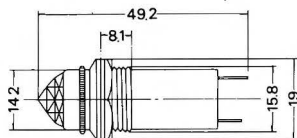

## No. MB-203D

"B" TYPE DIAMOND BABY LAMP BRACKET  
(Diamond cutting plastic head) (w/6 or 12V BULB)

Net Weight: 8 gr.

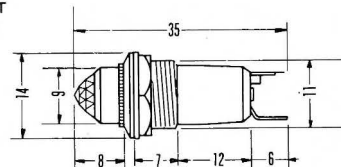

## No. MB-214

"A" TYPE LAMP BRACKET w/screw base

Net Weight: 16 gr.

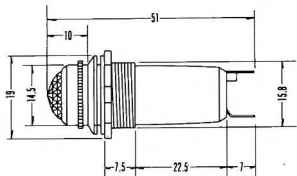

## No. MB-203

"B" TYPE BABY LAMP BRACKET

w/screw base (w/6 or 12V BULB)

Color: Red, Green, Orange, Blue

Net Weight: 8 gr.

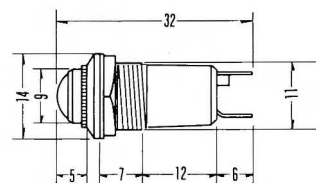

## No. MB-214D

"A" TYPE MOLDED LAMP BRACKET

Net Weight: 13 gr.

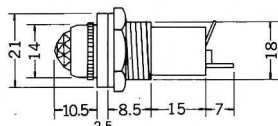

## No. MB-403 6V, 12V, 24V

WITH BUILT-IN INCANDESCENT

Net Weight: 1.6 gr.

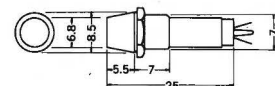

## No. MB-211

ROUND TYPE LAMP BRACKET

w/screw base

## No. MB-212

ROUND TYPE LAMP BRACKET

w/bayonet base

Net Weight: 12.5 gr.

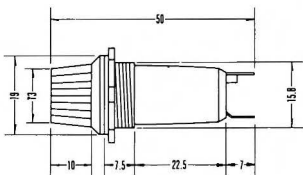

## No. MB-404 6V, 12V, 24V

WITH BUILT-IN INCANDESCENT

Net Weight: 1.7 gr.

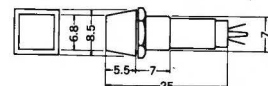

## No. MB-209

LAMP BRACKET w/screw base

## No. MB-210

LAMP BRACKET w/bayonet base

Net Weight: 9 gr.

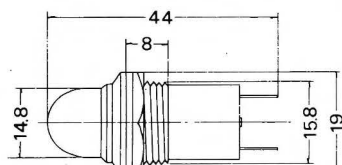

## No. MB-405 6V, 12V, 24V

WITH BUILT-IN INCANDESCENT

Net Weight: 1.6 gr.

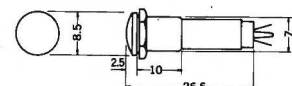

## No. MB-208H

ROUND TYPE MOLDED LAMP BRACKET

Net Weight: 8.5 gr.

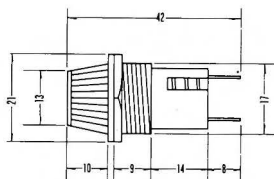

## No. MB-406 6V, 12V, 24V

WITH BUILT-IN INCANDESCENT

Net Weight: 0.0 gr.

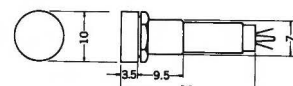

## No. MB-208

MOLDED LAMP BRACKET w/screw base

Net Weight: 8.5 gr.

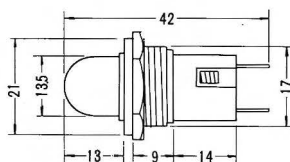
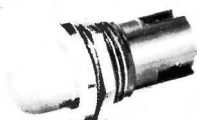

## No. MB-415 6V, 12V, 24V

WITH BUILT-IN INCANDESCENT

Net Weight: 0.7 gr.

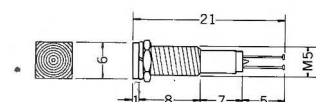

## No. MB-201

BABY LAMP BRACKET w/screw base (w/6 or 12V BULB)

Color: Red, Green, Orange, Blue,

Net Weight: 5.5 gr.

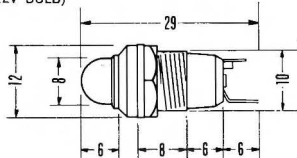

## No. MB-416 6V, 12V, 24V

WITH BUILT-IN INCANDESCENT

Net Weight: 0.7 gr.

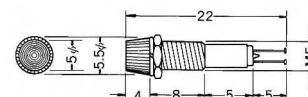

## No. MB-202

ROUND TYPE BABY LAMP BRACKET

w/screw base (w/6 or 12V BULB)

Color: Red, Green, Orange, Blue

Net Weight: 6.3 gr.

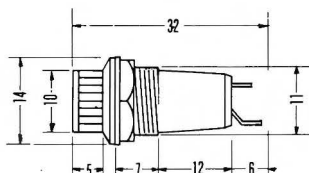



# MARUSHIN ELECTRIC MFG. CO., LTD.

## FUSE HOLDERS, FUSES, BULBS & SOCKETS.

### No. ME-523

PILOT LAMP BASE w/"L" type Holder

Net Weight: 1.5 gr.

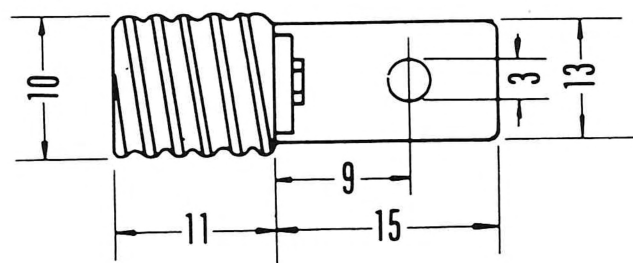
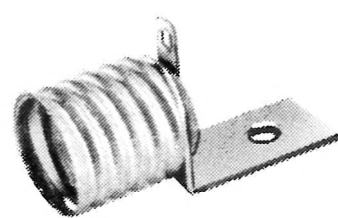

### No. MF-503

IN-LINE FUSE HOLDER

Net Weight: 3 gr.

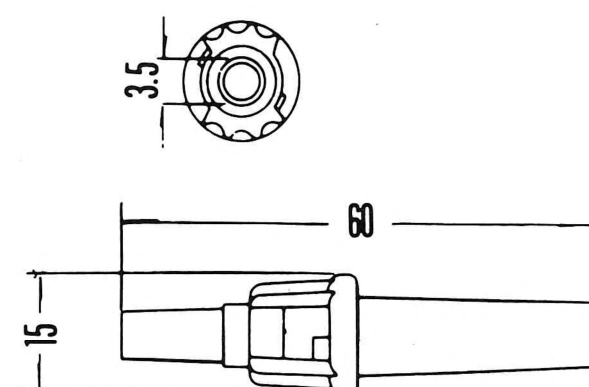
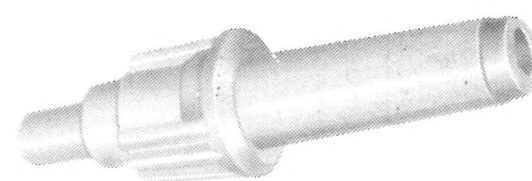

### No. ME-522

PILOT LAMP BASE w/Rubber Bush

Net Weight: 2.2 gr.



### No. ME-521

PILOT LAMP BASE w/solder terminal

Net Weight: 1.5 gr.



### No. MF-503LS

MINIATURE IN-LINE FUSE HOLDER

Net Weight: 2.2 gr.

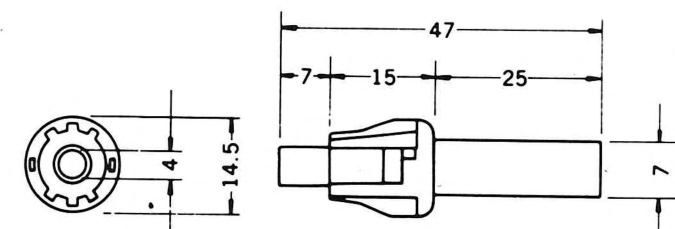
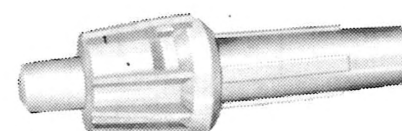

### No. ME-529

PILOT LAMP BASE w/MOLDED COVER

Net Weight: 3.5 gr.

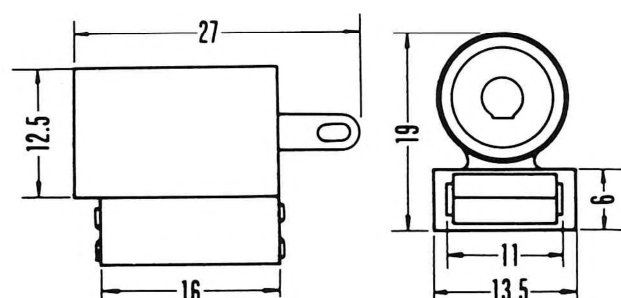
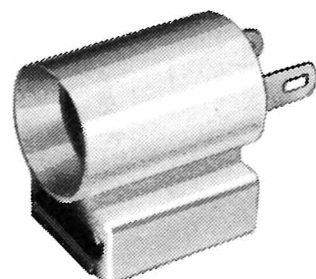

### No. MF-520

IN-LINE FUSE HOLDER

Net Weight: 3 gr.

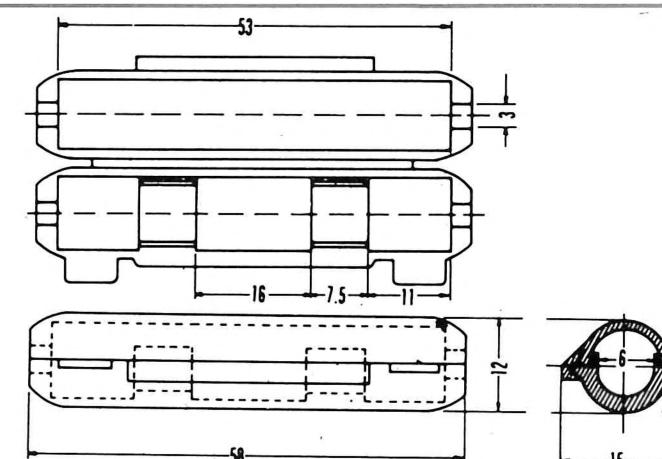
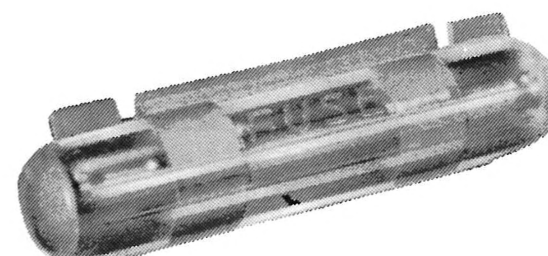

### No. ME-515

PILOT LAMP 6 Volt.

Net Weight: 0.5 gr.

### No. ME-516

PILOT LAMP 12 Volt.

Net Weight: 0.5 gr.



### No. ME-518

PILOT LAMP 6V

### No. ME-519

PILOT LAMP 12V

Net Weight: 2 gr.



### No. MF-504

SINGLE FUSE BASE w/clear cover

Net Weight: 7 gr.

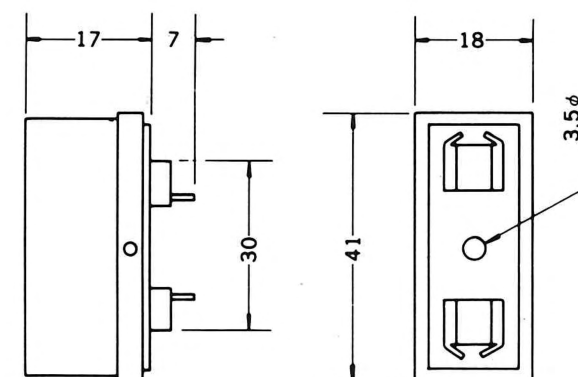
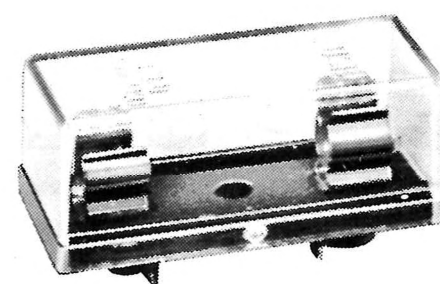

GLASS PIPE FUSE (6φ×30mm) mm)

No. MF-509 0.5 Amp.

No. MF-510 1 Amp.

No. MF-511 2 Amp.

No. MF-512 3 Amp.

No. MF-513 5 Amp.

Net Weight: 1.8 gr



### No. MF-505W

DOUBLE FUSE BASE

Net Weight: 4 gr.

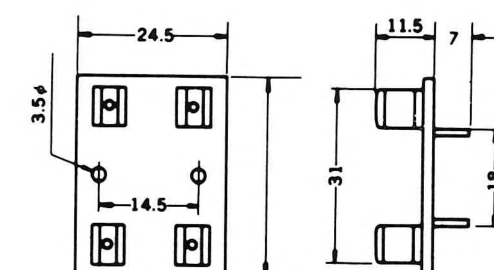
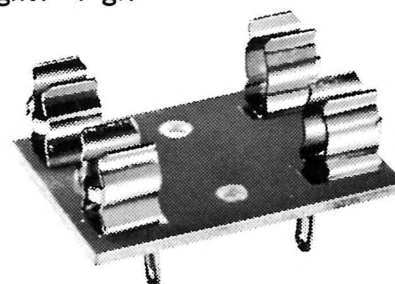

MIDGET GLASS PIPE FUSE (5φ×20mm)

No. MF-535 0.5 Amp.

No. MF-536 1 Amp.

No. MF-537 2 Amp.

No. MF-538 3 Amp.

No. MF-539 5 Amp.

Net Weight: 0.7 gr.

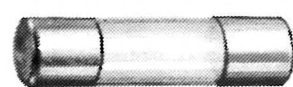

### No. MF-505

SINGLE FUSE BASE

Net Weight: 2 gr.

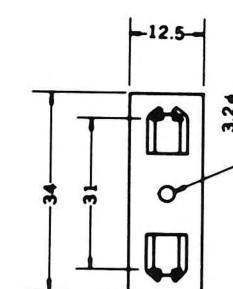
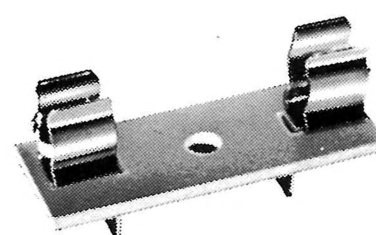

### No. MF-505LS

MINIATURE SINGLE FUSE BASE

Net Weight: 1.5 gr.

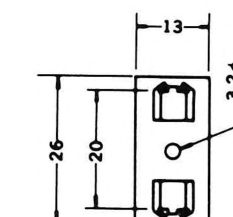
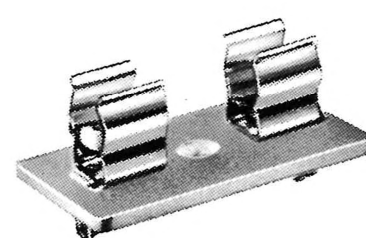

### No. MF-508LS

MINIATURE SINGLE FUSE BASE

Net Weight: 2 gr.

