

## Overview of technical specifications

Protective field width	0.1 m ... 6 m	
Protective field height (depending on type)	150 mm ... 900 mm	
Resolution	30 mm	
Type	Type 2 according to EN 50100	
Enclosure rating	Sender/receiver unit	IP 65
	Control unit	IP 54

## Product description

Due to its compact design, the LGT safety light curtain is suitable for applications on small machines, where space is limited. Functions and status information integrated in the control unit allow rapid commis-

sioning and prevent unnecessary machine downtimes. Sector-oriented service concepts round off the product range and can be combined to form a customer-specific package of solutions.

## Applications

→ You can find more applications using the application finder at [www.sickusa.com/applications](http://www.sickusa.com/applications)

- Storage and conveyor technology
- Wood industry
- Textile industry
- Stone production
- Electronics industry
- Packaging industry

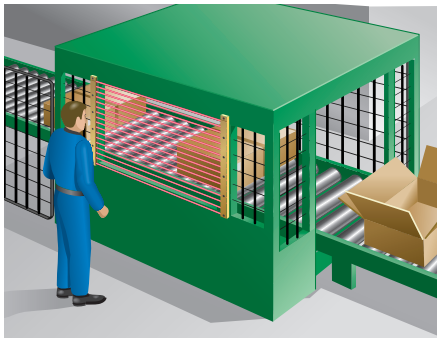

Packaging industry: LGT on a packaging machine

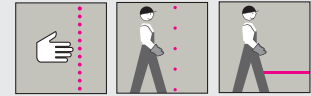

E

- Restart interlock (RES)
- External device monitoring (EDM)
- 7-segment display
- Diagnostics
- Blanking
- Small design



Further information	Page
→ Ordering information	E-148
→ Technical specifications	E-149
→ Dimensional drawings	E-150
→ Services	A-2

## Ordering information

### LGT

LGT consisting of:

- Sender unit (LGTS) and receiver unit (LGTE)
- Control unit (LGTN)

#### Sender and receiver units

Protective field height (mm)	Sender unit		Receiver unit	
	Type	Part number	Type	Part number
150	LGTS015-051	1013413	LGTE015-051	1013414
300	LGTS030-111	1013415	LGTE030-111	1013416
450	LGTS045-171	1013417	LGTE045-171	1013418
600	LGTS060-231	1013419	LGTE060-231	1013420
750	LGTS075-291	1013421	LGTE075-291	1013422
900	LGTS090-351	1013423	LGTE090-351	1013424

#### Control units

Designation	Description	Type	Part number
Control unit	■ 24 V DC	LGTN101-511	6010683
	■ 115 / 230 V AC + 24 V DC	LGTN101-311	6010521
	■ 24 V DC ■ For installation in control cabinets	LGTN101-521	6008527
	■ 115 / 230 V AC + 24 V DC ■ For installation in control cabinets	LGTN101-321	6008526

#### Accessories

Designation	Connection cable	Part number
Connection cable with socket	2.5 m	6009923
	5 m	6009924
	10 m	6009926
	15 m	6008410
	20 m	6008411
Snap-on clip	—	4028654

## Detailed technical specifications

→ You can find more detailed data in the operating instructions/technical description. Download at [www.sickusa.com/literature](http://www.sickusa.com/literature)

### General system data

Protective field width		0.1 m ... 6 m
Protective field height (depending on type)		150 mm ... 900 mm
Resolution		30 mm
Enclosure rating	Sender/receiver unit Control unit LGTN	IP 65 IP 54
Type		Type 2 according to EN 50100
Synchronisation		Electrical synchronisation
Supply voltage $V_s$ <sup>1)</sup>	Direct current Residual ripple	24 V (19.2 V ... 28.8 V) DC 5 V <sub>PP</sub>
	Alternating current Frequency	115 V (92 V ... 126,5 V) AC / 230 V (184 V ... 253 V) AC 50 Hz (48 Hz ... 62 Hz)
Power consumption		Max. 13 W / 16 VA
Response time (depending on type)		Max. 50 ms
Master relay	Resistive switching capacity Inductive switching capacity	Max. 4 A, 45 V DC Max. 4 A, 25 V DC
Auxiliary relay	Resistive switching capacity Inductive switching capacity	Max. 8 A, 55 V DC Max. 8 A, 15 V DC

### Operating data

Connection type	PG11
Connection cable length	Max. 10 m
Ambient operating temperature $T_A$	-10 °C ... +55 °C
Storage temperature $T_S$	-25 °C ... +70 °C
Air humidity	15 % ... 95 %
Housing cross-section	10 mm x 30 mm
Vibration resistance	5 g, 10 ... 55 Hz according to IEC 60068-2-6
Shock resistance	10 g, 16 ms according to IEC 60068-2-29

<sup>1)</sup> A power supply unit with safe isolation (SELV, PELV circuit) is to be used

## Dimensional drawings

### Sender unit LGTS and receiver unit LGTE

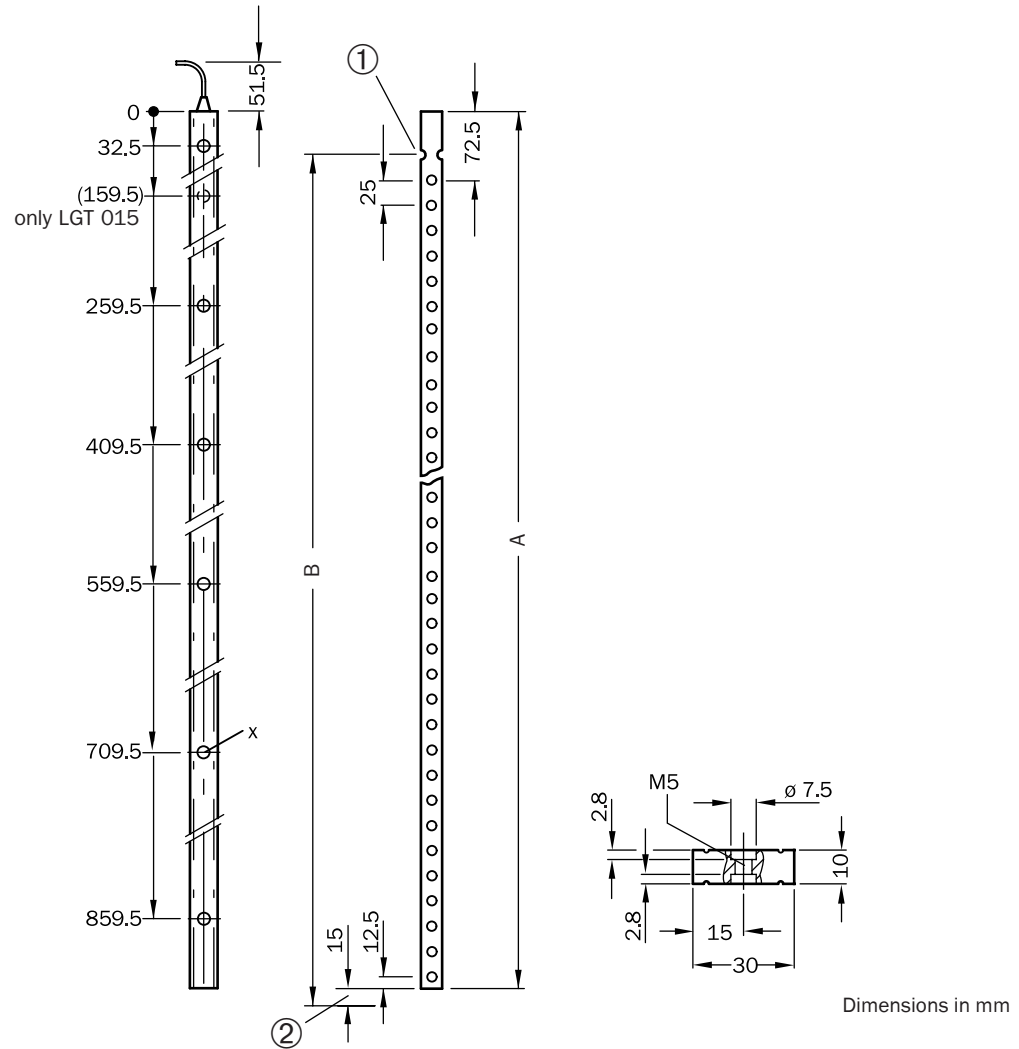

- ① The upper limit of the protective field is indicated by a cut-out in the housing  
 ② The lower limit of the protective field is 15 mm from the end of the housing

LGT type	Number of beams	Housing length A (mm)	Protective field height B (mm)
015	5	185	155
030	11	335	305
045	17	485	455
060	23	635	605
075	29	785	755
090	35	935	905

Control unit LGTN with housing

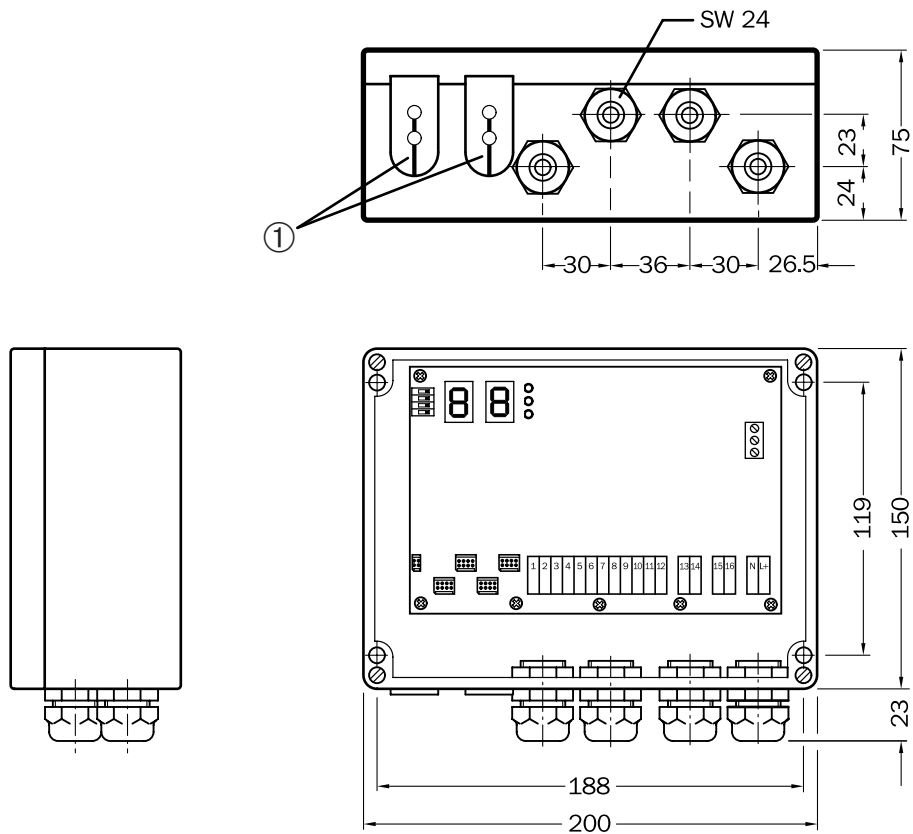

Dimensions in mm

① To insert cable: remove bush and push apart

Control unit LGTN for installation in control cabinets

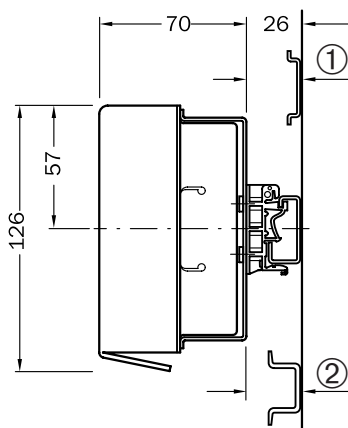

- ① For mounting on low 20 mm mounting rail
- ② For mounting on high 28 mm mounting rail

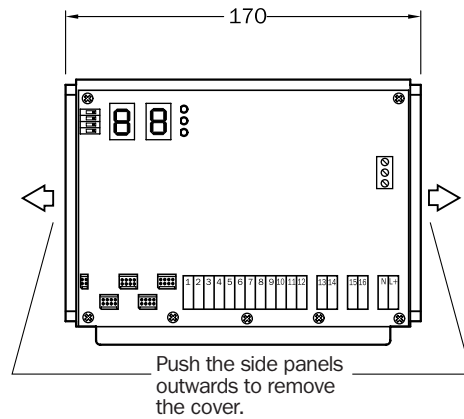

Dimensions in mm