

# Upright Gage

## SERIES 547, 7

SPC

ABSOLUTE®

Absolute System Patented by MITUTOYO

(Refer to the page 9 for details.)



Digimatic indicator used  
(0.001mm resolution)

Digimatic indicator used  
(0.01mm resolution)

### Technical Data of Digital Models

Accuracy: Refer to the list of specifications  
(excluding quantizing error)

Resolution: 0.01mm, 0.001mm, .0005"/0.01mm or  
.00005"/0.001mm

Display: LCD

Length standard: ABSOLUTE electrostatic capacitance type  
linear encoder

Max. response speed: Unlimited

Contact point: ø3mm carbide flat type  
(7051: ø6mm flat type)

Measuring force: Refer to the list of specifications

Battery: SR44 (1 pc.) **938882**

Battery life: Approx. 5,000 hours under normal use

### Function of Digital Models

Origin-set/Preset, Zerose, GO/±NG judgment, Counting  
direction switching, Power ON/OFF, Data output, inch/mm  
conversion (inch/mm models)

Alarm: Low voltage, Counting value composition error,  
Over-flow error, Tolerance limit setting error

### Optional Accessory

**905338:** SPC cable (1m) for digital models

**905409:** SPC cable (2m) for digital models

**902190:** ø80mm large diameter anvil

**903526:** ø50mm ceramic anvil

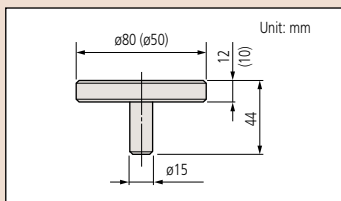

### FEATURES

- The Digimatic Upright Gage offers multiple functions including GO/±NG judgment, and SPC data output.
- Compact and inexpensive gaging unit that consists of a dial indicator and a stand.

- Suitable for inspecting small parts on the shop floor.
- Anvil size: 40mm or 50mm in diameter.



### SPECIFICATIONS

#### Metric Digital Type

Range	Order No.	Resolution	Workpiece height	Accuracy	Measuring force	Remarks (type of anvil)
12mm	<b>547-054</b>	0.01mm	30mm	±0.02m	1.5N or less	ø40mm steel type
12mm	<b>547-053</b>	0.001mm	30mm	±3µm	1.5N or less	ø50mm ceramic type
12mm	<b>547-055</b>	0.001mm	30mm	±3µm	1.5N or less	ø40mm steel type

#### Inch/Metric Digital Type

Range	Order No.	Resolution	Workpiece height	Accuracy	Measuring force	Remarks (type of anvil)
.5"	<b>547-034</b>	.0005"/0.01mm	1.2"	±.001"	1.5N or less	1.57" DIA steel type
.5"	<b>547-033</b>	.00005"/0.001mm	1.2"	±.00015"	1.5N or less	1.97" DIA ceramic type
.5"	<b>547-035</b>	.00005"/0.001mm	1.2"	±.00015"	1.5N or less	1.57" DIA steel type

#### Metric Dial Type

Range	Order No.	Graduation	Workpiece height	Accuracy	Measuring force	Remarks (type of anvil)
10mm	<b>7050</b>	0.01mm	20mm	±0.02m	1.4N or less	ø40mm steel type
10mm	<b>7051</b>	0.01mm	20mm	±0.02m	1.4N or less	ø40mm steel type
10mm	<b>7052</b>	0.01mm	35mm	±0.02m	1.4N or less	ø40mm steel type
1mm	<b>7053</b>	0.001mm	30mm	±3µm	1.5N or less	ø40mm steel type

#### Inch Dial Type

Range	Order No.	Graduation	Workpiece height	Accuracy	Measuring force	Remarks (type of anvil)
1"	<b>7056</b>	.001"	1"	±.002"	1.4N or less	1.57" DIA steel type

### DIMENSION

