

No-Mark WASHERS

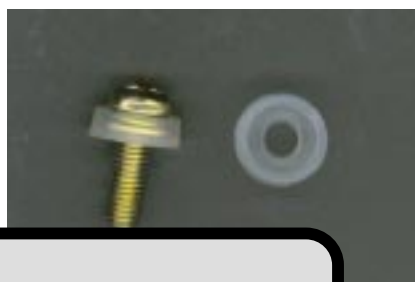

DRAFT



Typical items illustrated below are approximately full size

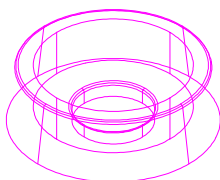

Especially designed for the protection of panels from the heads of fixing screws, CASA's No-Mark washers save expensive equipment from being defaced by screw heads and at the same time give a measure of anti-vibration security. They are usable with many ISO and SEMS screws which CASA can also provide in various sizes.

Special Features Include:-

- 1) **Captive fit on many Standard Pan Head Screws** (M5 or M6 and other thread forms can be made to order).
- 2) **Moulded from High Strength plastic** (or punched from HD Polyethylene or Red Fibre as appropriate).
- 3) **Available in neutral opaque white** (Red Fibre or other colours available to order - minimum quantities may apply)
- 4) **Pre-packaged in self-sealing bags of 50 pieces** (bulk delivery in bags of 500, 1000 or 2500 pieces to order)
- 5) **Manufactured in New Zealand using our special dies**

Provisional Specification Details:- (physical details on reverse of this data sheet - available soon)

➔ Sizes:- (only sizes in common production are listed at this time) (others available subject to tooling being made)	M5 (ID = 4.9mm - OD = 12.7) M6 (ID = 5.9mm - OD = 12.x)
➔ Diameters:- (not thread specific but a captive fit is desirable) (other thread forms undertaken to special order)	M5 or M6 (others to order) (outer diameter 12~12.7mm)
➔ Materials:- (other alloys & materials subject to special order)	HD Polyethylene Red Fibre (others to order)
➔ Tensile & Compressive Ratings:-	(depends upon material) (to be calculated)
➔ Weight:- Size:- (Thread/ID x OD x Gauge as below) Packaging:- (CASA's sealed Polyethylene bags and labels)	(type / model specific) (type / model specific) 50 pack or as required

Part Number:- WNM/FW-ID-OD-MAT-Ga(special adder/suffix)

Please compose a Part Number according to this system and use on your official order.

WNM- Prefix to indicate "Washer, No-Mark" or use "FW" for flat washers
ID- Metric Internal Diameter in mm
OD- The Overall Diameter in mm
MAT- Material designator where "PL" = Plastic, "RF" = Red Fibre etc.
Ga- Gauge / Thickness of material in mm x 10 (eg 0.8mm = 8)
(suf)- Suffix to indicate colour and/or special features and properties