

Unsupported arrangement

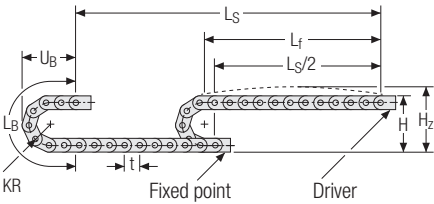

KR [mm]	H [mm]	Hz [mm]	LB [mm]	UB [mm]
28	74	89	124	55
37	92	107	153	64
50	118	133	194	77

Inner
heights



Inner
widths



Load diagram for unsupported length depending on the additional load.

Sagging of the cable carrier is technically permitted for extended travel lengths, depending on the specific application.

Intrinsic cable carrier weight $q_k = 0.25 \text{ kg/m}$ with $B_i 10 \text{ mm}$. For other inner widths, the maximum additional load changes.

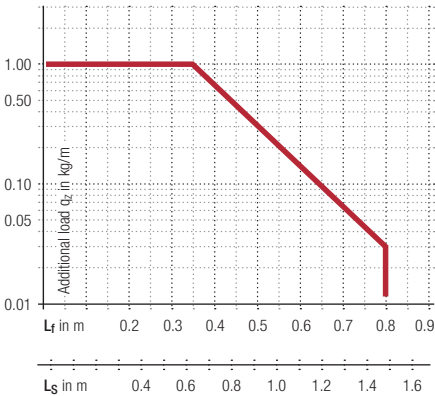

Speed
up to 10 m/s



Acceleration
up to 50 m/s²



Travel length
up to 1.5 m



Additional load
up to 1.0 kg/m

Gliding arrangement

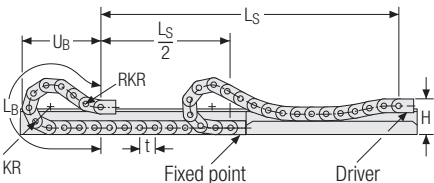

Speed
up to 3 m/s



Acceleration
up to 30 m/s²



Travel length
up to 70 m



Additional load
up to 1.0 kg/m



The gliding cable carrier must be guided in a channel. See p. 782.

Only designs 020 and 030 can be used for a gliding arrangement.

tsubaki-kabelschlepp.com/
mono

Type 0180 – with outside
opening crossbars

- Weight optimised plastic frame with high torsional rigidity.
- Openable at any position.
- **Outside:** openable.



Inner heights



Inner widths



Stay arrangement on each chain link (**VS: fully-stayed**)



B_i 10 – 40 mm

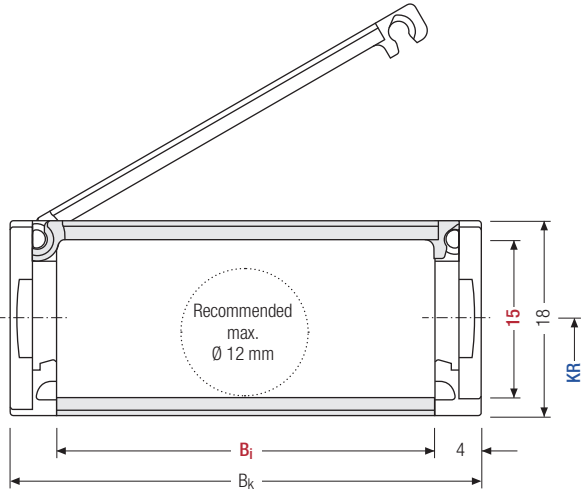

The maximum cable diameter strongly depends on the bending radius and the desired cable type. Please contact us.

Calculating the cable carrier length

Cable carrier length L_k

$$L_k \approx \frac{L_S}{2} + L_B$$

Cable carrier length L_k rounded to pitch t

tsubaki-kabelschlepp.com/
mono

h_i [mm]	h_G [mm]	B_i [mm]					B_k [mm]	KR [mm]			q_k [kg/m]
15	18	10	15	20	30	40	$B_i + 8$	28	37	50	0.169 – 0.252

Order example



MONO . 0180 . 30 . 37 . 720 . VS

Series Type B_i [mm] KR [mm] L_k [mm] Stay arrangement

Single-part end connectors – plastic
(with integrated strain relief)

The plastic end connectors can be connected **from above or below**. The connection type can be changed by altering the position of the end connector.

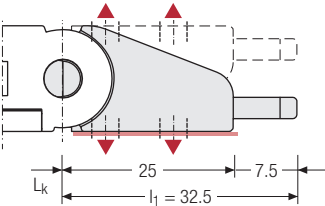

Bj: 10/15/20

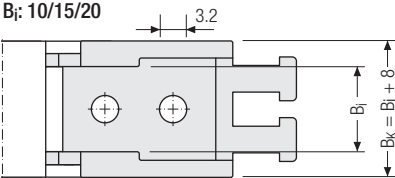

Bj: 30/40

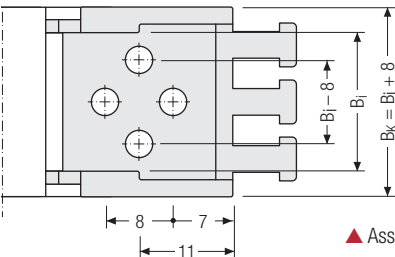

▲ Assembly options

Single-part end connectors – plastic

The plastic end connectors can be connected **from above or below**. The connection type can be changed by altering the position of the end connector.

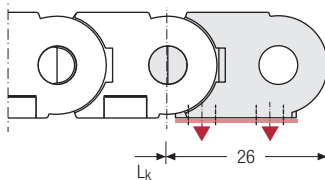

Bj: 10/15/20

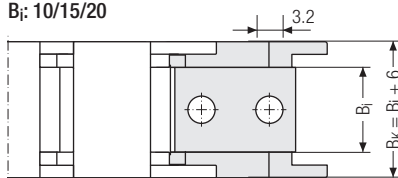

Bj: 30/40

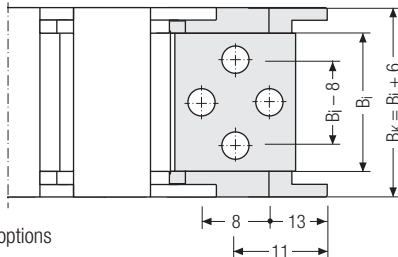

Connection point

F – fixed point
M – Driver

Connection type

A – threaded joint outside (standard)
I – threaded joint inside

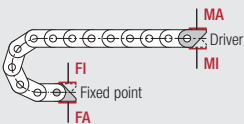

Connection point

F – fixed point
M – Driver

Connection type

A – threaded joint outside (standard)
I – threaded joint inside

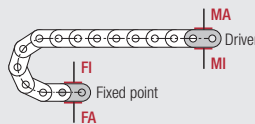

Order example



End connector	F	A
End connector	M	A
End connector	Connection point	Connection type

Inner heights



Inner widths



tsubaki-kabelschlepp.com/
mono