

1 1 2 6

DIN 6336 PHENOLIC

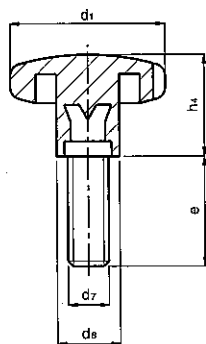
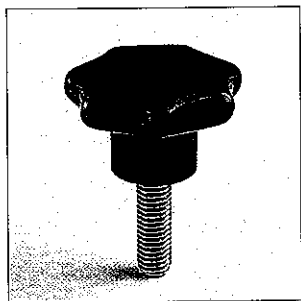

d ₁	h ₁	d ₂	e	d	ART Forma T
20	13	M4	15	10	1126 20 501
25	16	M5	20	12	1126 25 501
32	20	M6	20	13	1126 32 501
32	20	M6	40	13	1126 32 502
40	25	M8	27	19	1126 40 501
40	25	M8	47	19	1126 40 502
50	32	M10	44	20	1126 50 501
50	32	M10	64	20	1126 50 502
63	40	M12	40	23	1126 63 501
63	40	M12	60	23	1126 63 502
80	50	M16	55	30	1126 80 501
80	50	M16	75	30	1126 80 502

Forma T

- Resina fenólica FS 31 DIN 7708, color negro y espiga de hierro tratado.
- Black Duroplast FS 31 DIN 7708, with treated threaded steel stud.
- Duroplast FS 31 DIN 7708, schwarz, Gewinde aus behandeltem Stahl.
- Duroplast FS 31 DIN 7708, noir, tige acier traité.
- Duroplasto FS 31 DIN 7708, nero, vite in acciaio trattato.

1 1 3 0

BIBOLA HANDLE

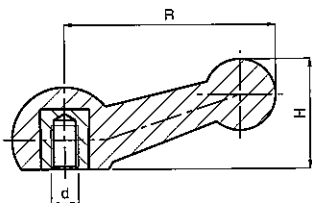
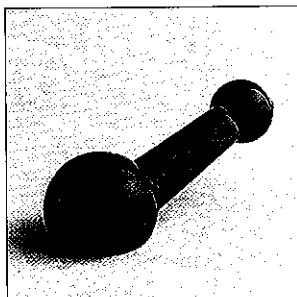

R	H	d	ART
77	40	M10	1130 08 302

- P.A. 6 color negro y casquillo de hierro tratado.
- Black P.A. 6 with treated steel insert.
- P.A. 6 schwarz, Buchse aus behandeltem Stahl.
- P.A. 6 noir, insert acier traité.
- P.A. 6 nero, inserto in acciaio trattato.

1 1 3 1

PHENOLIC FOUR SPOKE HAND WHEEL

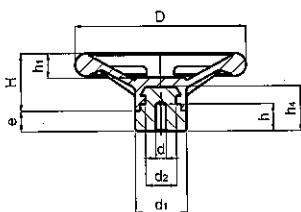
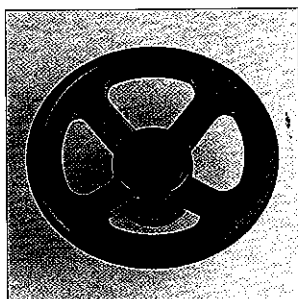

Forma N

D	H	d ₁	h ₁	d ₂	h ₂	d ₃	e	h	d ₄	ART	
										Forma N	Forma A
100	30	5,25	20	18	26	30	16	15	M6	1131 10 601	1131 10 651
125	28	8	25	28	32	40	22	14	M6	1131 12 601	1131 12 651
150	48	10	30	30	55	50	30	18	M8	1131 15 601	1131 15 651
175	49	10	30	30	55	50	30	20	M10	1131 17 601	1131 17 651
200	70	10	30	30	55	50	30	26	M12	1131 20 601	1131 20 651
300	86	10	30	34	60	60	18	30	-	1131 30 601	

- Resina fenólica FS 31 DIN 7708, color negro y núcleo de hierro tratado. A la versión "A" puede acoplarse el código 1141, 1136 ó 1137 correspondiente.
- Black Duroplast FS 31 DIN 7708, with treated steel insert. Part numbers 1141, 1136, and 1137 can be screwed into hole in Form "A".
- Duroplast FS 31 DIN 7708, schwarz, Buchse aus behandeltem Stahl. Bei Ausführung "A", können wahlweise die Produkte mit den Artikelnummern 1141, 1136 oder 1137 eingeschraubt werden.
- Duroplast FS 31 DIN 7708, noir, et noyau en acier traité. Les articles 1141, 1136 ou 1137 peuvent être assemblés avec la version "A".
- Duroplasto FS 31 DIN 7708, nero, codolo in acciaio trattato. Gli articoli 1141, 1136, o 1137, possono essere avvitate nel foro della forma "A".

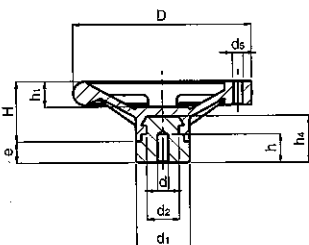
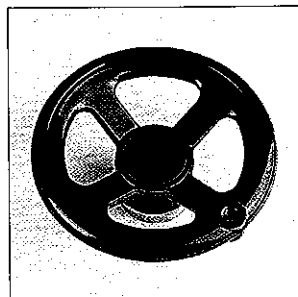

Forma A

1 133

PHENOLIC THREE PRONG KNOB

ART.

D	H	H'	h ₂	h ₃	d	d ₁	d ₂	d ₃	e	Forma H	Forma S
30	17	18	12	14	5,25	11	8	8	6	1133 30 305	1133 30 601
40	22	24,5	14	18	5,25	15	10	11	8	1133 40 305	1133 40 601
50	26	29	17	22	5,25	20	14	15	11	1133 50 305	1133 50 601
60	30	34	21	29	5,25	25	16	19	15	1133 60 305	1133 60 601

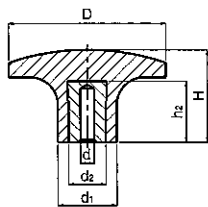
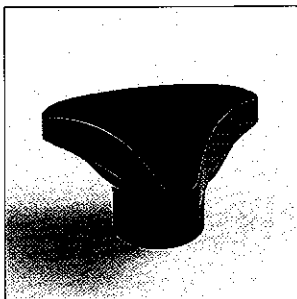

Forma H

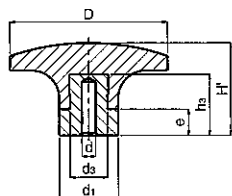
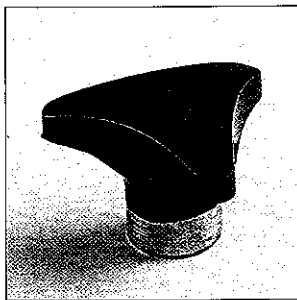

Forma S

Forma H:

- Resina fenólica FS 31 DIN 7708, color negro y casquillo de hierro tratado.
- Black Duroplast FS 31 DIN 7708, with treated steel insert.
- Duroplast FS 31 DIN 7708, schwarz, Buchse aus behandeltem Stahl.
- Duroplast FS 31 DIN 7708, noir, insert acier traité.
- Duroplasto FS 31 DIN 7708, nero, inserto in acciaio trattato.

Forma S:

- Resina fenólica FS 31 DIN 7708, color negro y nucleo de hierro tratado.
- Black Duroplast FS 31 DIN 7708, with treated steel insert.
- Duroplast FS 31 DIN 7708, schwarz, Buchse aus behandeltem Stahl.
- Duroplast FS 31 DIN 7708, noir, noyau acier traité.
- Duroplasto FS 31 DIN 7708, nero, codolo in acciaio trattato.

1 133

PHENOLIC THREE PRONG KNOB

ART.

D	H	d	e	d ₁	Forma T
30	17	M6	25	11	1133 30 501
40	22	M8	33	15	1133 40 511
50	26	M10	33	20	1133 50 525
60	30	M12	40	25	1133 60 525

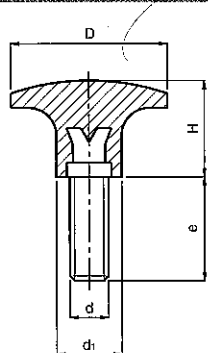
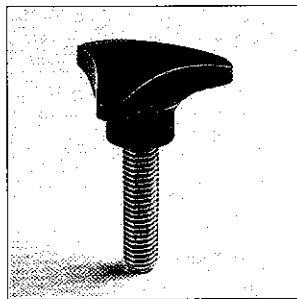

Forma T

Forma T:

- Resina fenólica FS 31 DIN 7708, color negro y espiga de hierro tratado.
- Black Duroplast FS 31 DIN 7708, with treated threaded steel stud.
- Duroplast FS 31 DIN 7708, schwarz, Gewinde aus behandeltem Stahl.
- Duroplast FS 31 DIN 7708, noir, tige acier traité.
- Duroplasto FS 31 DIN 7708, nero, vite in acciaio trattato.

1 136

FIXED AND GIRATORY HANDLES

ART.

d ₁	d ₂	d ₃	e ₁	e ₂	e ₃	e ₄	1136	1137
20	M6	13	45	15	5	12	1136 20 501	1137 20 501
24	M8	16	53	15	5,5	15	1136 24 501	1137 24 501
25	M10	19	76	15	6,5	15	1136 25 501	1137 25 501
28	M12	21	92	15	7	15	1136 28 501	1137 28 501

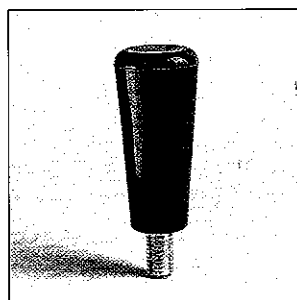

1136

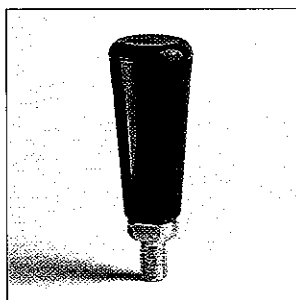

1137

Fija - Fixed
Fest - Fixe - Fisso

Giratoria - Revolving
Drehbar - Tournante - Svolta

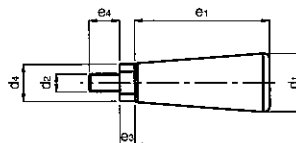

- Resina fenólica FS 31 DIN 7708, color negro y espiga de acero tratado.
- Black Duroplast FS 31 DIN 7708, with treated threaded steel stud.
- Duroplast FS 31 DIN 7708, schwarz, Gewinde aus behandeltem Stahl.
- Duroplast FS 31 DIN 7708, noir, tige acier traité.
- Duroplasto FS 31 DIN 7708, nero, vite in acciaio trattato.

1141 REVOLVING PLAIN HANDLE

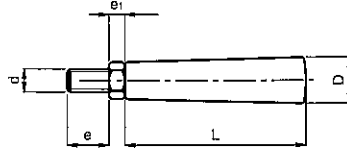
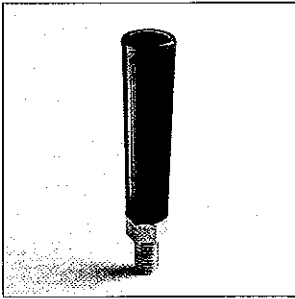

Giratoria - Revolving
Drehbar - Tournante - Svolta

D	L	d	e	e ₁	ART.
15	50	M6	11	5	1141 15 501
17	60	M8	13	6	1141 17 501
20	70	M10	18	7	1141 20 501
23	80	M12	19	8	1141 23 501

- P.P., color negro y espiga de hierro tratado.
- Black P.P., with treated threaded steel stud.
- P.P., schwarz, Gewinde aus behandeltem Stahl.
- P.P., noir, tige acier traité.
- P.P., nero, vite in acciaio trattato.

1144 PHENOLIC TAPERED HAND KNOB

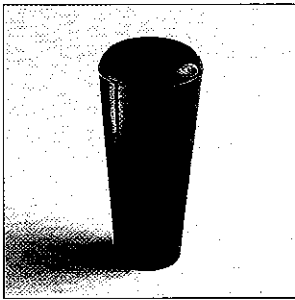

Forma C

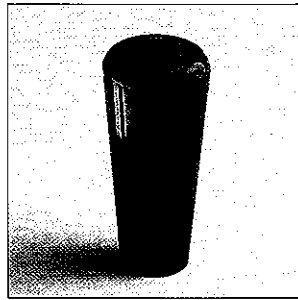

Forma P

D	L	d	d ₂	h	h ₂	d ₁	d ₃	Forma C	Forma P	ART.
10	85	5/32" W	-	10	-	8	-	1144 10 101	-	-
13	30	M5	5	10	23,2	10	8,5	1144 13 101	1144 13 201	-
15	50	-	6	-	40	12	8,8	-	1144 15 201	-
17	60	-	8	-	48	14	10	-	1144 17 201	-
20	45	M6	6	14	37,5	13	9,7	1144 20 101	1144 20 201	-
20	70	-	8	-	56	16	10,8	-	1144 21 201	-
23	80	-	10	-	65	18,5	14	-	1144 23 201	-
24	53	M6	7	14	43	16	11	1144 24 101	1144 24 201	-
25	76	M8	-	18	-	19	-	1144 25 101	-	-
28	92	M10	-	22	-	21	-	1144 28 101	-	-
30	132	M12	-	25	-	23,5	-	1144 30 101	-	-

- Resina fenólica FS 31 DIN 7708, color negro.
- Black Duroplast FS 31 DIN 7708.
- Duroplast FS 31 DIN 7708, schwarz.
- Duroplast FS 31 DIN 7708, noir.
- Duroplasto FS 31 DIN 7708, nero.

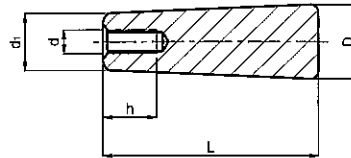

Forma C

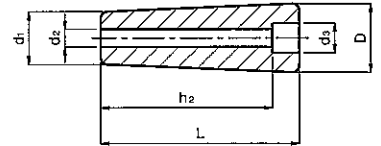

Forma P

1145 BR PHENOLIC HAND KNOB

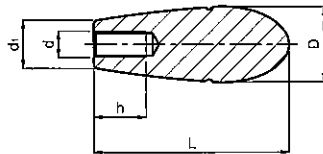
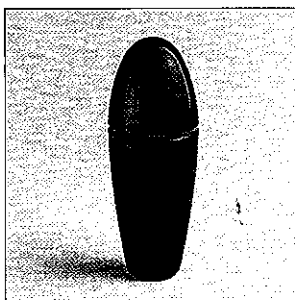

D	L	d	h	d ₁	ART.
35	95	M12	24	20	1145 35 101
35	120	M12	24	20	1145 39 101

- Resina fenólica FS 31 DIN 7708, color negro, rosca directa.
- Black Duroplast FS 31 DIN 7708 molded thread.
- Duroplast FS 31 DIN 7708, schwarz mit sackloch gewinde.
- Duroplast FS 31 DIN 7708 noir, taraudage moulé sur la matière.
- Duroplasto FS 31 DIN 7708 nero con foro filettato.

1153 SOLID PHENOLIC HANDLE

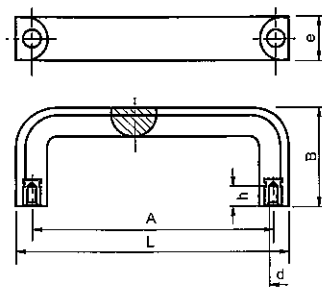
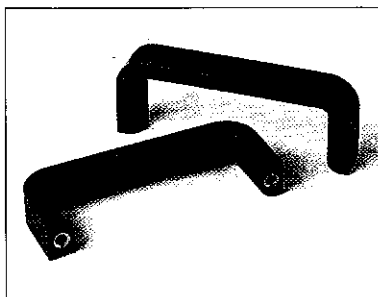

L	A	B	e	d	h	ART.
124	109 ± 0,5	45	21	M6	13	115312 301
148	132 ± 0,5	54	24	M8	13	115314 301

- Resina fenólica FS 31 DIN 7708, color negro y casquillos de latón.
- Black Duroplast FS 31 DIN 7708, with brass female threaded inserts.
- Duroplast FS 31 DIN 7708, schwarz, Gewindebuchsen-Messing.
- Duroplast FS 31 DIN 7708, noir, inserts en laiton.
- Duroplasto FS 31 DIN 7708, nero, inserto in ottone.