

Fin Pitch = 0.300" to match  
easy PCB Layout etc.

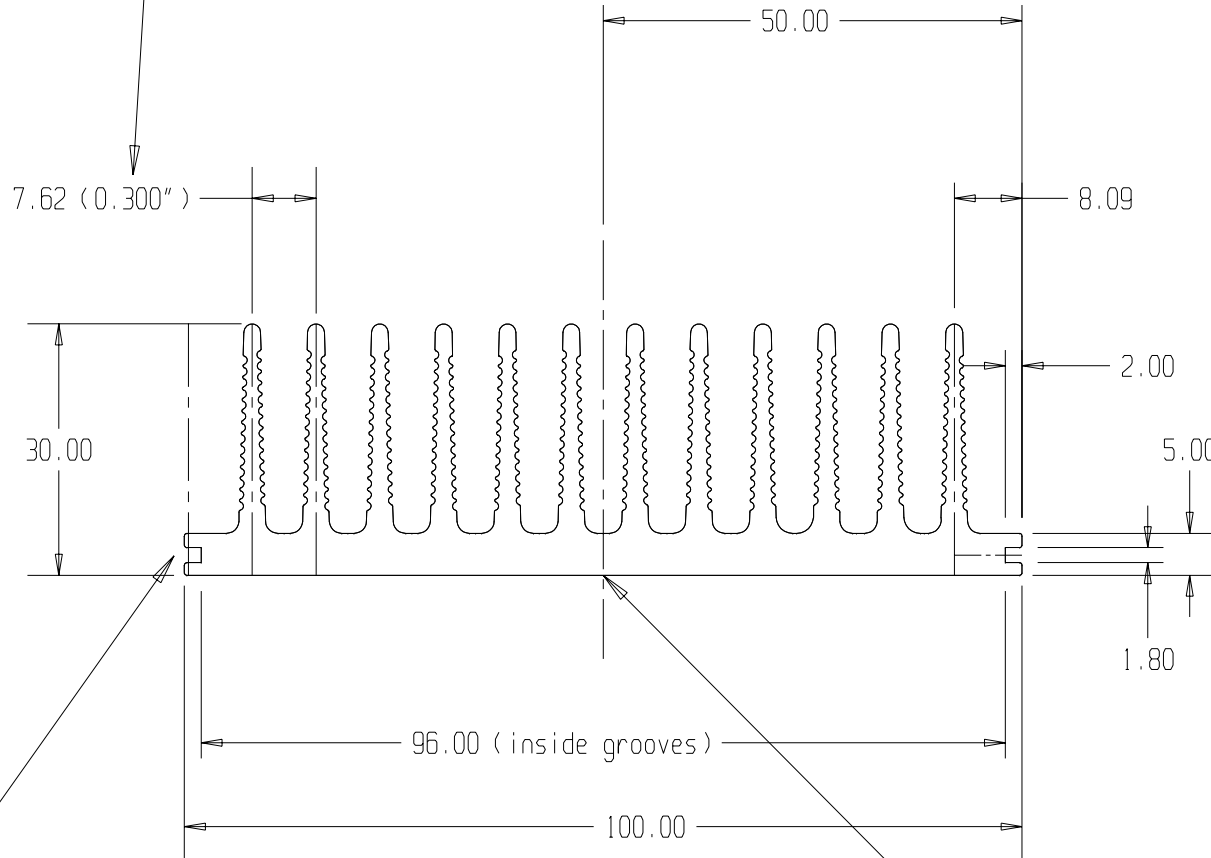

Pattern "HS5984.PTN"

Grooves to match CB10~19 Corner Bars etc.

MATERIAL Extrusion No UA2651
ALLOY 6063-T5
EST. AREA 1144.9 mm
EST. WEIGHT 3.102 kg/m
EST. PERIPHERY EXT: 927 mm TOT: 927 mm
TOLERANCE 0.00mm ±0.1mm 00.0mm ±0.25mm 0000mm ±0.5mm 0-600mm ±0.1mm > 600mm ±0.5mm
BS1474:1987 APPLIES UNLESS OTHERWISE SPECIFIED
JOB No. 26xx

 <b>Modular Systems</b> P.O. BOX 38-828, WELLINGTON, NEW ZEALAND TELEPHONE : (64-4) 9393 777 FACSIMILE : (64-4) 9393 778	CUSTOMER : <b>CASA Modular Systems</b>		SIZE : <b>A4</b>	DRAWING Reference No. : <b>HS-5084</b>	ISSUE : <b>A</b>
	DESCRIPTION : <b>HEATSINK 100x30 Flat Back</b>		© COPYRIGHT : CASA Modular Systems ALL RIGHTS RESERVED		
DRAWN : <b>AWD</b>	DATE : <b>07/02/00</b>	APPROVED : <b>?</b>	DWG. SCALE : <b>1:1</b>		