

Fin Pitch = 0.300" to match
easy PCB Layout etc.

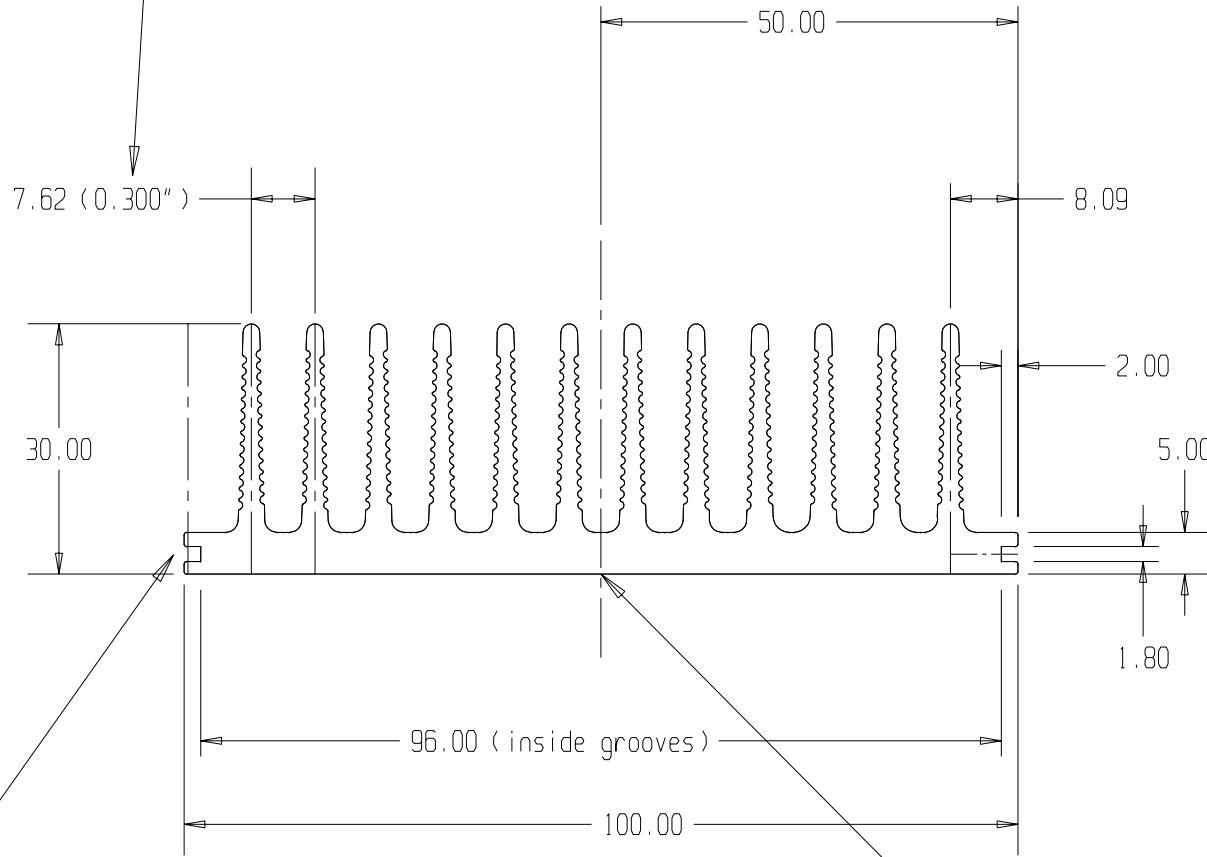

Grooves to match CB10~19 Corner Bars etc.

Pattern "HS5984.PTN"

MATERIAL	Extrusion
No	UA2651
ALLOY	6063-T5
EST. AREA	1144.9 mm
EST. WEIGHT	3.102 kg/m
EST. PERIPHERY	EXT: 927 mm
TOT: 927	mm
TOLERANCE	0.00mm ±0.1mm 00.0mm ±0.25mm 0000mm ±0.5mm 0-600mm ±0.1mm > 600mm ±0.5mm
BS1474:1987	APPLIES UNLESS OTHERWISE SPECIFIED

JOB No.
26xx

	CUSTOMER :	CASA Modular Systems		SIZE	DRAWING Reference No.	ISSUE
	DESCRIPTION :	HEATSINK 100x30 Flat Back		A4	HS-5084	A
P.O. BOX 38-828, WELLINGTON, NEW ZEALAND TELEPHONE : (64-4) 9393 777 FACSIMILE : (64-4) 9393 778	DRAWN :	DATE :	APPROVED :	DWG. SCALE :	© COPYRIGHT : CASA Modular Systems ALL RIGHTS RESERVED	
	A.W.D	07/02/00	?	1:1		