

**Production Procedure:-**

- 1) Laser Cut nested parts from 1.6mm 304 Sheet
- 2) Deburr Plates ready TIG/MIG welding
- 3) Punch "D" hole id not laser cut
- 4) Weld into folded angle stake according to drawing MAS-PEG-SS16.PRT.

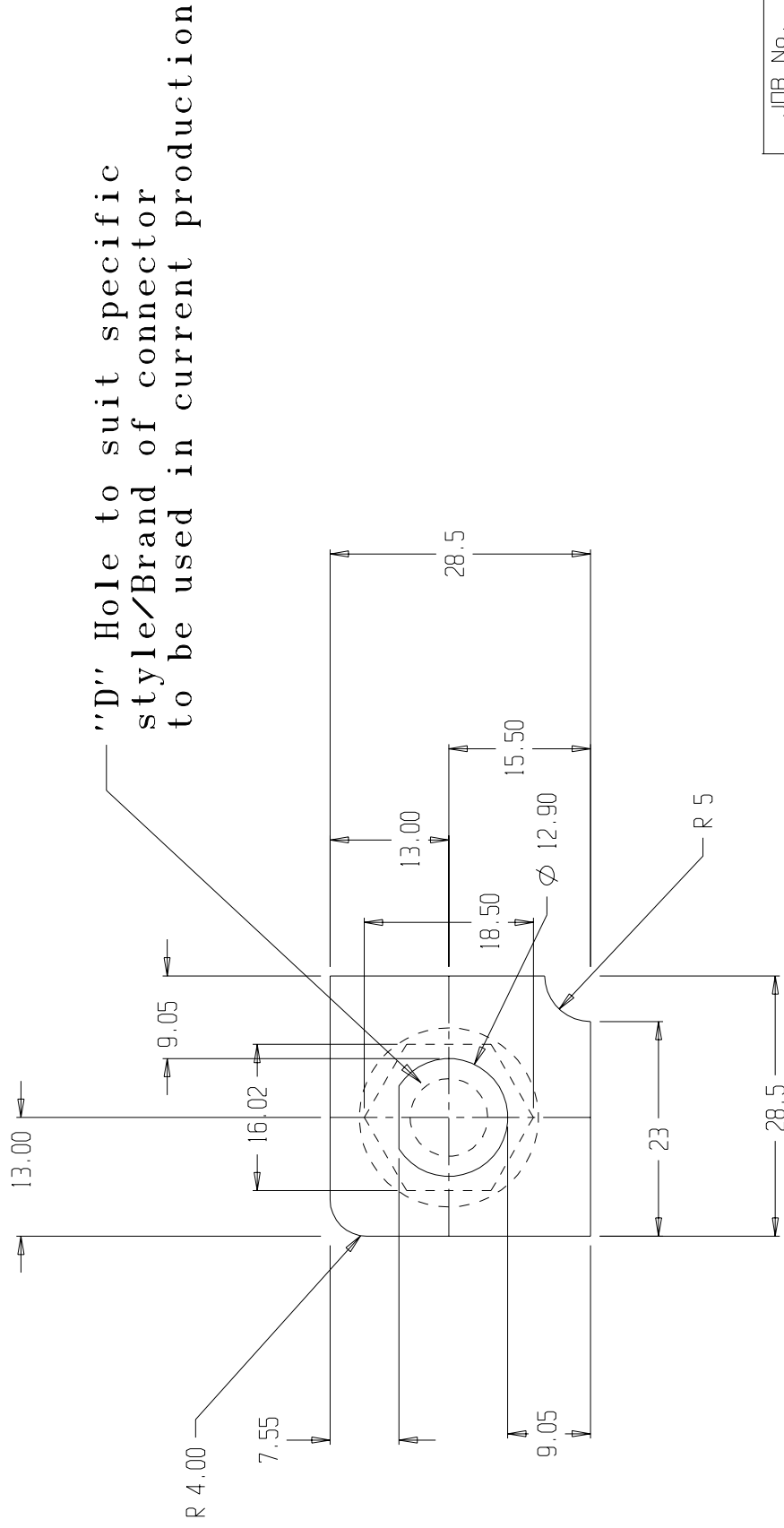

JOB No.  
**2649**

|      |                       |       |
|------|-----------------------|-------|
| SIZE | DRAWING Reference No. | ISSUE |
| A4   | <b>PLT-2649-SS16A</b> |       |

|                                     |                  |
|-------------------------------------|------------------|
| CUSTOMER : CASA Modular Systems     |                  |
| DESCRIPTION : Plate 24BNC for Stake |                  |
| DRAWN : A.W.D                       | DATE : 24/02/03  |
| APPROVED : ?                        | DWG. SCALE : 1:1 |

|  |
|--|
| <b>CASA</b> Modular Systems              |
| P.O. BOX 38-828, WELLINGTON, NEW ZEALAND |
| TELEPHONE : (64-4) 5687 277              |
| FACSIMILE : (64-4) 5685 161              |

© COPYRIGHT : CASA Modular Systems  
ALL RIGHTS RESERVED