

Brand: Minertia or Hathaway (fixing to suit following)

Types: TO3L-DP11; UGJMEE-02; 9928008; etc.

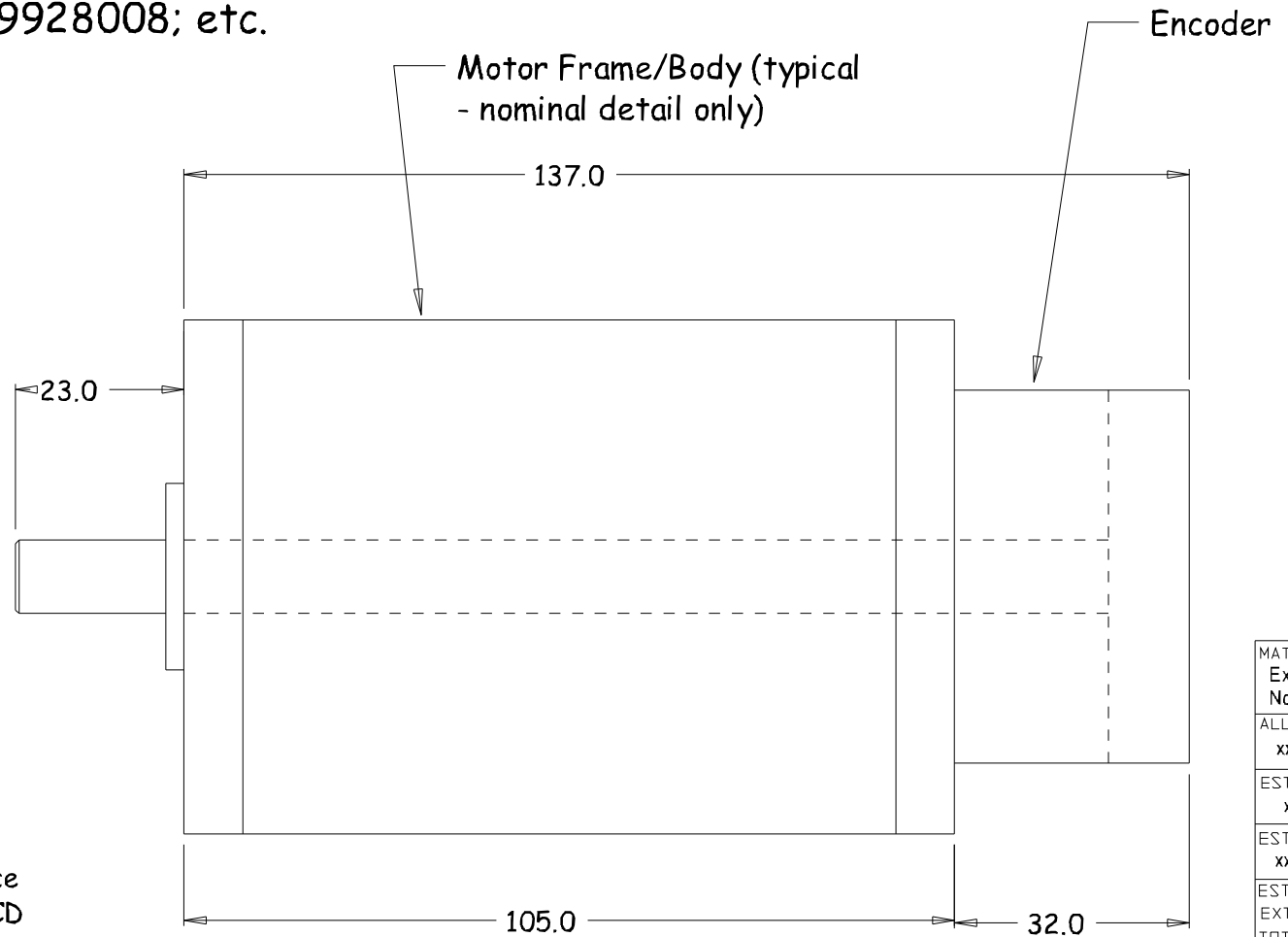
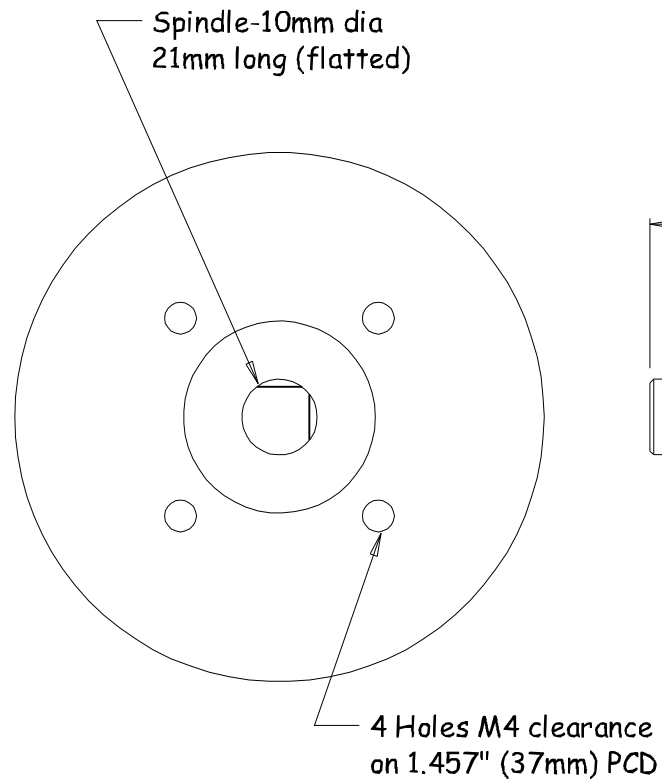

MATERIAL Extrusion No. xxxx
ALLOY xxxx
EST. AREA xxx mm
EST. WEIGHT xxx kg/m
EST. PERIPHERY EXT: xxx mm TOT: xxx mm
TOLERANCE 0.00mm ±0.1mm 00.0mm ±0.25mm 0000mm ±0.5mm 0-600mm ±0.1mm > 600mm ±0.5mm
BS1474:1987 APPLIES UNLESS OTHERWISE SPECIFIED
JOB No. <b>3xxx</b>

Note - Body-outlines vary from make-to-make.

For technical details of motor please refer to:  
<http://www.casa.co.nz/motors/dc/pmdc/encoded/>

<b>CASA</b> Modular Systems P.O. BOX 38-828, WELLINGTON, NEW ZEALAND TELEPHONE : (64-4) 5687 277 FACSIMILE : (64-4) 5685 161	CUSTOMER : <b>CASA Modular Systems</b>				SIZE	DRAWING Reference No.	ISSUE
	DESCRIPTION : <b>Hathaway DC Motor &amp; Fixing Detail</b>				<b>A4</b>	<b>TO3L-PMDC</b>	<b>A</b>
DRAWN : <b>AWD</b>	DATE : <b>21/10/12</b>	APPROVED : <b>?</b>	DWG. SCALE : <b>1:1</b>	© COPYRIGHT : CASA Modular Systems ALL RIGHTS RESERVED			