



Model 715

Specifications				
Model	301	404	715	1225
Nominal Input Voltage	250V	240V	240V	240V
Load Rating	187VA	1.14kVA	4.3kVA	7.2kVA
Output Voltage	Line-voltage connection 0 to 100% of input			
	Over-voltage connection 0 to 115% of input			
Rated Current	0.5A 0.75A*	4.0A	15.0A	25.0A
Maximum Current Line connected	0.75A 1.0A*	4.75A	18.0A	30.0A
No-Load Loss	3W	12W	30W	40W
Approx weight (kg)	1.0	4.4	11.5	23.1
Number of turns	1010	380	258	295

*Higher ratings apply when fitted to heatsink 1.6mm thick x 300mm²

Regavolt 300/400/700/1200 series single units 230/240/250V input

Unit load ratings from 187VA - to 7.2kVA

For general specifications including circuit diagrams please see technical data sheet.

CAUTION:

Regavolts operate at mains voltage and above. Installation, connection and maintenance must be carried out in accordance with good engineering practice by qualified personnel. Open models are intended only for installation as components and must never be used unprotected. Specification on data sheets must be considered carefully and the notes on installation and maintenance and any specific information supplied with the Regavolt adhered to strictly.



CLAUDE LYONS

Claude Lyons Limited
 Brook Road, Waltham Cross,
 Herts. EN8 7LR. UK
 Tel: + 44 1992 768888
 Fax: + 44 1992 788000
 Email: info@claudelyons.co.uk
www.claudelyons.co.uk

301 Dimensions

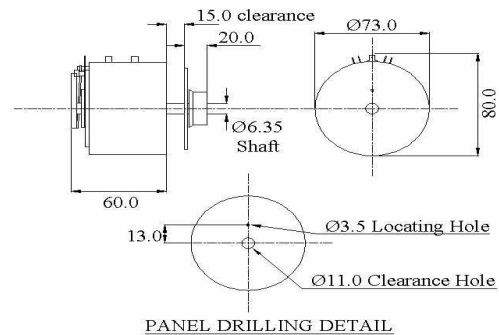

404 Dimensions

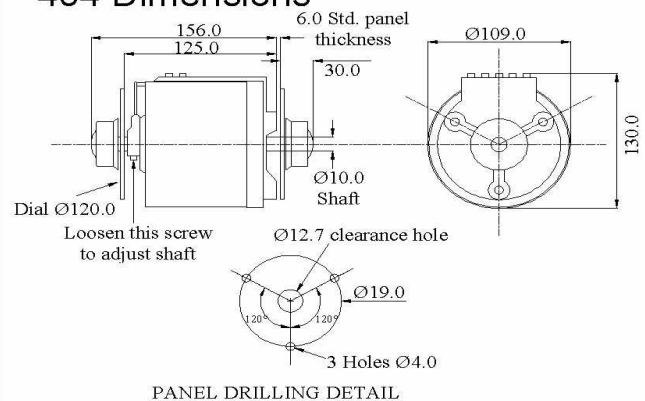

715 Dimensions

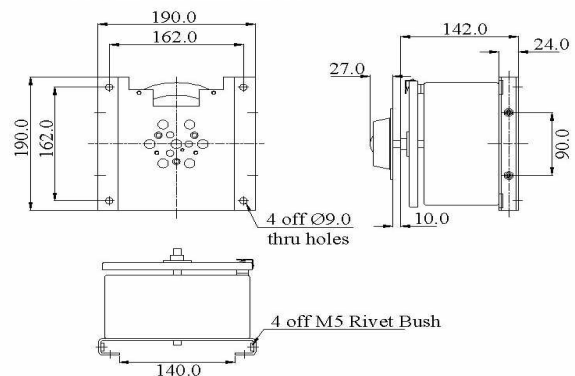

1225 Dimensions

