

Distributed by:

**JAMECO**<sup>®</sup>  
ELECTRONICS

**www.Jameco.com ♦ 1-800-831-4242**

The content and copyrights of the attached  
material are the property of its owner.

Jameco Part Number 526361

LOC	DIST	REVISIONS			
		P	LTR	DATE	DWN
FT	47		F	0G3B-0344-03	29APR03
				TK	GS

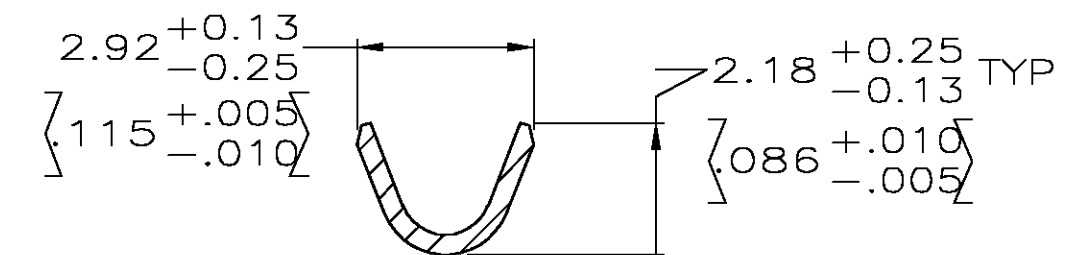
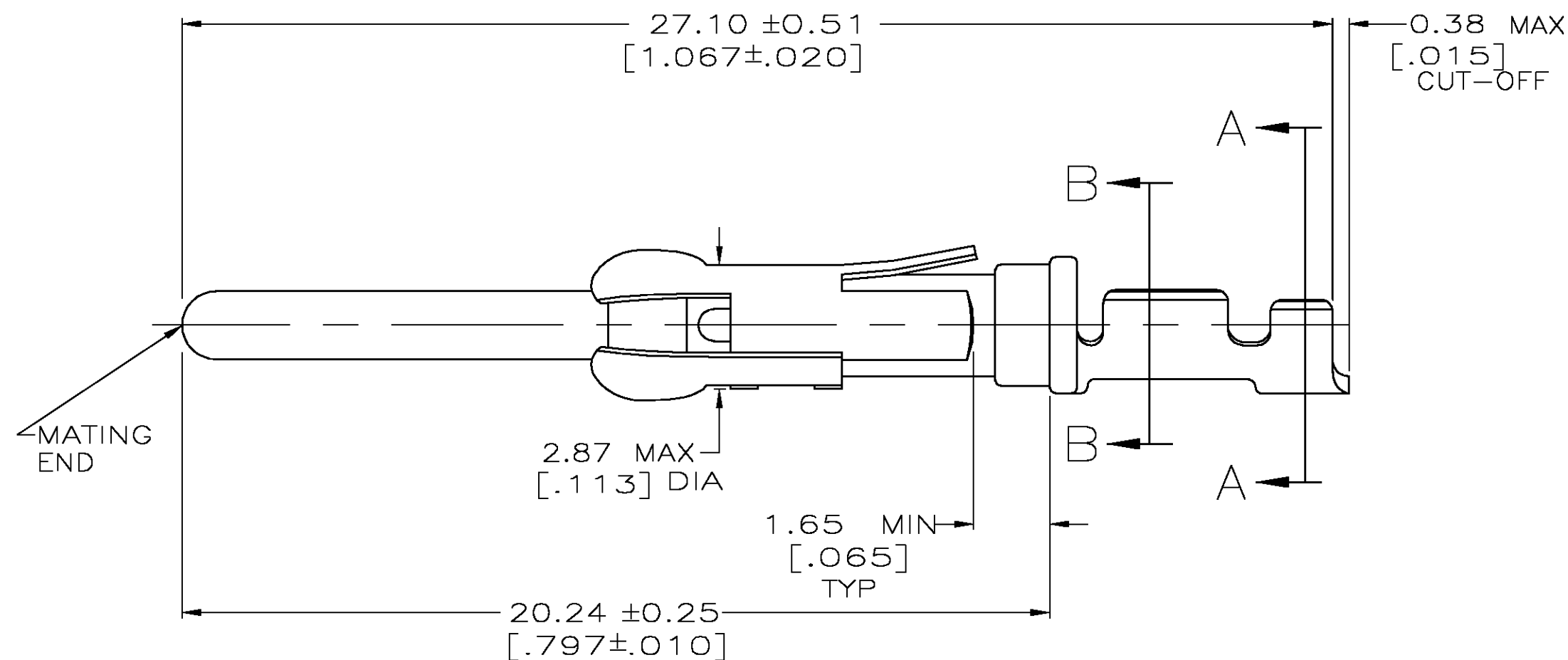
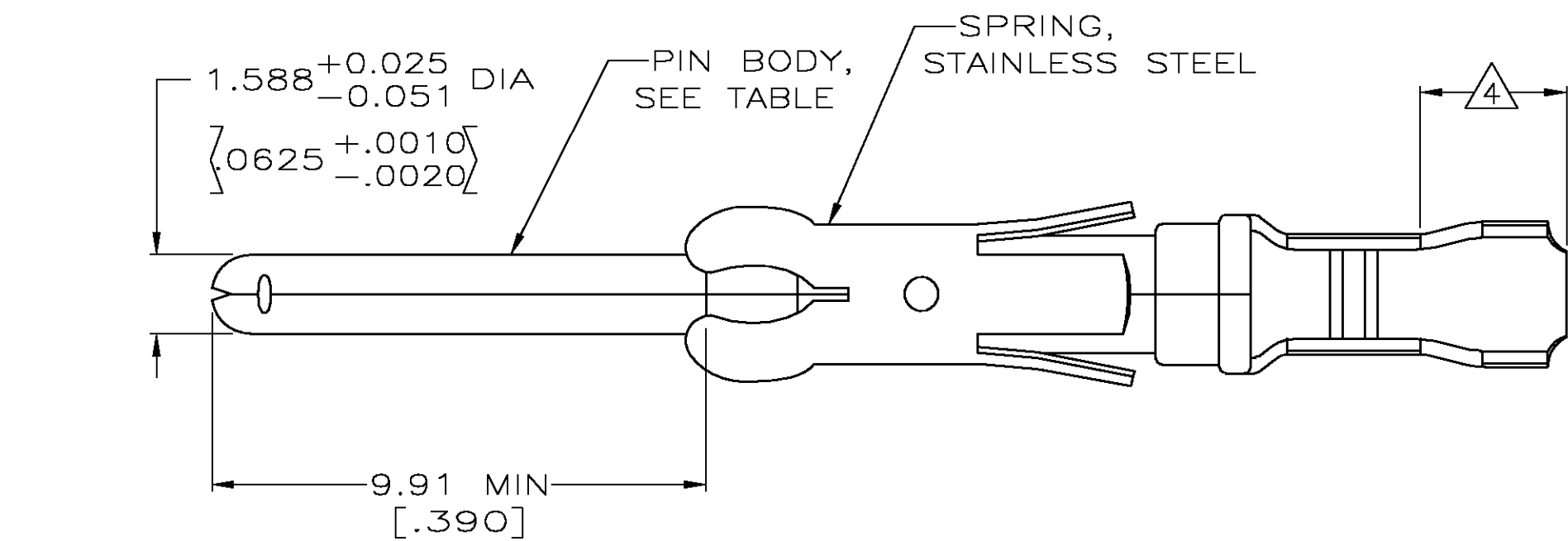

SECTION A-A

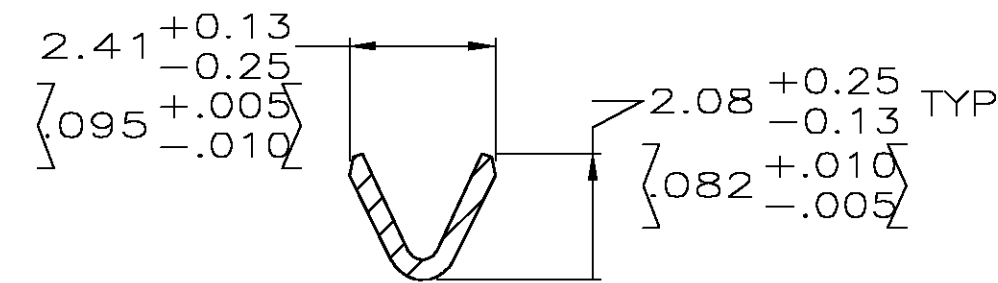

SECTION B-B

1.  $0.76\mu\text{m}$   $[\text{.000030}]$  MIN GOLD PER MIL-G-45204 ON MATING END FOR A LENGTH OF  $5.08$   $[\text{.200}]$  MIN WITH GOLD FLASH ON THE REMAINDER, OVER  $1.27\mu\text{m}$   $[\text{.000050}]$  MIN NICKEL PER QQ-N-290.
2.  $0.76\mu\text{m}$   $[\text{.000030}]$  MIN GOLD PER MIL-G-45204 IN MATING END FOR A LENGTH OF  $5.08$   $[\text{.200}]$  MIN WITH A UNIFORM GRADIENT TO  $0.25\mu\text{m}$   $[\text{.000010}]$  MIN GOLD PER MIL-G-45204 ON THE REMAINDER, OVER  $1.27\mu\text{m}$   $[\text{.000050}]$  MIN NICKEL PER QQ-N-290.
3.  $0.38\mu\text{m}$   $[\text{.000015}]$  MIN GOLD PER MIL-G-45204 ON MATING END FOR A LENGTH OF  $5.08$   $[\text{.200}]$  MIN WITH GOLD FLASH ON THE REMAINDER OVER  $1.27\mu\text{m}$   $[\text{.000050}]$  MIN NICKEL PER QQ-N-290.
4. GOLD PLATING NOT REQUIRED IN THIS AREA.
5.  $1.27\mu\text{m}$   $[\text{.000050}]$  MIN GOLD PER MIL-G-45204 ON MATING END FOR A LENGTH OF  $5.08$   $[\text{.200}]$  MIN WITH GOLD FLASH ON THE REMAINDER OVER  $1.90\mu\text{m}$   $[\text{.000075}]$  MIN NICKEL PER QQ-N-290.
6.  $1.27\mu\text{m}$   $[\text{.000050}]$  MIN TIN-LEAD PER MIL-T-10727 OVER  $1.27\mu\text{m}$   $[\text{.000050}]$  MIN NICKEL PER QQ-N-290.
7. WIRE RANGE 24-20 AWG.
8. INSULATION RANGE  $1.02$   $[\text{.040}]$ - $2.03$   $[\text{.080}]$  DIA.
9.  $0.38\mu\text{m}$   $[\text{.000015}]$  MIN GOLD PER MIL-G-45204 ON MATING END FOR A LENGTH OF  $5.08$   $[\text{.200}]$  MIN,  $1.27\mu\text{m}$   $[\text{.000050}]$  MIN TIN-LEAD PER MIL-T-10727 FOR A LENGTH OF  $5.69$   $[\text{.224}]$  MIN ON OPPOSITE END, BOTH OVER  $1.27\mu\text{m}$   $[\text{.000050}]$  MIN NICKEL PER QQ-N-290 ON ENTIRE CONTACT.
10.  $1.27\mu\text{m}$   $[\text{.000050}]$  MIN TIN PER MIL-T-10727 OVER  $1.27\mu\text{m}$   $[\text{.000050}]$  MIN NICKEL PER QQ-N-290.

	SMALL PACK	$\triangle 10$	BRASS	1-66103-8	1-66103-9
	STANDARD	$\triangle 10$	BRASS	2-66102-5	1-66103-8
	SMALL PACK	$\triangle 1$	BRASS	66102-4	1-66103-7
	SMALL PACK	$\triangle 3$	BRASS	66102-3	1-66103-6
	SMALL PACK	$\triangle 6$	BRASS	66102-2	1-66103-5
	SMALL PACK	$\triangle 2$	BRASS	66102-1	1-66103-4
OBSOLETE	STANDARD	$\triangle 9$	BRASS	2-66102-3	1-66103-3
OBSOLETE	STANDARD	$\triangle 1$	PHOSPHOR BRONZE	2-66102-2	1-66103-2
OBSOLETE	STANDARD	$\triangle 6$	PHOSPHOR BRONZE	2-66102-1	1-66103-1
	STANDARD	$\triangle 1$	BRASS	66102-4	66103-4
	STANDARD	$\triangle 3$	BRASS	66102-3	66103-3
	STANDARD	$\triangle 6$	BRASS	66102-2	66103-2
	STANDARD	$\triangle 2$	BRASS	66102-1	66103-1
	PACKAGING TYPE	BODY FINISH	BODY MATERIAL	STRIP P/N REF	PART NO

THIS DRAWING IS A CONTROLLED DOCUMENT.		DWN L.SIPE 06/01/92	Tyco Electronics Corporation	
DIMENSIONS: INCHES		CHK W.LENKER 6-11-92	City, State, Zip	
TOLERANCES UNLESS OTHERWISE SPECIFIED:		APVD G.STEINHAUER 7-7-92	NAME	
0 PLC $\pm$ -		PRODUCT SPEC	PIN ASSEMBLY, LOOSE PIECE, TYPE III+	
1 PLC $\pm$ -		APPLICATION SPEC	-	
2 PLC $\pm$ 0.13 $[\text{.005}]$		WEIGHT -	SIZE A2	CAGE CODE 00779
3 PLC $\pm$ -		CUSTOMER DRAWING	DRAWING NO C=66103	RESTRICTED TO -
4 PLC $\pm$ -		SCALE 8:1	SHEET 1 OF 1	REV F
ANGLES $\pm$ -				
FINISH				
SEE CALLOUTS				