

Fixed socket

L734/S

flush mounting with zinc-plated brass body

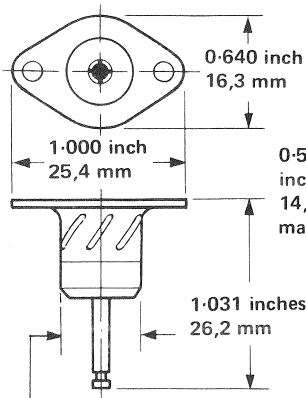
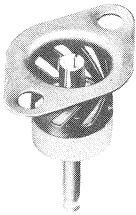

0-428 inch maximum diameter 10,9 mm

L604/S/Zn or Ni
surface mounting with zinc or nickel-plated brass body

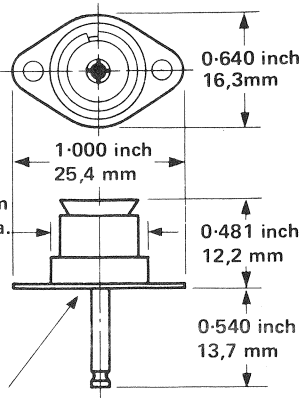
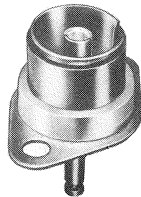

Recommended minimum panel hole diameter 0-468 inch 11,9 mm

L603 coaxial socket, surface mounting, insulated

Colours:

Black, white

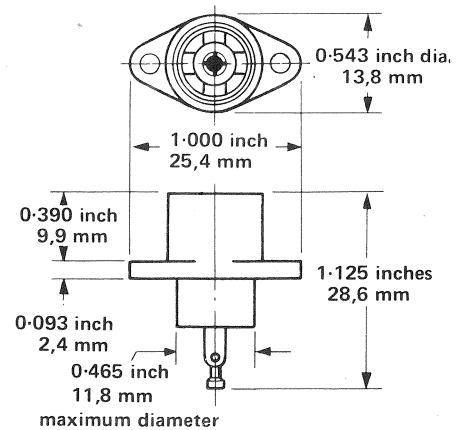

L1421 bulkhead socket with polished aluminium body

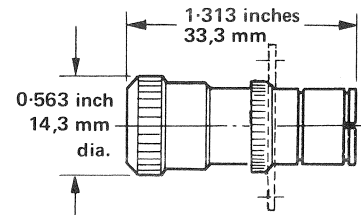
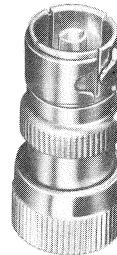

Free socket

L734/J/Al

free socket, with a polished aluminium body.

It is similar to the L1421, but has no flange.

L1366 printed circuit socket, with cadmium-plated brass body

A printed circuit version of L604/S, for 0-062 inch 1,6 mm thick panels. It is recommended that the two outer tags be bent over the rear of the panel before soldering in place as this will assist anchoring during withdrawal of the plug.

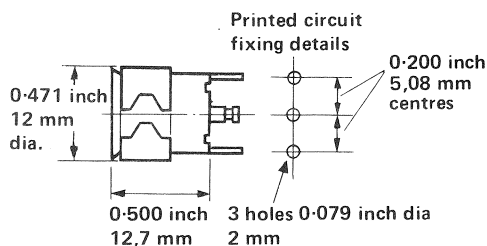

L1666A P.C. coaxial socket

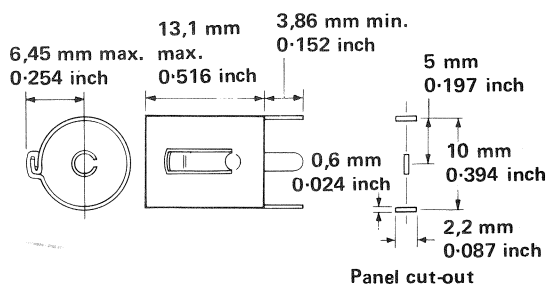

Panel cut-out

A low cost, dual standard * coaxial socket for printed circuit board mounting.

* It accepts free plugs of 9 and 9,5 mm dia.

Panel thickness: Up to 2,38 mm 0-094 inch thick board

Adaptors

These adaptors provide convenient means of joining two leads which are already terminated in standard coaxial plugs.

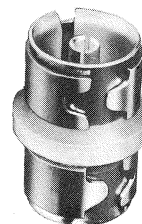

L616
free

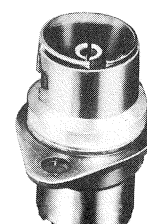
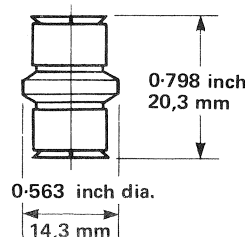

L617
fixed

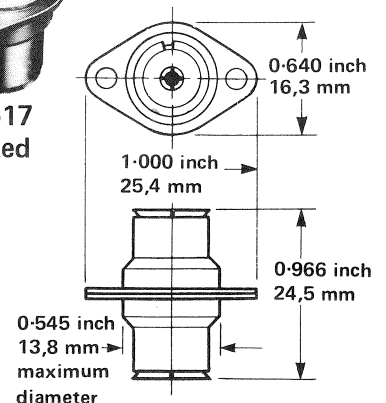

L616/Zn or Ni

Adaptor, plug-to-plug, with zinc or nickel-plated brass body.

L617/Zn or Ni

Adaptor, plug-to-plug, with zinc or nickel-plated brass body.

Panel cut-out — for L603, L604/S, L617, L734/S

To suit method of mounting (see maximum dimension of component)

