

## Fixed socket

### L734/S

flush mounting with zinc-plated brass body

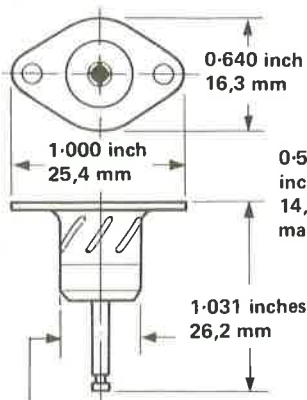

0-428 inch maximum diameter 10,9 mm

**L604/S/Zn or Ni**  
surface mounting with zinc or nickel-plated brass body

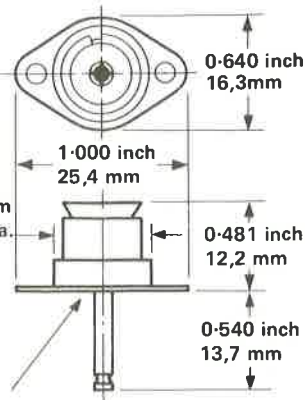

Recommended minimum panel hole diameter 0-468 inch 11,9 mm

## L603 coaxial socket, surface mounting, insulated

Colours:

Black, white

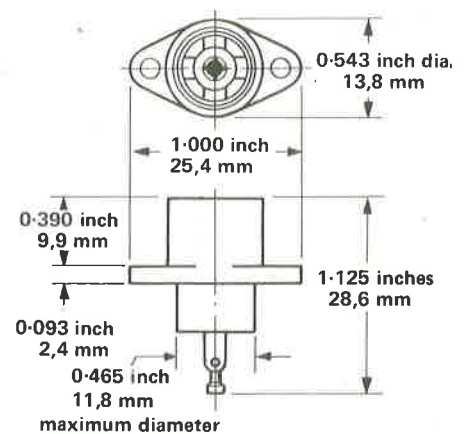

## L1421 bulkhead socket with polished aluminium body

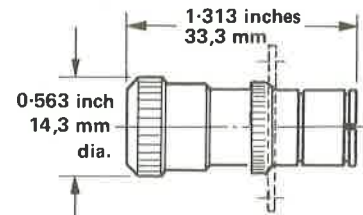

### Free socket

### L734/J/AI

free socket, with a polished aluminium body.

It is similar to the L1421, but has no flange.

## L1366 printed circuit socket, with cadmium-plated brass body

A printed circuit version of L604/S, for 0-062 inch 1,6 mm thick panels. It is recommended that the two outer tags be bent over the rear of the panel before soldering in place as this will assist anchoring during withdrawal of the plug.

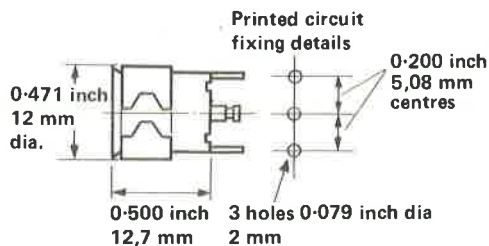

## L1666A P.C. coaxial socket

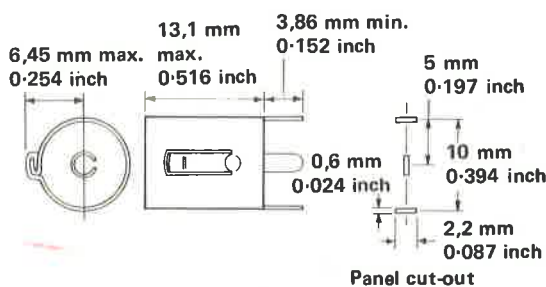

Panel cut-out

A low cost, dual standard \* coaxial socket for printed circuit board mounting.

\* It accepts free plugs of 9 and 9,5 mm dia.

**Panel thickness:** Up to 2,38 mm 0-094 inch thick board

## Adaptors

These adaptors provide convenient means of joining two leads which are already terminated in standard coaxial plugs.



### L616 free



### L616/Zn or Ni

Adaptor, plug-to-plug, with zinc or nickel-plated brass body.



### L617 fixed

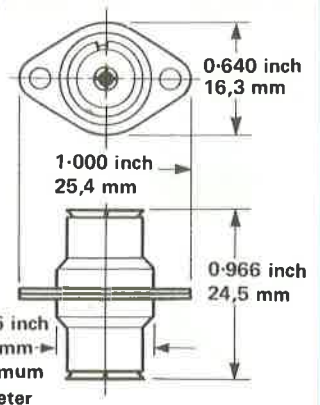

### L617/Zn or Ni

Adaptor, plug-to-plug, with zinc or nickel-plated brass body.

## Panel cut-out — for L603, L604/S, L617, L734/S

To suit method of mounting (see maximum dimension of component)

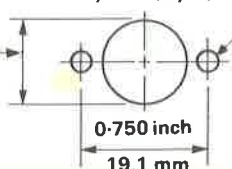

2 Fixing holes 0-125 inch diameter (3,2 mm) to suit 6 B.A. screws