



## STANDARD RANGE PLUGS

### L734/P/AI or Ni

Free plug, with polished aluminium, or nickel-plated brass body

### L1329 Ni

Free plug, with nickel-plated brass body

Split insulated removeable contact for easy soldering or crimping

### L1556

Insulated free plug with black polypropylene body, solder connections

### L1956

Insulated free plug with white polypropylene body, solderless pressure connections.

### L2156

Right angle insulated plug with white polypropylene body, solderless pressure connections.

Originally developed for the television industry, these connectors, due to the technical excellence of their design, were quickly adopted by instrumentation engineers, and several of them have also received approval for use by H.M. Services. Such qualities were achieved at very low cost by mass manufacturing methods.

A selection of sockets is provided in which the mouth is reinforced by a powerful circlip; this imparts great mechanical strength while maintaining a high degree of resilience. A special collet clamp makes an efficient braid connection and anchorage in cable mounting members.

The centre conductor is generally solder connected but, alternatively may be crimped in type L1329, or clamped in type L1956.

**MATING CONFORMS TO BS 3041 : 1958 and IEC 169-2 SPECIFICATIONS**

#### IMPEDANCE:

60 - 70 ohms

#### CAPACITANCE:

≤ 5 pF

#### BREAKDOWN VOLTAGE(d.c.):

≥ 4 kV

#### INSULATION RESISTANCE:

≥ 10<sup>3</sup> megohms

#### CONTACT RESISTANCE:

Inner ≤ 10 milliohms

Outer ≤ 5 milliohms

#### TEMPERATURE RANGE:

- 40 °C to + 70 °C

#### INSERTION/WITHDRAWAL FORCE:

≤ 25 lbf 111 N

#### CABLE SIZE:

Inner 0.048 inch max 1.2mm  
Overall 0.125 inch - 0.312 inch  
3.2 mm - 7.9 mm

#### INSULANTS - INTERNAL:

L604/S, L616, L617, L734/J, L1421  
L734/S, L1329 - Polyethylene  
L603, L734/P, L1366, L1556 -  
L2156 Polypropylene.  
L1956 Acetal and Polypropylene  
L603, L1556, L1956 -  
Polypropylene

#### - EXTERNAL:

Silver-plated

#### CENTRE CONTACT:

#### WEIGHTS (average)

L603	5.1 g	0.18 oz
L604/S	5.3 g	0.19 oz
L616	5.3 g	0.19 oz
L617	9.4 g	0.33 oz
L734/J/A	7.1 g	0.25 oz
L734/P/A	5.1 g	0.18 oz
L734/P/Ni	11.8 g	0.42 oz
L734/S	3.2 g	0.11 oz
L1329/	13.7 g	0.49 oz
L1366	3.4 g	0.12 oz
L1556	4.8 g	0.17 oz
L1956	4.9 g	0.17 oz
L2156	7.1 g	0.25 oz

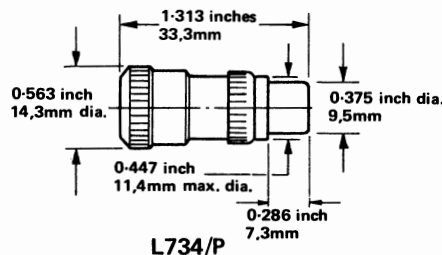

L734/P

#### ASSEMBLY

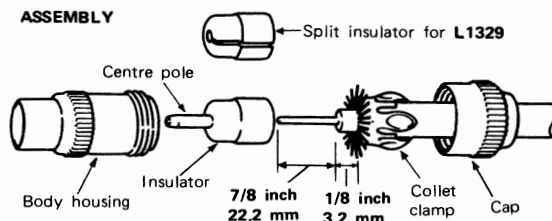

## SOCKETS

**L734/S** Panel socket, flush mounting with cadmium plated brass body.

**L604/S/Cd or Ni** Panel socket, surface mounting with cadmium or nickel-plated brass body

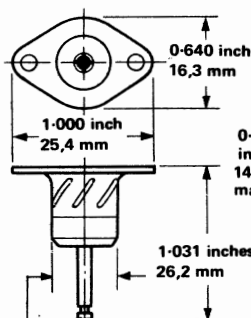

0.428 inch maximum diameter  
10.9 mm

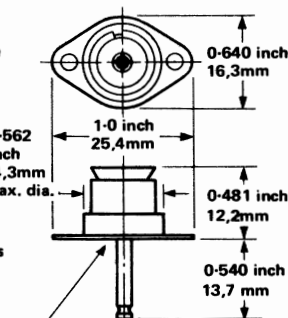

Recommended minimum panel hole  
diameter 0.488 inch 11.9mm

### L1366

Panel socket, printed circuit version, with cadmium-plated brass body

A printed circuit version of L604/S, for 0.062 inch 1.6 mm thick panels. It is recommended that the two outer tags be bent over the rear of the panel before soldering in place as this will assist anchoring during withdrawal of the plug.

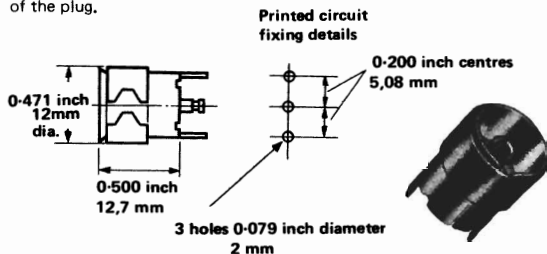



## PLUGS

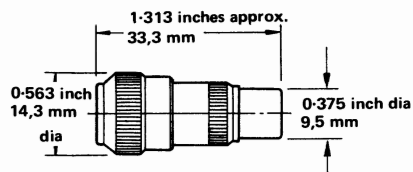

**L1556/Black** Free plug, insulated

**L1956** Free plug, insulated, non-soldering

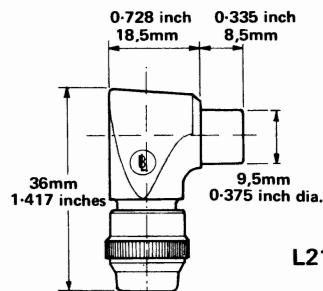

**L2156**



**L734/P**



**L1556/Black**



**L1329/P**



**L1956**

## Split insulator

## FREE SOCKET

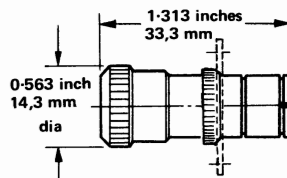

**L734/J/A**  
Free socket, with polished aluminium body

## L1421

Bulhead socket with polished aluminium body.

The 1421 bulkhead socket is similar to L734/J/A but complete with integral flange (shown dotted) for panel mounting.



**L734/J/A1**

## L603/Colour

Panel socket, insulated, surface mounting

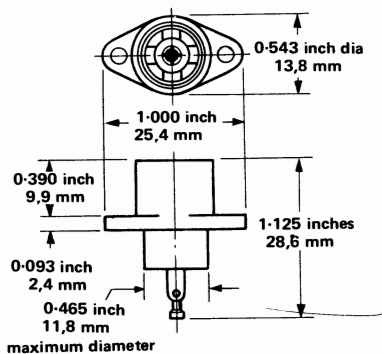

To suit method of mounting (see maximum dimension of component)

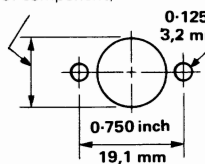

**PANEL CUT-OUT**  
for L603, L604/S  
L617, L734/S

2 Fixing holes  
to suit 6 B.A.  
screws



**L734/S**

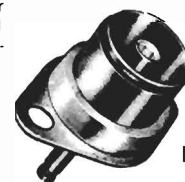

**L604/S**



**L603/Colour**  
Black, green, red, yellow,  
blue, and white

## ADAPTORS

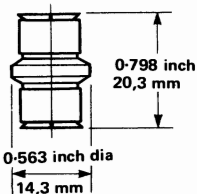

## L616/Cd or Ni

Cable adaptor, plug-to-plug  
with cadmium or nickel-plated  
brass body

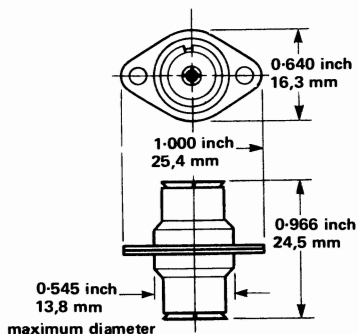

## L617/Cd or Ni

Panel adaptor, plug-to-plug  
with cadmium or nickel-plated  
brass body



**L616**



**L617**

These adaptors provide  
convenient means of joining  
two leads which are already  
terminated in standard  
coaxial plugs.