

Contacts

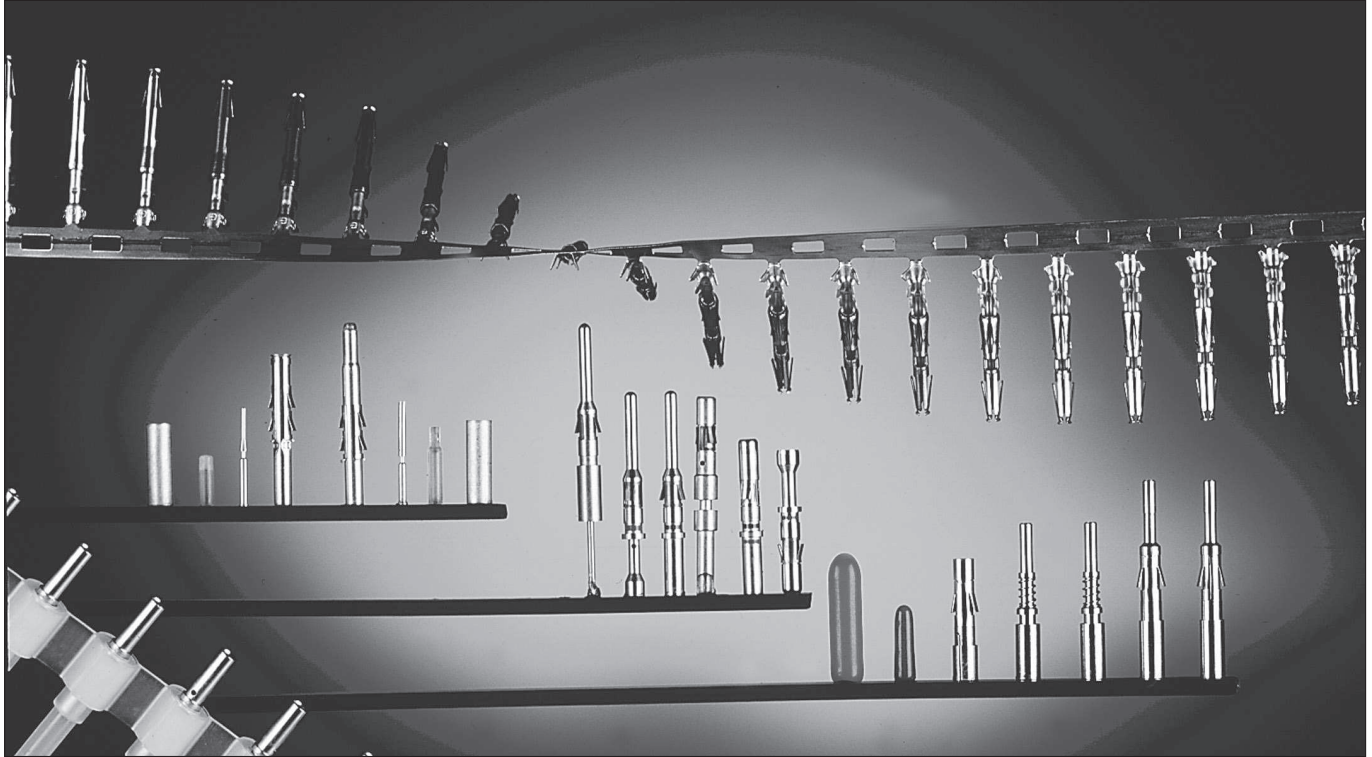

Overview TRIM TRIO contacts



TRIM TRIO contacts are a wide and versatile range that are offered in many options for crimp, coax and fibre optic applications

This section gives an overview on available rectangular connectors for:

1. Size 16 contacts (1.6mm).

- RM/RC – High performance machined contacts.
- SM-M/SC-M – Stamped and formed contacts.
- RMDX/RCDX – Coax Contacts.
- Fibre optic contacts

2. Size 20 contacts (1.0mm).

- RM-W/RC-W – High performance machined contacts.
- SM-W/SC-W – Stamped and formed contacts.

3. 8291 power contacts.

- Size 12 contacts (2.4mm)
- Size 8 contacts (3.6mm)

RM/RC



Size 16 solid machined contacts for TRIM TRIO connectors

Description

Size 16 RM/RC .063" (1.6mm) diameter contacts are precision solid machined crimp snap-in pin and sockets for heavy duty top performance requirements.

Springs on both contacts are made of spring-tempered, heat-treated, beryllium copper.

The socket inner spring supplies high contact pressure to ensure low-resistance contact between pin and socket. The socket contact features closed entry to prevent probe damage. Crimp barrels have insulation grips for vibration support and are provided with a cable stop and inspection hole.

Features and benefits

- Made from high conductive copper alloy with gold or tin over nickel plate finish.
- Heat-treated beryllium copper locking springs assure proper locking and alignment of contacts in the housing.
- Closed entry design on RC socket contact to prevent probe damage.
- Contacts available in bulk packing

Performance characteristics

| | |
|---------------------|--------|
| Current rating: | 13 Amp |
| Contact resistance: | ≤ 3 mΩ |

| | |
|------------------------------|-------------|
| Contact retention in body: | 110 N min. |
| Individual insertion force: | 3.5 N max. |
| Individual withdrawal force: | 0.55 N min. |

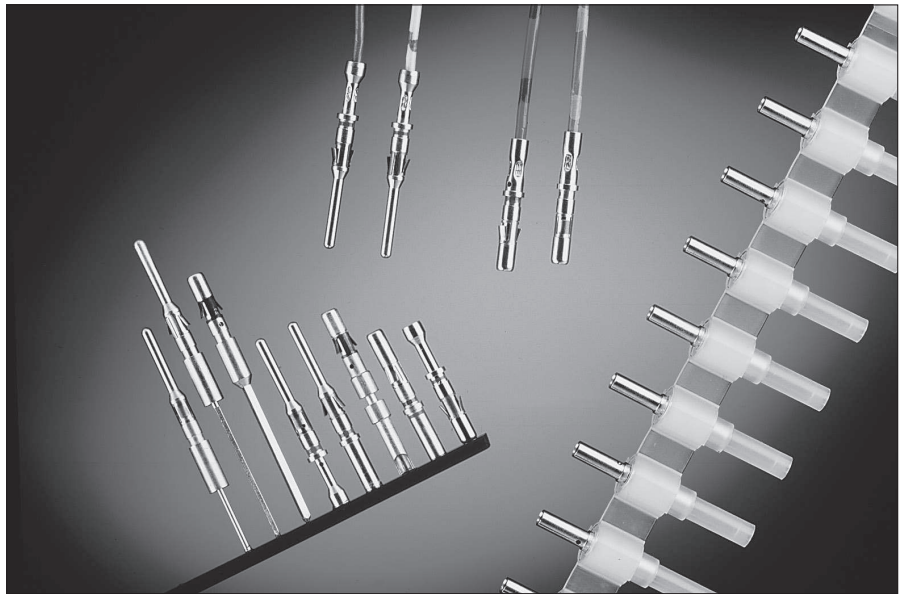

Construction

Contact body: High conductive copper alloy.

Outer spring: Tempered, heat-treated, beryllium copper.

Inner spring socket: Tempered, heat-treated, plated beryllium copper.

Plating table

| | |
|---------------------------|--|
| K (std) | = Min. 0.4 μ Gold all over, over Nickel |
| J | = Gold flash all over, over Nickel |
| N | = Min. 0.75 μ Gold all over, over Nickel |
| T | = 3 - 5 μ Tin all over, over Nickel |
| Other platings on request | |

Connector accommodation

Any TRIM TRIO size 16 contact can be used in any contact position in any connector in the TRIM TRIO size 16 interconnection system.

- MS-M / MSG / MB
- SMS Qikmate
- UTG
- UTP
- UT0
- MBG

How to order

| | (K) RM (K) RC | 16 16 | M M | 23 23 | (GE1) (GE1) | K K | - - |
|----------------------------|--|----------|--------|----------|----------------|--------|--------|
| Contact type: | RM: Male contact bulk packing RC: Female contact bulk packing KRM: Male contact on plastic carrier strip KRC: Female contact on plastic carrier strip | | | | | | |
| AWG Size: | 16, 20, 24, 28 | | | | | | |
| Size 16: | .0625" (1.6mm) Diameter contacts | | | | | | |
| Design variation: | Crimp barrel | | | | | | |
| Grounding contact: | | | | | | | |
| Plating indication: | See plating table | | | | | | |
| Packing quantity: | No digit (std) : 50 pcs. bulk packing (RM/RC) : 2000 pcs on reel (KRM/KRC) 1000 : 1000 pcs bulk packing (RM/RC) | | | | | | |

RM/RC



Standard RM/RC crimp contacts: Contact size 16 - Pin diameter 1.6mm (.063")

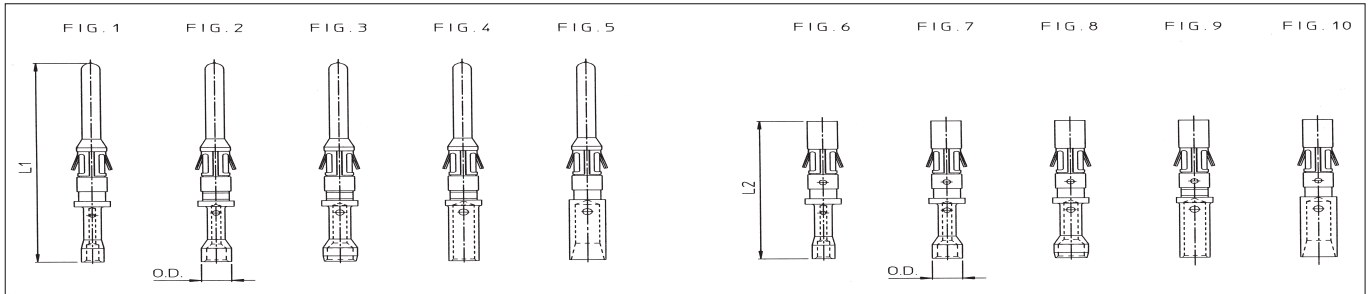

Dimensional table

| Part number | | Wire size | | Max. wire dia. | Max. insul. dia. | Wire strip length | O.D. | L1 | L2 |
|---------------|------|--------------------------|------|----------------|------------------|-------------------|------|------|------|
| Pin contacts | Fig. | Socket contacts Standard | Fig. | AWG | mm ² | | | | |
| RM28M1(*) | 1 | RC28M1(*) | 6 | 30-28 | 0.05-0.08 | 0.55 | 1.1 | 26,2 | 18.2 |
| RM24M9(*) | 2 | RC24M9(*) | 7 | 26-24 | 0.13-0.20 | 0.8 | 1.6 | | |
| RM20M13(*) | 3 | RC20M13(*) | 8 | 22-20 | 0.32-0.52 | 1.18 | 1.8 | | |
| RM20M12(*) | | RC20M12(*) | | | | | 2.2 | | |
| RM16M23(*) | 4 | RC16M23(*) | 9 | 20-16 | 0.52-1.50 | 1.80 | 3.2 | 27,2 | 19.7 |
| RM16M23GE1(*) | | RC16M23GE1(*) | 9 | | | | | | |
| RM14M50(*) | 5 | RC14M50(*) | 10 | 14 | 2,5 | 2,05 | | 26,2 | 18.2 |
| RM14M30(*) | 5 | RC14M30(*) | 10 | 14 | 2,5 | 2,28 | | | |

(*) Plating indication : See plating table

For machined contact reeled on plastic carrier: put "K" in front of part number e.g. KRM16M23K

For grounding contacts (1 mm longer) add "GE1" to the part number (e.g. RM16M23GE1K)

For last make contacts (1 mm shorter) add "GE3" to the part number (e.g. RM16M23GE3K)

Special RM / RC contacts: Contact size 16 - Pin diameter 1.6mm (.063")

| Part number | | Wire size | | Post cross section A | Length out of TRIM TRIO cavity | Anti-rotating bushing part number |
|--------------|------|-----------------|------|----------------------|--------------------------------|-----------------------------------|
| Pin contacts | Fig. | Socket contacts | Fig. | Type | AWG | mm ² |
| RM16SE0(*) | 1 | RC16SE4(*) | 6 | Hand solder | 16 - 20 | 1.50 - 0.52 |
| RM20M12G4(*) | 2 | RC20M12G4(*) | 7 | Mini - wrap | 28 - 30 | 0.08 - 0.05 |

(*) Plating indication : See plating table.

Crimptooling table

| Size | Hand crimp tooling for loose contacts | | | | | | Automatic crimp tooling for contacts on strip | | Extraction tools |
|----------|---------------------------------------|-------------------------------|-----------------|----------------------------|---------------------------------|----------------------------|--|----------------------------------|---|
| | Hand tools die set included | MH860 | | M10S1 | | M8ND | P100MAN (Press) | | |
| | | Positioner (not incl.) | Locator setting | Die set (not incl.) | Stop bushing (not incl.) | Die set (not incl.) | Left side applicator KRM/KRC (not incl.) | Stripper unit (not incl.) | |
| 28-1 | Y16RCM | MH86164G | 4/6 | S9 | SL40 | N24RT10 | -- | Consult Factory | RX2025GE1 or RX2025GE2 or RX16D11D1 |
| 24-9 | | | 5/6 | | | MLSP2763 | | | |
| 20-12/13 | | | 5/7 | S10 | | N20RT30 | MLSP2764 | | |
| 16-23 | | MH86186 | 6/8 | S3D1 | SL39 | N16RT21 | MLSP2765 | | |
| 16-GE1 | or | | SL115 | N16RT25 | | | | | |
| 14-50 | AF8 + TP120 | -- | -- | S3-14 | SL39 | -- | -- | -- | |
| 14-30 | | -- | -- | -- | -- | -- | -- | -- | |

For detailed information on crimp tooling : See crimp tooling section

RM/RC



Nominal length (dim G) of dipsolder contacts out of connector (contacts to be ordered separately)

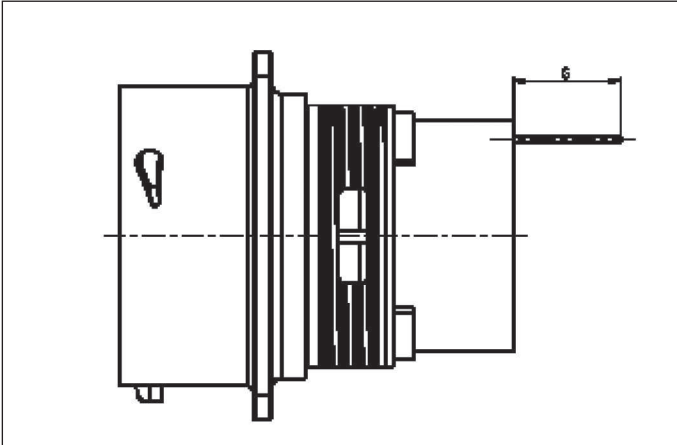

UTP0 / UTG0 wall mounting receptacle connectors

| Connector size | Pin contact RM20M12E8 | RC20M12E8 | Socket contact RC20M12E83 | RC20M12E84 |
|----------------|--------------------------|-----------|------------------------------|------------|
| All sizes | 5.2 | 5.2 | 10.4 | 13.9 |

UT00 wall mounting receptacle connectors

| Connector size | Pin contact RM20M12E8 | RC20M12E8 | Socket contact RC20M12E83 | RC20M12E84 |
|----------------|--------------------------|-----------|------------------------------|------------|
| 10 | 4 | 3.3 | 8.5 | 12.1 |
| 12 | | | | |
| 14 | | | | |
| 16 | | | | |
| 18 | 4 | 1.10 | 7 | 10.6 |
| 20 | | | 6.3 | 9.9 |
| 22 | | | | |
| 24 | | | | |

UT07 jam nut receptacle connectors

| Connector size | Pin contact RM20M12E8 | RC20M12E84 | Socket contact RC20M12E84 | RC20M12E86 |
|----------------|--------------------------|------------|------------------------------|------------|
| 10 | 4.08 | 12.33 | 4.65 | 7.95 |
| 12 | | | 4.65 | 8.65 |
| 14 | | | 5.35 | 7.95 |
| 16 | | | 4.65 | 7.95 |
| 18 | | | 4.65 | 7.95 |
| 20 | – | 8.01 | – | 4.21 |
| 22 | | | | 3.51 |
| 24 | | 6.5 | | 2.1 |

For recommended PC-Board hole lay out: Consult factory

RM/RC



The RM/RC contact principle

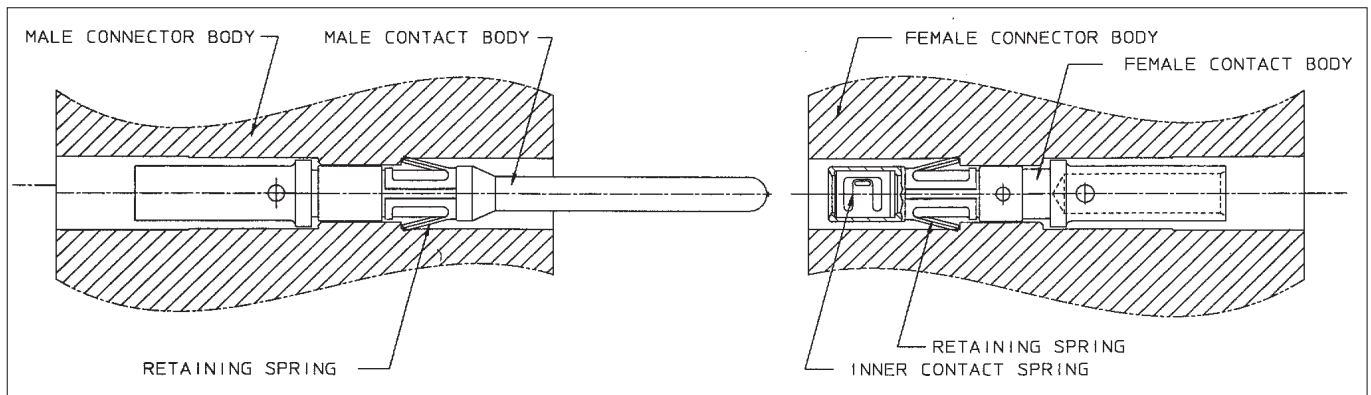

The RM/RC contact packing



50 pcs bulk packing (standard)



1000 pcs bulk packing

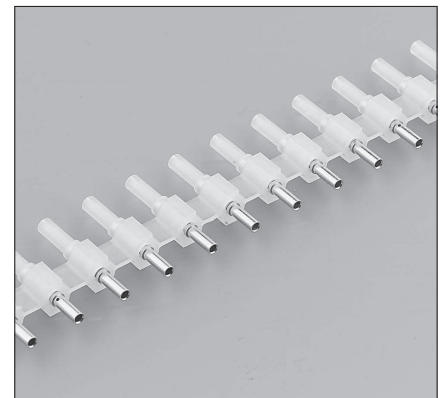

Reeled contacts on plastic carrier (qty 2000 pcs)

SM/SC-M



Size 16 stamped and formed contacts for TRIM TRIO connectors

Description

Size 16 SM/SC .063" (1.6mm) diameter contacts are two piece strip formed crimp snap-in pin and sockets.

These contacts consist of a crimp body made of high conductive copper alloy, and a stainless steel retaining spring featuring retention in the housing cavity and a closed entry socket to prevent probe damage.

The contact with its open barrel is standard available on strip and packaged with 3000 pcs on reel. This reel packaging combined with semi or even full automatic crimp tooling provides the added advantage of a lower installed cost.

Features and benefits

- Made from high conductive copper alloy with gold or tin over nickel plate finish.
- Two piece construction with dual purpose spring which serves for contact retention and protects the body against damage.
- Contacts available on reel (standard) and in bulk packing (100 pcs).
- Suitable for high volumes and lower installation cost.

Performance characteristics

| | |
|------------------------------|-------------|
| Current rating: | 13 Amp |
| Contact resistance: | ≤ 6 mΩ |
| Contact retention in body: | 65 N min. |
| Individual insertion force: | 3.5 N max. |
| Individual withdrawal force: | 0.55 N min. |

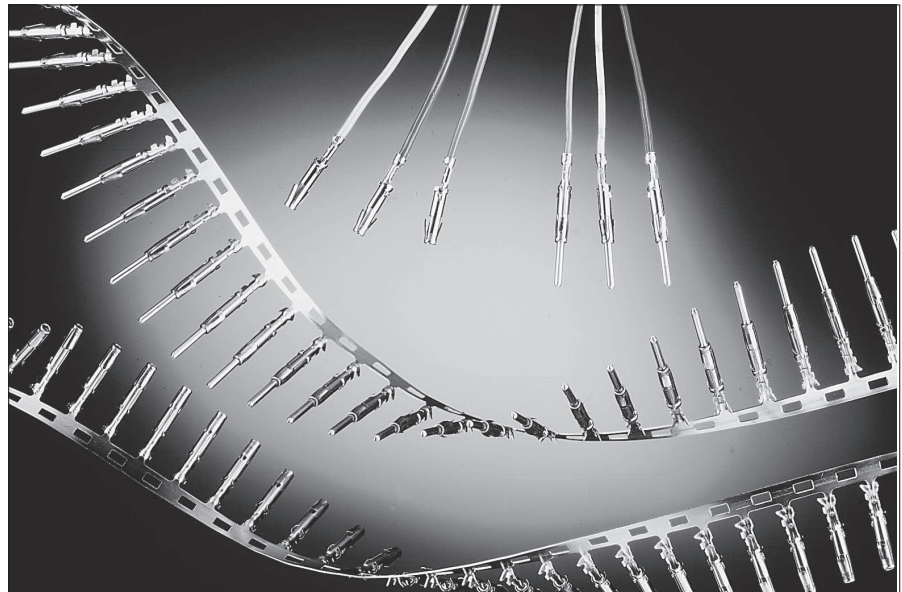

Construction

Contact body: High conductive copper alloy.

Outer spring: Stainless steel

Plating table

S6 = 0.75m Gold min. in contact area, flash on crimp barrel over Nickel.

D70 = Gold flash all over, over Nickel.

TK6 = Preplated Tin all over.

Connector accommodation

Any TRIM TRIO size 16 contact can be used in any contact position in any connector in the TRIM TRIO size 16 interconnection system.

- MS-M / MSG / MB
- SMS Qikmate
- UTG
- UTP
- UT0
- MBG

Note:

Reeled contacts are for applicator with left side feeding.

How to order

| | SM SC | 16 16 | M M | (L) (L) | 1 1 | S6 S6 |
|------------------------------|---|----------|--------|------------|--------|----------|
| Contact type: | SM: Male contact SC: Female contact | | | | | |
| AWG Size: | 14, 16, 20, 24 | | | | | |
| Type of crimp barrel: | American open crimp barrel | | | | | |
| Packing: | No digit: Contacts on strip (qty 3000 per reel) L: Preformed loose piece contacts | | | | | |
| Design variation | 1 : Only wire crimp for size 14 and 16 : Wire + insulation crimp for sizes 20 and 24 11 : Wire + insulation crimp for size 16 | | | | | |
| Plating indication: | See plating table | | | | | |

SM/SC-M



Standard SM/SC crimp contacts: Contact size 16 - Pin diameter 1.6mm (.063")

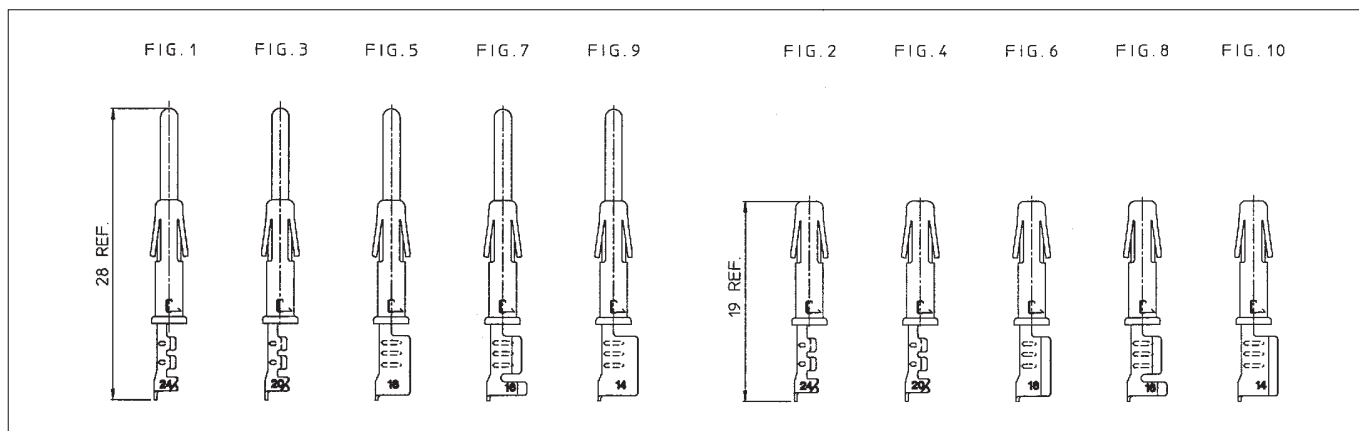

Dimensional table

| Part number: contacts on strip Loose pieces | | | | Wire size | | Insulation diameter | Wire strip length |
|--|------|-------------------------|------|-----------|-----------------|------------------------|----------------------|
| Pin contacts | Fig. | Socket contacts | Fig. | AWG | mm ² | | |
| SM24M1S6 SM24ML1S6 | 1 | SC24M1S6 SC24ML1S6 | 2 | 26 - 24 | 0.13 - 0.25 | 0.89 - 1.58 | 4.0 |
| SM20M1S6 SM20ML1S6 | 3 | SC20M1S6 SC20ML1S6 | 4 | 22 - 20 | 0.35 - 0.50 | 1.17 - 2.08 | 4.0 |
| SM16M1S6 SM16ML1S6 | 5 | SC16M1S6 SC16ML1S6 | 6 | 18 - 16 | 0.80 - 1.50 | 2.0 - 3.0 | 4.65 |
| SM16M11S6 SM16ML11S6 | 7 | SC16M11S6 SC16ML11S6 | 8 | 18 - 16 | 0.80 - 1.50 | 3.0 | 6.35 |
| SM14M1S6 SM14ML1S6 | 9 | SC14M1S6 SC14ML1S6 | 10 | 14 | 2.0 - 2.5 | 3.2 | 6.35 |

For other platings: See plating table.

Crimptooling table

| Size | Hand crimp tooling for loose contacts | | Automatic crimp tooling for contacts on strip | | Extraction tooling |
|----------|--|-----------------------------------|---|---|---|
| | Hand tools die set included | M8ND Die set (not included) | P100 MAN Mini Applicator (not included) | K750 ASC (Stripper - crimper) Mini Applicator (not included) | |
| 24 | Y16SCM2 (ratchet) | N24RT11 | MLS0318B | MLS24M1 | RX2025GE1 or RX2025GE2 or RX16D11D1 |
| 20 | Y14SCM2 (not ratchet) Y14MTV (ratchet) | N20RT29 | MLS0555A | MLS20M1 | |
| 16M(L)11 | Y16SCM2 (ratchet) Y14SCM2 (not ratchet) | N16RT26 | MLS0356A | MLS16M11 | |
| 16M(L)1 | Y14SCM (ratchet) Y14MTV (ratchet) | N16RT24 | MLS1579 | MLS16M1 | |
| 14 | Y14SCM (ratchet) Y14MTV (ratchet) | N14RT13 | MLS1047 | MLS14M1 | |

For detailed information on crimp tooling : See crimp tooling section

RMDX/RCDX



Size 16 MULTIPIECE COAXIAL contacts for TRIM TRIO connectors

Description

Size 16 RMDX/RCDX Monocrimp .0625" (1.6mm) diameter contacts are one-piece monocrimp subminiature coaxial contacts to cover a wide range of subminiature coaxial and twisted pair cables. They provide cost effective solutions in applications where a mix of signal, power and coaxial cable terminations for low frequency, shielded signal and high frequency applications are needed. Monocrimp one piece coaxial contacts offer high reliability plus the economic advantage of a 95% reduction in installation time over conventional assembly methods currently in use.

Features and benefits

- The monocrimp one-piece coaxial contacts offer high reliability plus the economic advantage of a 95% reduction in installation time over conventional assembly methods.
- This economy is achieved by simultaneously crimping of both the inner and outer conductor

Performance characteristics

| | |
|--|------------------|
| Operating voltage between inner / outer contact: | 230 VDC |
| Test potential between inner / outer contact | 450 VAC 1 min. |
| Operating temperature: | -55°C to + 125°C |
| Contact retention in body: | 65 N min. |
| Contact voltage drop at 1A: | 30m V max. |
| Isolation at 30 MHz: | 140 db. |

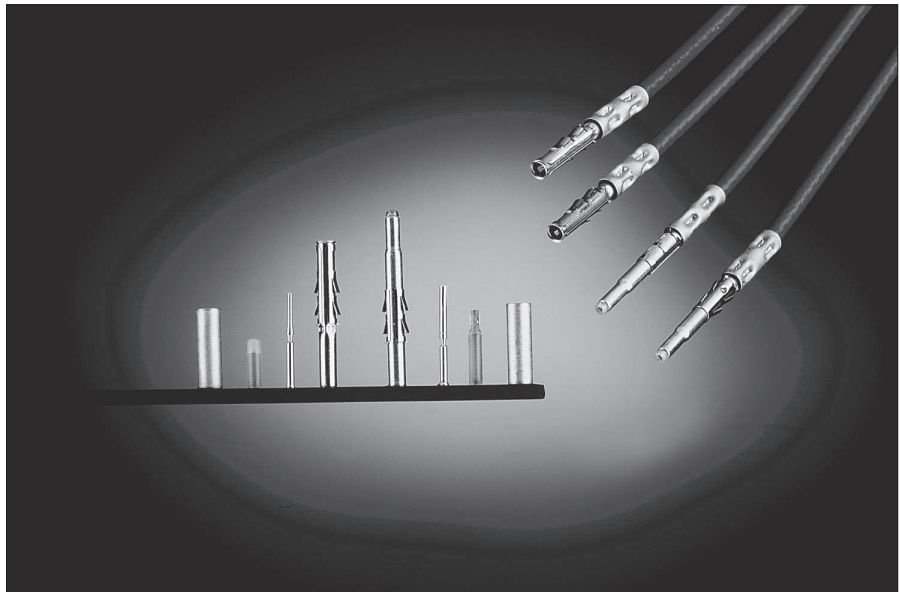

Construction

Inner and outer contacts: High conductive copper alloy

Retaining spring: beryllium copper

Insulating bushing: Polyamide 6.6

Plating table

Retaining spring: Nickel plated

Inner and outer contacts:
D28: 0.75 µ Gold min. over Nickel

Connector accommodation

Any TRIM TRIO size 16 contact can be used in any contact position in any connector in the TRIM TRIO size 16 interconnection system.

- MS-M / MSG / MB
- SMS Qikmate
- UTG
- UTP
- UT0
- MBG

How to order

| | RMDX RCDX | K10 K1 | D28 D28 |
|-----------------------------------|--|-----------|------------|
| Contact type: | RMDX = Male subminiature coax. RCDX = Female subminiature coax. | | |
| Monocrimp design variation | | | |
| Plating indication | | | |

RMDX/RCDX



MONOCRIMP Subminiature coax

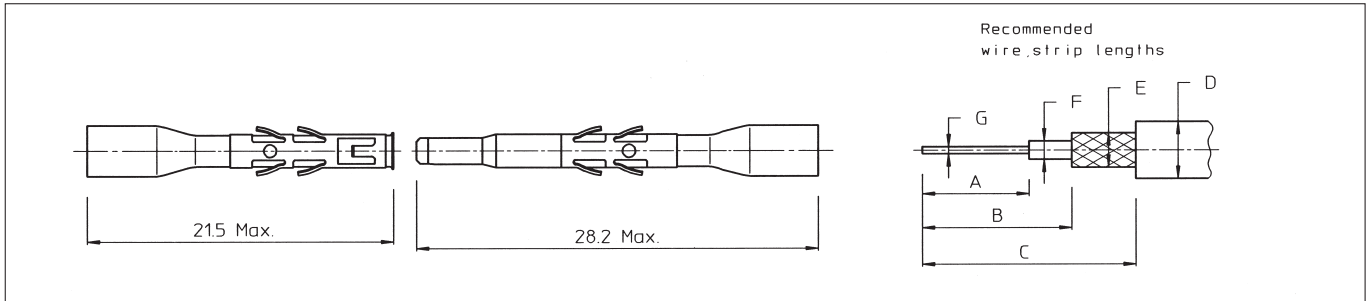

| Part number | AWG inner conduct. | Cable type | Coax dimensions | | | | Coax strip lengths | | | Crimp tool M10S1 | | Extraction tool |
|-------------|--------------------|------------|-----------------|------|------|------|--------------------|------|------|-------------------|------------------------|------------------------------|
| Male | Female | | D max | E | F | G | A | B | C | Die set not incl. | stop bushing not incl. | |
| RMDX6050D28 | | - | 2.64 | 2.11 | 1.70 | 0.30 | 5.1 | 6.35 | 8.9 | S80 | SL105 | RX2025GE1 OR RX16D11D1 |
| RCDX6050D28 | 30 | - | 2.29 | 1.63 | 1.22 | | 4.2 | | 8.5 | S87 | | |
| RMDX6050D28 | | - | 2.90 | 2.29 | 1.91 | 0.38 | | | 11.7 | S80 | | |
| RCDX6050D28 | 28 | - | 2.90 | 2.29 | 1.91 | 0.38 | | | 11.7 | S80 | | |
| RMDX6032D28 | | - | 1.78 | 1.37 | 0.97 | 0.48 | | | | S82 | | |
| RCDX6032D28 | | - | 1.78 | 1.37 | 0.97 | 0.48 | | 5.1 | | S82 | SL105 | RX2025GE1 OR RX16D11D1 |
| RMDX6024D28 | | - | 1.78 | 1.37 | 0.97 | 0.48 | | | | S82 | | |
| RCDX6024D28 | | - | 1.78 | 1.37 | 0.97 | 0.48 | | | | S82 | | |
| RMDX6032D28 | | RG174/U | 2.92 | 2.24 | 1.52 | 0.48 | | | | S80 | | |
| RCDX6032D28 | | RG174/U | 2.92 | 2.24 | 1.52 | 0.48 | | | | S80 | | |
| RMDX6026D28 | | - | 3.05 | 2.44 | 1.96 | 0.41 | | 5.1 | | S82 | SL105 | RX2025GE1 OR RX16D11D1 |
| RCDX6026D28 | | - | 3.05 | 2.44 | 1.96 | 0.41 | | | | S82 | | |
| RMDX6036D28 | | RG188A/U | 2.79 | | | 0.51 | | | 11.7 | S80 | | |
| RCDX6036D28 | | RG188A/U | 2.79 | | | 0.51 | | | 11.7 | S80 | | |
| RMDX6036D28 | | RG316/U | 2.72 | 1.98 | 1.52 | | | | | S80 | | |
| RCDX6036D28 | | RG316/U | 2.72 | 1.98 | 1.52 | | | | | S80 | | |

* M10SG8 consists of die set, stop bushing and M10S1 tool

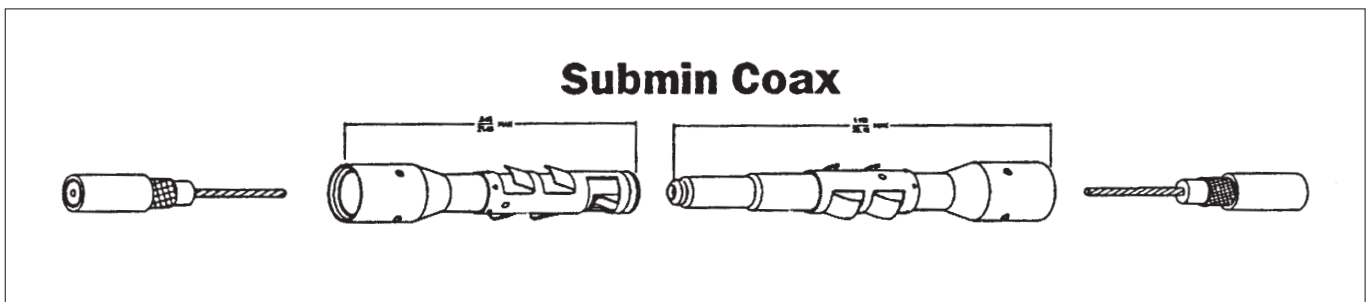



MONOCRIMP Twisted pair

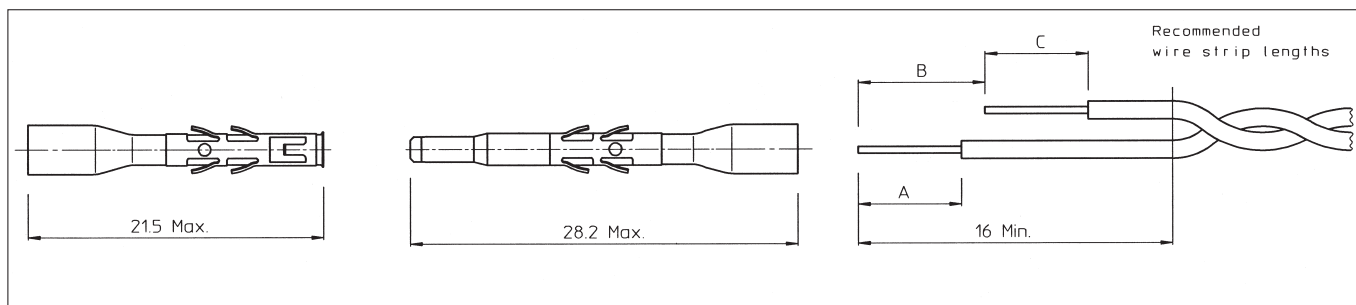

| Part number | | AWG inner conduct. | Dia. outer jacket (single wire) | Cable strip lengths | | | Crimp tool M10S1 | | Extraction tool |
|--------------------|--------|--------------------|---------------------------------|---------------------|-----|-----|----------------------|-------------------------|------------------------------|
| Male | Female | | | A | B | C | Die set not incl. | Stop bushing not. incl. | |
| RMDX6019D28 | | 26 (19 x 0.10) | 1.25 | 4.7 | 6.0 | 4.0 | M10SG8* Crimping kit | | RX2025GE1 or RX16D11D1 |
| RCDX6019D28 | | 24 (7 x 0.20) | 1.25 | | | | | | |
| | | 24 (19 x 0.13) | 1.45 | | | | | | |
| RMDX6031D28 | | 26 (7 x 0.16) | 0.70 | | | | S80 | SL105 | |
| RCDX6031D28 | | | | | | | | | |

* M10SG8 consist of die set, stop bushing and M10S1 tool.

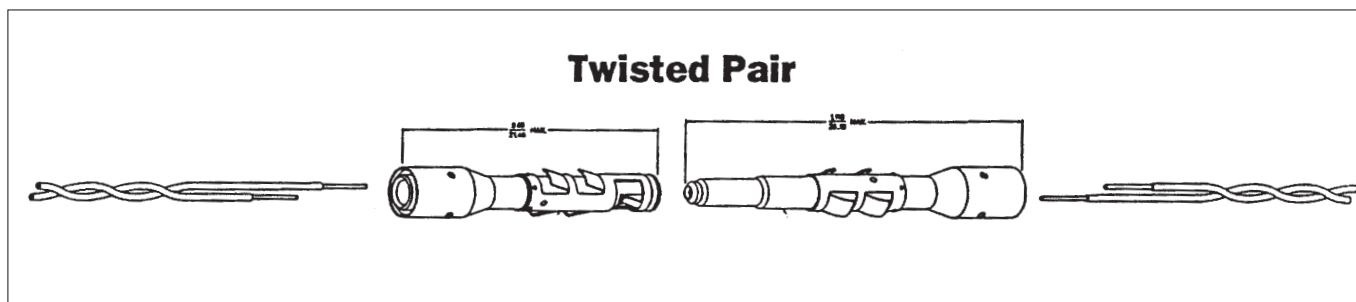

RMDX/RCDX



Size 16 monocrimp COAXIAL contacts for TRIM TRIO connectors

Description

Size 16 RMDX/RCDX Multipiece
.0625" (1.6mm) diameter contacts are subminiature coaxial contacts to cover a wide range of subminiature coaxial and twisted pair cables. They are suitable in applications where a mix of signal, power and coaxial cable terminations for low frequency, shielded signal and high frequency applications are needed. The contact consist of an inner pin/socket and an outer male/female body. The thermoplastic insulating bushing in the outer body is designed to accept and permanently retain the inner contact. The outer ferrule hold the outer braid to the outer contact and act as an insulating support to ensure against bending and vibrating stresses. The inner and the outer conductor are crimped individually, thereby enabling inspection of both critical crimp points.

Features and benefits

- The inner and outer conductors are crimped individually
- The thermoplastic insulating bushing in the outer body is designed to accept and permanently retain the inner contact.
- Outer ferrule hold the outer braid to the outer contact and act as an insulating support to ensure against bending and vibration.

Performance characteristics

| | |
|--|------------------|
| Operating voltage between inner / outer contact: | 230 VDC |
| Test potential between inner / outer contact | 750 VAC 1 min. |
| Operating temperature: | -55°C to + 125°C |
| Contact retention in body: | 65 N min. |
| Contact voltage drop a 1A: | 25m V max. |
| Isolation at 30 MHZ: | 140 db. |

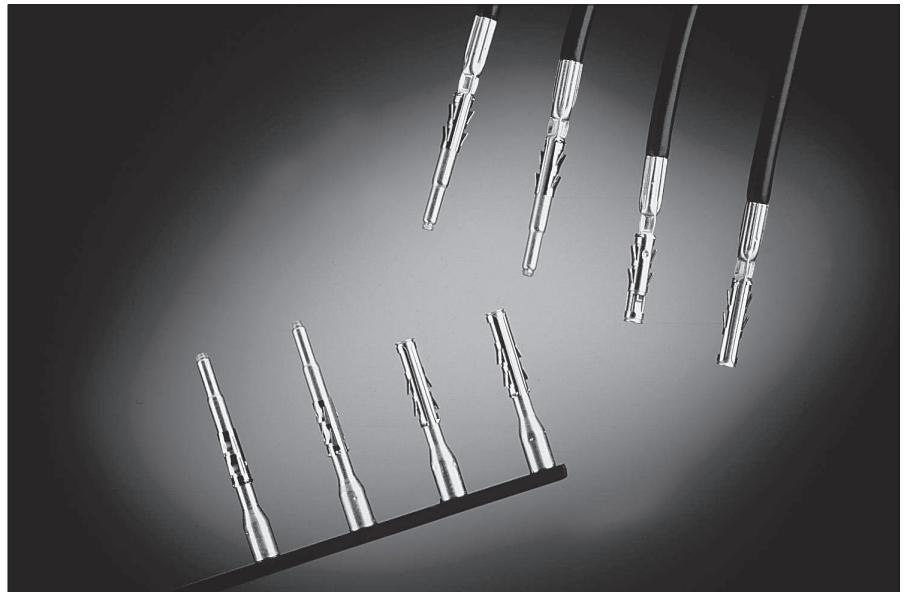

Construction

| | |
|---------------------------|------------------------------|
| Inner and outer contacts: | High conductive copper alloy |
| Retaining spring: | beryllium copper |
| Insulating bushing: | Polyamide 6.6 |

Plating table

| | |
|---------------------------|----------------------------------|
| Retaining spring: | Nickel plated |
| Inner and outer contacts: | D28: 0.75µ Gold min. over Nickel |

Connector accommodation

Any TRIM TRIO size 16 contact can be used in any contact position in any connector in the TRIM TRIO size 16 interconnection system.

- MS-M / MSG / MB
- SMS Qikmate
- UTG
- UTP
- UTO
- MBG

How to order

| | RMDX60 RCDX60 | 36 36 | D28 D28 |
|---------------------|--|----------|------------|
| Contact type: | RMDX = Male subminiature coax. RCDX = Female subminiature coax. | | |
| Multipiece coax kit | K10 = Lit male coax. K1 = Kit female coax. | | |
| Plating indication | | | |

RMDX/RCDX



MULTIPIECE Subminiature coax - Male contact for coaxial cable

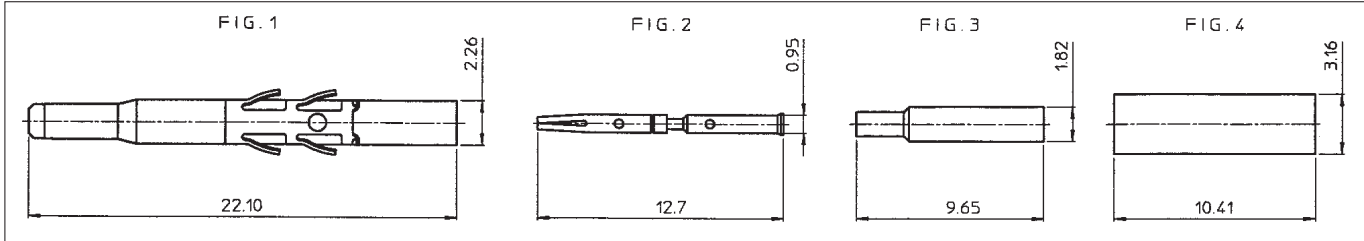

| Type of coaxial cable | Contact for inner conductor | | | | Contact for outer braid | | | | | | Extrac tool |
|--|-----------------------------|------|------------------|--------------|-------------------------|-----|--------------------------|--------|------------------|--------------|---------------|
| | Inner female contact | | Crimp tool M10S1 | | Outer male contact | | Hyring | | Crimp tool M10S1 | | |
| | Part number | Fig. | Die Set | Stop Bushing | Part number | Fig | Part number | Fig | Die Set | Stop Bushing | |
| RG161U RG179A/U RG179B/U RG187U | RFD26L1D28 | 2 | S23D2 | SL46D2 | RMDX602D28 | 1 | yOC074 | 4 | S22-1 | SL47-1 | RX2025 GE1 |
| RG174/U RG188/U Amphenol 21-598 | | | S26D2 | | | | yOC074 | 4 | | | RX16D11 D1 |
| RG178A/U RG196U | | | S23D2 | | | | yOC074 + RMDXB0553 | 4 3 | | | |

Kit reference RMDXK10D28 includes RMDX602D28 + RFD26L1D28 + YOC074 + RMDXB0553 and are packed in plastic bag.

MULTIPIECE Subminiature coax - Female contact for coaxial cable

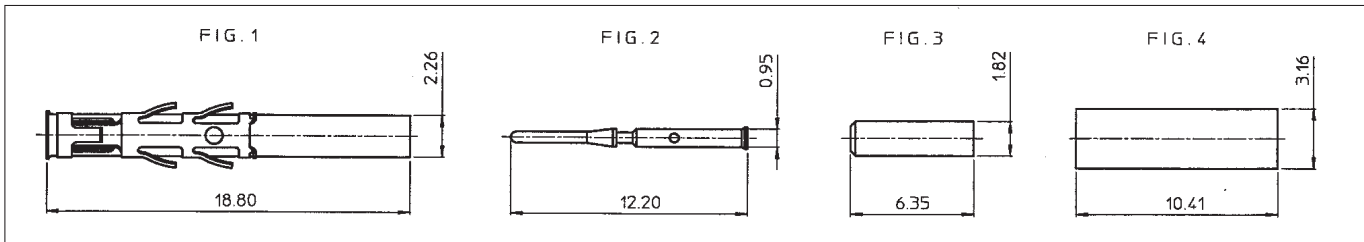

| Type of coaxial cable | Contact for inner conductor | | | | Contact for outer braid | | | | | | Extrac tool |
|--|-----------------------------|------|------------------|--------------|-------------------------|-----|--------------------------|--------|------------------|--------------|---------------------|
| | Inner male contact | | Crimp tool M10S1 | | Outer female contact | | Hyring | | Crimp tool M10S1 | | |
| | Part number | Fig. | Die Set | Stop Bushing | Part number | Fig | Part number | Fig | Die Set | Stop Bushing | |
| RG161U RG179A/U RG179B/U RG187U | RMD26L1D28 | 2 | S23D2 | SL46D2 | RCDX602D28 | 1 | yOC074 | 4 | S22-1 | SL47-1 | RX2025 GE1 |
| RG174/U RG188/U Amphenol 21-598 | | | S26D2 | | | | yOC074 | 4 | | | or RX16D11 D1 |
| RG178A/U RG196U | | | S23D2 | | | | yOC074 + RCDXB0551 | 4 3 | | | |

Kit reference RCDXK1D28 includes RCDX602D28 + RMD26L1D28 + YOC074 + RCDXB0551 and are packed in plastic bag.

RMDX/RCDX



MULTIPIECE Subminiature coax - Male contact for twisted pair cable

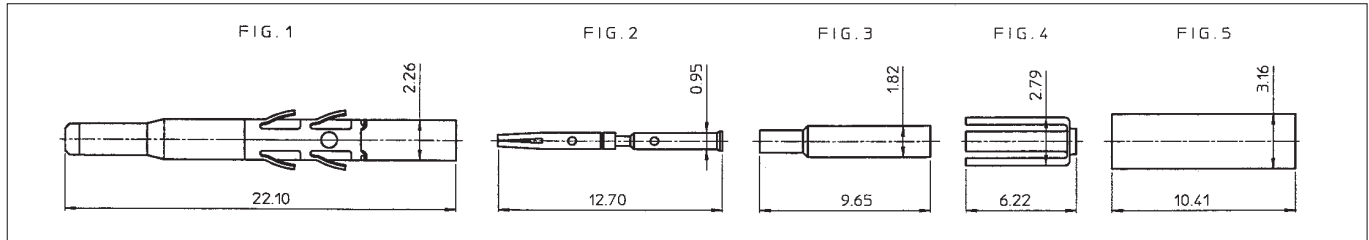

| Type of coaxial cable | Contact for inner conductor | | | | Contact for outer braid | | | | | | Extrac tool |
|--|-----------------------------|------|------------------|--------------|-------------------------|-----|-------------|-----|------------------|--------------|--------------------------------------|
| | Inner female contact | | Crimp tool M10S1 | | Outer male contact | | Hyring | | Crimp tool M10S1 | | |
| | Part number | Fig. | Die set | Stop bushing | Part number | Fig | Part number | Fig | Die set | Stop bushing | |
| 2 #24 solid or stranded | RFD26L1D28 | 2 | S26D2 | SL46D2 | RMDX602D28 | 1 | YORX090 | 4 | S221 | SL471 | RX2025 GE1 or RX16D11D1 |
| 2 #26 str | | | | | | | YOC074 | 5 | | | |
| 2 #24 7/0,20 str. MIL-W-76 or MIL-W-16878 type B | | | | | | | RMDXB0553 | 3 | | | |
| #28 per MIL-W-81822/3 | | | | | | | YORX090 | 4 | | | |
| | | | | | | | YOC074 | 5 | | | |
| | | | | | | | RMDXB0553 | 3 | | | |

MULTIPIECE Subminiature coax - Female contact for twisted pair cable

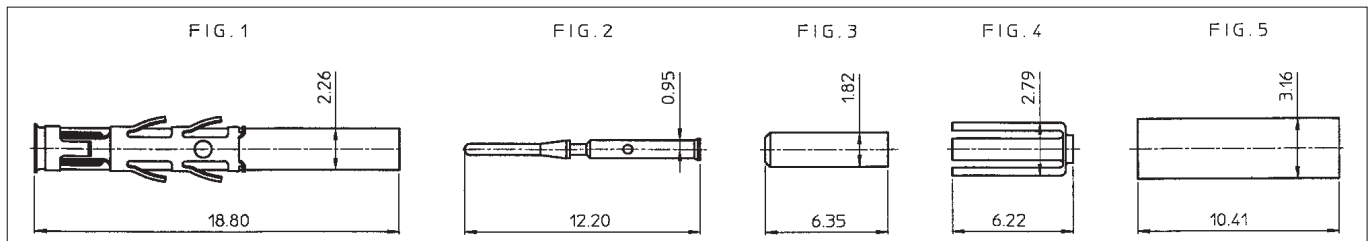

| Type of coaxial cable | Contact for inner conductor | | | | Contact for outer braid | | | | | | Extrac tool |
|--|-----------------------------|------|------------------|--------------|-------------------------|-----|-------------|-----|------------------|--------------|--------------------------------------|
| | Inner male contact | | Crimp tool M10S1 | | Outer female contact | | Hyring | | Crimp tool M10S1 | | |
| | Part number | Fig. | Die set | Stop bushing | Part number | Fig | Part number | Fig | Die set | Stop bushing | |
| 2 #24 solid or stranded | RMD26L1D28 | 2 | S26D2 | SL46D2 | RCDX602D28 | 1 | YORX090 | 4 | S221 | SL471 | RX2025 GE1 or RX16D11D1 |
| 2 #26 str | | | | | | | YOC074 | 5 | | | |
| 2 #24 7/0,20 str. MIL-W-76 or MIL-W-16878 type B | | | | | | | RCDXB0551 | 3 | | | |
| #28 per MIL-W-81822/3 | | | | | | | YORX090 | 4 | | | |
| | | | | | | | YOC074 | 5 | | | |
| | | | | | | | RCDXB0551 | 3 | | | |

Fibre optic contacts



Size 16 Fibre optic contacts for TRIM TRIO connectors

Description

Size 16 Fibre optic contacts are optical contacts designed for the integration of optical links in all TRIM TRIO cable connectors.

The F.O. contacts are designed to accommodate:

- Plastic Optical Fibre (POF)
1mm core and 2.2mm jacket
- Plastic Clad Fibre (PCF)
230 µm core and 2.2mm jacket
- Multimode Silica Fibre
50/125 µm type 1.5mm (or 900µm) jacket

Features and benefits

- Socket contact is spring loaded to avoid any air gap between the two optical faces.
- Low insertion loss is provided by high precision pieces.
- Single jumpers, multiway harness and active device housings can be supplied regarding customer requirement.

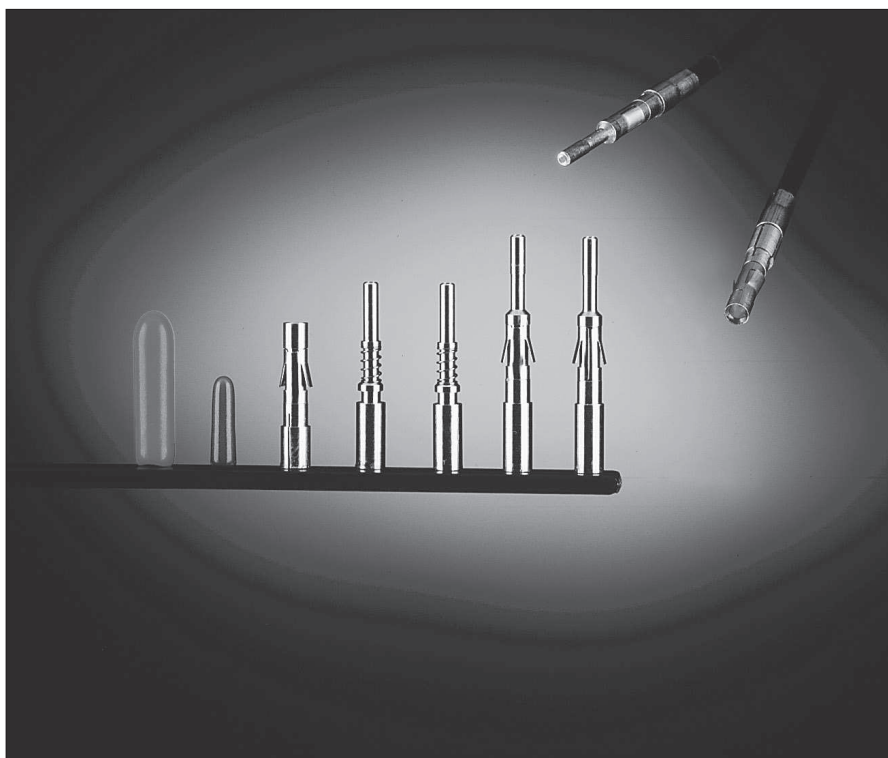

Performance characteristics

| | | |
|--------------------------------|----------------|-------------------------------|
| Fibre type | POF / PCF | Silica 50 / 125µm |
| Wave length | 650 nm | 850 or 1300 nm |
| Optical insertion loss (typ.) | 2 dB max. | < 0.5 dB |
| Jacketed external diameter | 2.2mm | 1.5mm (or 0.9mm with adaptor) |
| Temperature range | -25°C to +70°C | -40°C to +70°C |
| Cable retention | 49N | 60N |
| Mating cycles without cleaning | 50 | 50 |
| Max. mating cycles | 500 | 250 |

Connector accommodation

Any TRIM TRIO size 16 contact can be used in any contact position in any connector in the TRIM TRIO size 16 interconnection system.

- MS-M / MSG / MB
- SMS Qikmate
- UTG
- UTP
- UTO

Construction

Contact body: Copper alloy

Outer spring: BeCu

How to order

POF Contacts (Plastic Optical Fibre)

Male contact: RMPOF1000

Female contact: RCPOF1000

PCF Contacts (Plastic Clad Fibre)

Male contact: RMPCF230

Female contact: RCPCF230

Silica Contacts

Male contact: 8012P14G353

Female contact: 8012S14G353

Tool kit

Crimping / polishing technic

The tool kit contains all necessary tools to terminate contacts for POF fibre or Silica fibre, such as

- Stripping plier
- Crimping plier
- Polishing plate and tool
- Miscellaneous

Part number: consult factory

[illegible]

RM/RC-W machined contact SM/SC-W stamped contacts



Size 20 contacts for UTOW connectors

Description

Size 20 contacts with a .040" (1.0mm) pin diameter are two piece crimp snap-in contacts in pin and socket version available in:

- Solid machined version
- Stamped and formed version
- Solid machined dip solder contacts
 - 50A7
 - 5016

And designed for heavy duty top performance requirements. These contacts consist of a crimp/solder body made of high conductive copper alloy, and a stainless steel retaining spring featuring retention in the housing cavity and a closed entry socket to prevent probe damage.

Crimp contacts accommodate AWG20 through AWG26 wire and the crimp barrels.

All contacts have to be ordered separately

Features and benefits

- Made from high conductive copper alloy with gold plate finish.
- Two piece construction with dual purpose spring which serves for contact retention and protects the body against damage.
- Stamped and formed contacts packaging
 - On reel: 3000 pcs
 - In bulk packing: 100 pcs in plastic bag
- Solid machined crimp and dip solder contacts packaging
 - 50 pcs in plastic box

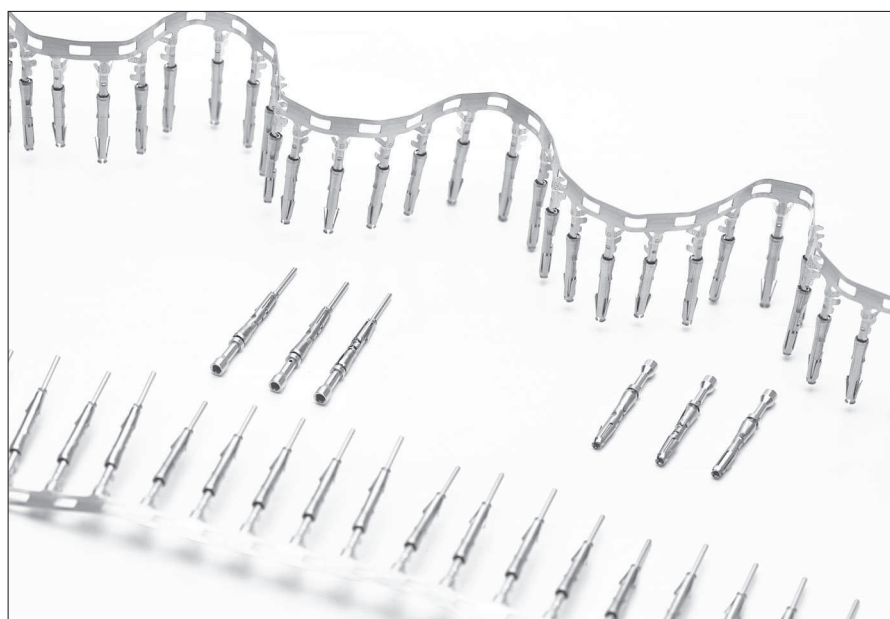

Performance characteristics

| | Machined | Stamped and Formed |
|----------------------------------|-------------------------|-------------------------|
| Current rating: | 7,5 Amps | 5 Amps |
| Contact resistance: | ≤ 6 mΩ | ≤ 15 mΩ |
| Dielectric withstanding voltage: | 1500 V Rms min | |
| Contact retention in body: | 90 N max. | |
| Contact engagement force: | 5 N max. | |
| Contact separation force: | 2 N min. | |
| Plating: | 0.40 μ gold over nickel | 0.75 μ gold over nickel |



Construction

Contact body: High conductive copper alloy.
Outer spring: Stainless steel

Connector accommodation

Any size 20 contacts for UTOW connectors can be used in any contact position.

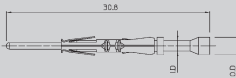
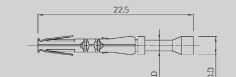
How to order

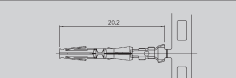
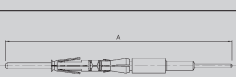
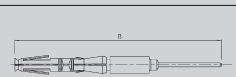
| Contact type | | | Part number | AWG | Section mm2 | Insulation diameter | Tooling |
|---|---|---|---|---|-------------|--|--------------------------------|
| Machined crimp |  | Pin | RM24W3K | 26 – 24 | 0.13 – 0.25 | 0.89 – 1.58 | MH860 + positionner MH86301 |
| | | | RM20W3K | 22 – 20 | 0.35 – 0.50 | 1.17 – 2.08 | |
| | | | RM18W3K | 20 - 18 | 0.50 - 1.00 | 1.20 - 2.10 | |
| |  | Socket | RC24W3K | 26 – 24 | 0.13 – 0.25 | 0.89 – 1.58 | |
| | | | RC20W3K | 22 – 20 | 0.35 – 0.50 | 1.17 – 2.08 | |
| | | | RC18W3K | 20 - 18 | 0.50 - 1.00 | 1.20 - 2.10 | |
| Stamped & formed crimp |  | Pin | Reeled loose piece SM24W3S26 SM24WL3S26 | 26 – 24 | 0.13 – 0.25 | 0.89 – 1.58 | Y16SCM3 or Y14MTV |
| | | | Reeled loose piece SM20W3S26 SM20WL3S26 | 22 – 20 | 0.35 – 0.50 | 1.17 – 2.08 | |
| | |  | Socket | Reeled loose piece SC24W3S25 SC24WL3S25 | 26 – 24 | 0.13 – 0.25 | |
| | Reeled loose piece SC20W3S25 SC20WL3S25 | | | 22 - 20 | 0.35 – 0.50 | 1.17 – 2.08 | |
| | | | | | | | |
| | Machined Dip solder |  | Pin | 50A7 | RMW50AK7 | For solder tail details see next page. | |
| 5016 | | | | RMW5016K | | | |
|  | | Socket | 50A7 | RCW50A7K | | | |
| | | | 5016 | RCW5016K | | | |

RM/RC-W Machined Contacts



Nominal length (dim G) of dipsolder contacts out of connector (contacts to be ordered separately)

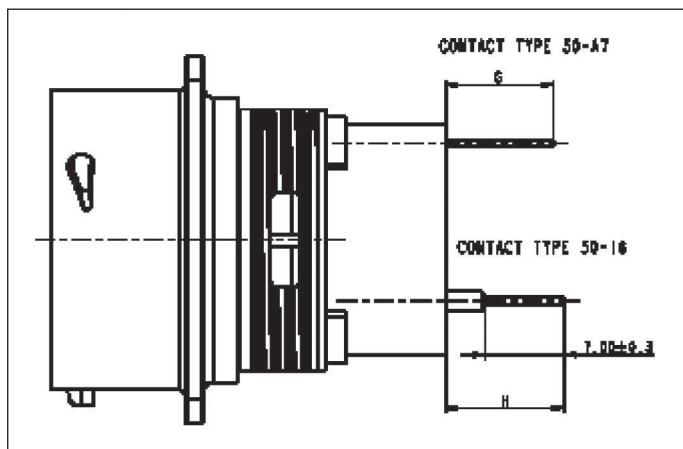

UT0W0 wall mounting receptacle connectors

| Connector size | Pin contact RMW50A7K | RMW5016K | Socket contact RCW50A7K | RCW5016K |
|----------------|-------------------------|----------|----------------------------|----------|
| 10 | 9.43 | 10.33 | 9.85 | 10.50 |
| 12 | | | | |
| 14 | | | | |
| 16 | | | | |
| 18 | | | | |
| 20 | 9.24 | 10.32 | 7.65 | 8.31 |
| 22 | | | | |
| 24 | | | | |

UT0W7 jam nut receptacle connectors

| Connector size | Pin contact RMW50A7K | RMW5016K | Socket contact RCW50A7K | RCW5016K |
|----------------|-------------------------|----------|----------------------------|----------|
| 10 | 9.51 | 10.41 | 2.4 | 3.04 |
| 12 | | | | |
| 14 | | | | |
| 16 | | | | |
| 18 | | | | |
| 20 | 5 | 6 | — | — |
| 22 | | | | |
| 24 | 3.6 | 4.6 | | |

For recommended PC-Board hole lay out: Consult factory

Power contacts 8291



Contacts

TRIM TRIO Connectors also offer possibilities to use or combine power contacts with the standard size 16 signal contacts into the same housing. It offers customers to reduce the number of connectors when combining signal and high current applications into 1 connector.

The signal cavities accept the full range of TRIM TRIO size 16 contacts for applications up till 13 A.

Power cavities will either accept:

- Size 12 contacts for applications up till 26 A
- Size 8 contacts for applications up till 44 A

Pin and Socket contacts are solid machined crimp snap-in and sockets for heavy duty top performance requirements

Springs on both contacts are made of spring tempered, heat-treated, beryllium copper.



Construction

Contact body : High conductive copper alloy

Outer spring : Tempered, heat-treated, non plated beryllium copper.

Plating

K = 0.4m Gold mini all over, over Nickel

A = 3μ Silver all over

Performance characteristics

| | Contacts # 12 (Ø 2,4) | Contacts # 8 (Ø 3,6) |
|----------------------|-----------------------|----------------------|
| Current rating : | 26 A | 44 A |
| Contact resistance : | ≤ 5 mΩ | ≤ 5 mΩ |

Power contacts 8291



Contacts # 12 (2.4 mm)

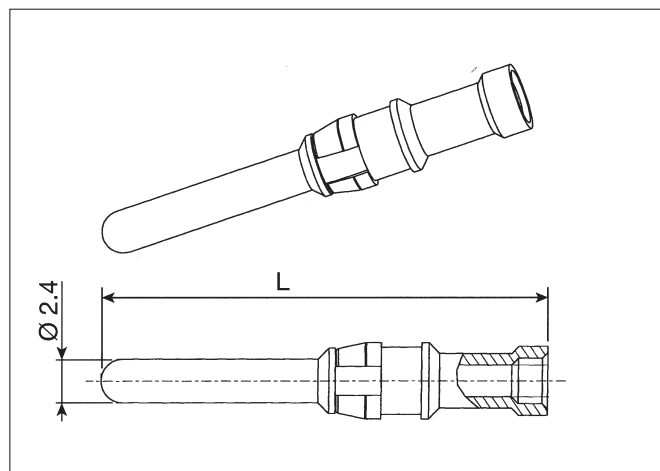
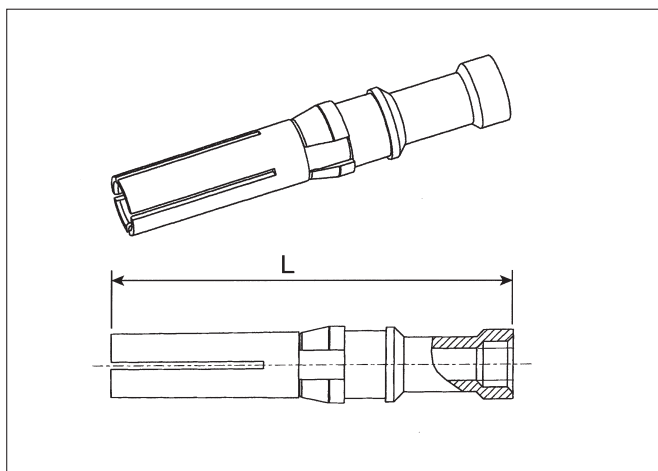

Contacts # 8 (3.6 mm)

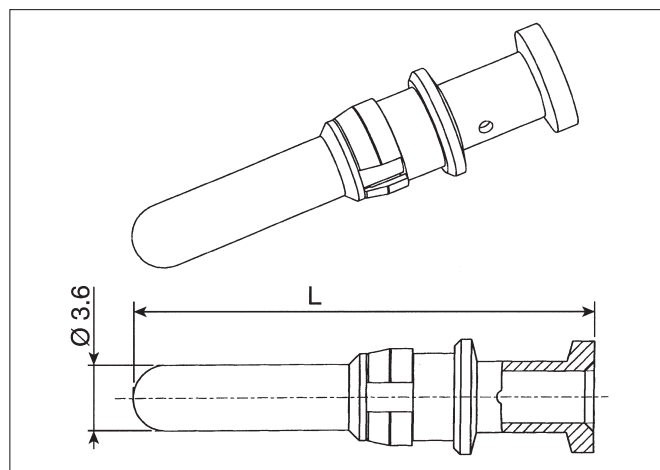
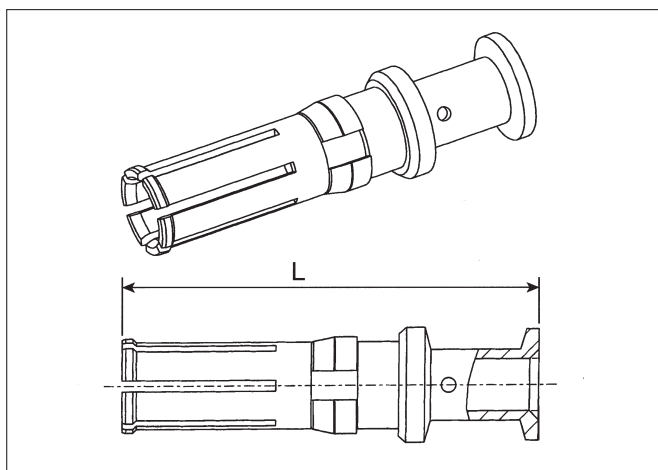

How to order

| Part number | | Contact size | Contact diameter | Cable | | | | Locator | Extraction tooling |
|-------------|-----------|--------------|------------------|----------|-----------------|--------------------|------|-----------|--------------------|
| Pin | Socket | | | Section | | Insulator diameter | | | |
| | | | | mm | mm ² | AWG | | | |
| 82911437NA | 82911436A | # 12 | 2.4 | 0.5 | 20 | 4.9 | M317 | VGE10077A | 51060210924 |
| 82911435NA | 82911434A | | | 0.75-1.0 | 18 | | | | |
| 82911463NA | 82911462A | | | 1.5 | 16 | | | | |
| 82911465NA | 82911464A | | | 2.5 | 14 | | | | |
| 82911437NK | 82911436K | # 12 | 2.4 | 0.5 | 20 | 4.9 | M317 | VGE10077A | 51060210924 |
| 82911435NK | 82911434K | | | 0.75-1.0 | 18 | | | | |
| 82911463NK | 82911462K | | | 1.50 | 16 | | | | |
| 82911465NK | 82911464K | | | 2.5 | 14 | | | | |
| 82913601A | 82913600A | # 8 | 3.6 | 1.5 | 16 | 6.5 | M317 | VGE10078A | 51060210936 |
| 82913603A | 82913602A | | | 2.5 | 14 | | | | |
| 82913605A | 82913604A | | | 4 | 12 | | | | |
| 82913607A | 82913606A | | | 6 | 10 | | | | |
| 82913609A | 82913608A | | | 10 | 8 | | | | |

Accessories



Discrimination keys for TRIM TRIO size 16 connectors

Description

In applications where similar connectors are used next to each other, mismatching can be a reason for disturbances, system failure or even danger to operating personnel. To eliminate mismatching, all TRIM TRIO connectors can be equipped with discrimination keys, which offer unlimited possibilities for a "fool - proof" interconnection system.

When one of these discrimination keys is used, the TRIM TRIO connector will only mate with a connector which has a vacant contact or discrimination cavity at the corresponding position.

This system offers boundless opportunities for all applications which involve several identical TRIM TRIO connectors.

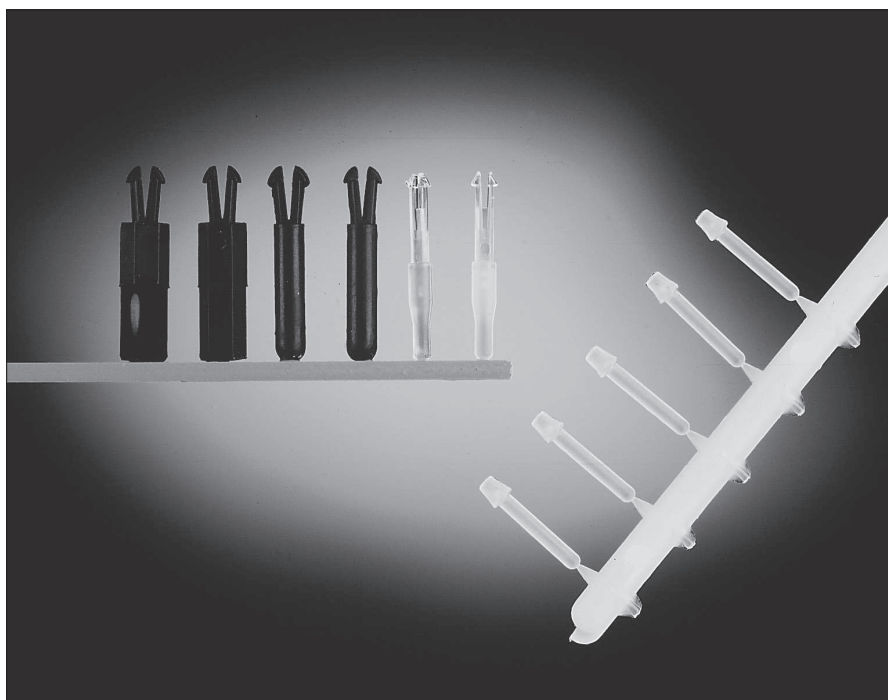

The material used is polyamide 6.6

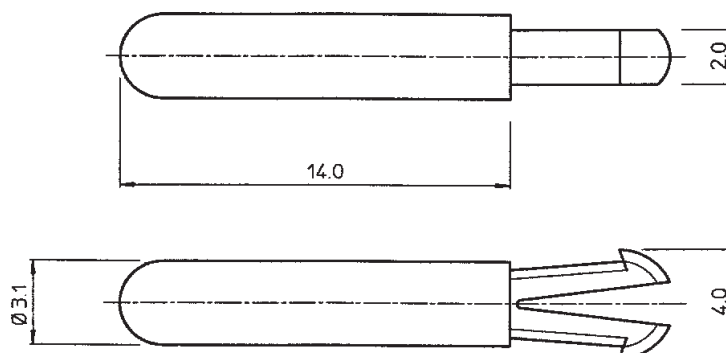

SMSPKE0

A dummy contact, which can be inserted into an empty contact cavity in any of the TRIM TRIO connectors.

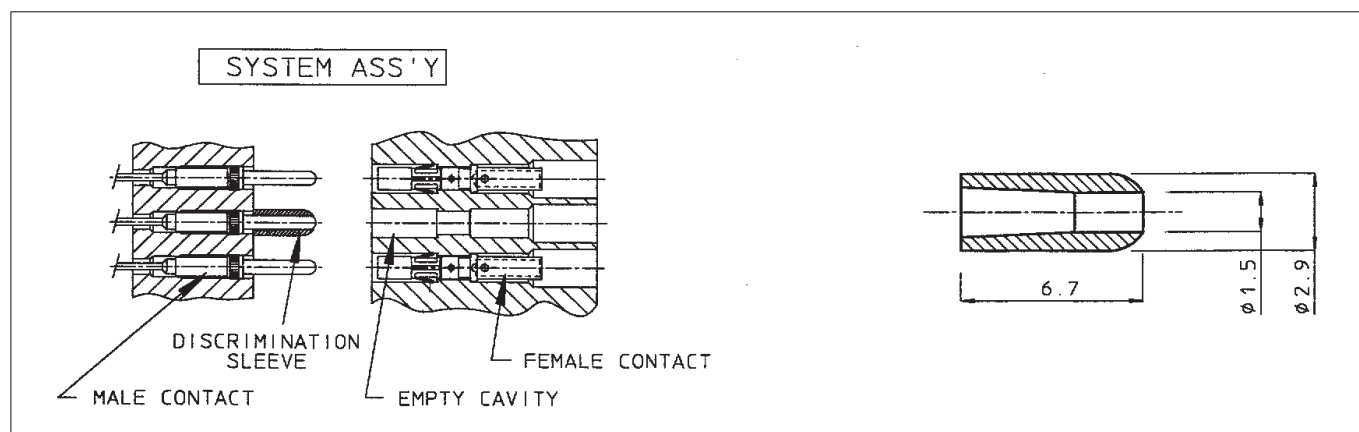

SMSPKB2

A tube, which can be fitted over a preassembled male contact in all TRIM TRIO male boardmount connectors MSO, SMS, MSG.

Accessories

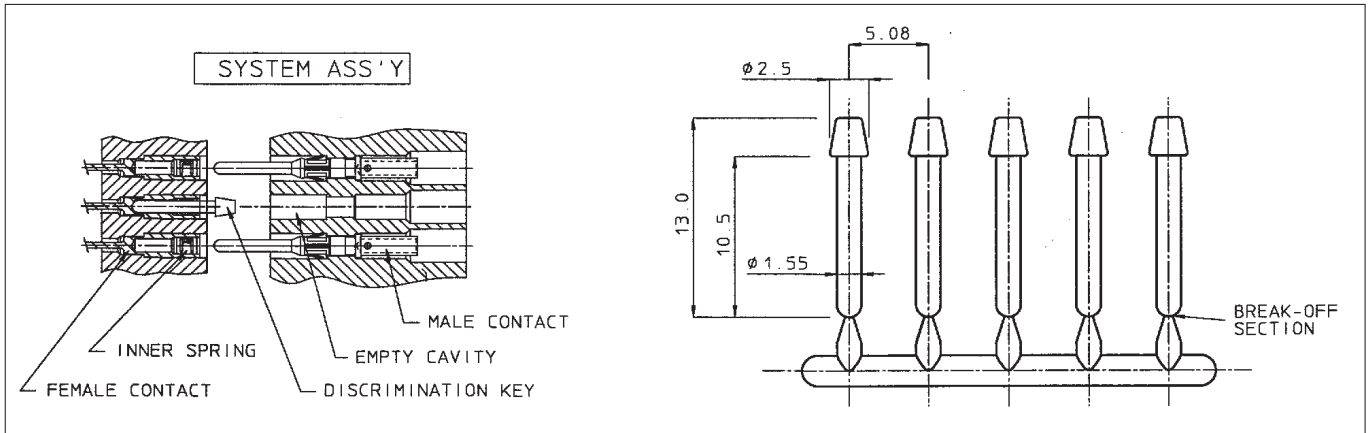

SMSPE2V1

A pin, which can be inserted into a preassembled female contact in all TRIM TRIO female boardmount connectors MSO, SMS.

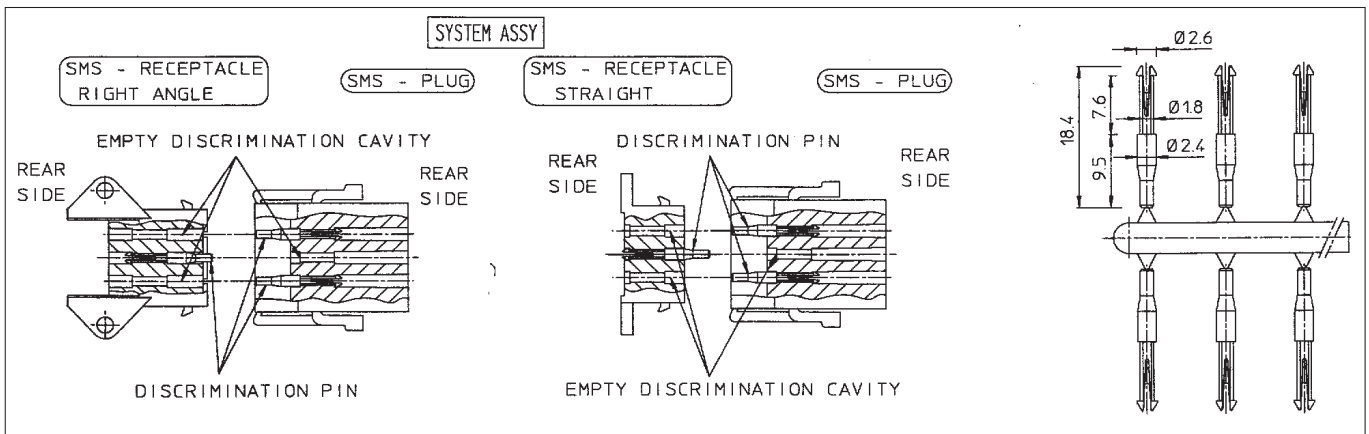

SMSPE3

A pin, which can be inserted in the discrimination cavities of the SMS Qikmate cable and boardmount connectors. The discrimination cavities are in between of the contact cavities and offer the advantage that no contact cavities are lost due to discrimination.

As extraction tool, the RX2025GE1 without the "extraction tool tip" can be used.

To unlock the discrimination pin, insert the extraction tool in the discrimination cavity at the rear side of the connector. Meanwhile, the pin can be extracted manually at the mating side.