

KN5107

Capacitive sensors

no longer available - archive entry

Alternative article: KQ6004

When selecting an alternative article and accessories please note that technical data may differ!

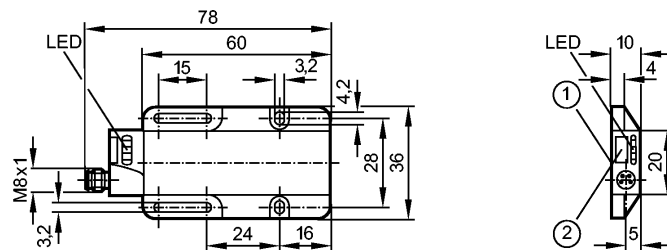

1: sensing face
2: teach-in element



Made in Germany

Product characteristics

Level sensor
Rectangular, plastics
Connector
Function check output
Adjustment to the empty and full state possible; [nf] non-flush mountable

Application

Application For dry bulk materials and liquids, detection through non metal tank walls or bypass pipes. Optimised for media with a dielectric constant < 20 (e.g. oils).

Electrical data

Electrical design	DC PNP
Operating voltage [V]	10...36 DC
Current consumption [mA]	< 30 (24 V)
Protection class	II
Reverse polarity protection	yes

Outputs

Output function normally open / closed programmable

Voltage drop

- Switching output [V]	< 2.5
- Function check output [V]	< 3.5

Current rating

- Switching output [mA]	150
- Function check output [mA]	10
Short-circuit protection	pulsed
Overload protection	yes
Switching frequency [Hz]	5

Environment

Ambient temperature [°C]	-25...80
Protection	IP 67

Tests / approvals

EMC	EN 60947-5-2
-----	--------------

Mechanical data

KN5107

Capacitive sensors

Mounting	non-flush mountable
Housing materials	PC; PBT
Weight [kg]	0.057

Displays / operating elements

Output status indication	LED	yellow
Operation	LED	green
Function display	LED	red

Electrical connection

Connection	M8 connector; gold-plated contacts
------------	------------------------------------

Wiring

2: function check /
programming wire

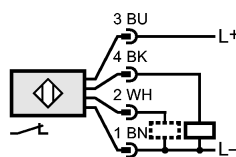
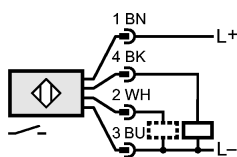

Accessories

Accessories (included)	screwdriver
------------------------	-------------

ifm electronic gmbh • Friedrichstraße 1 • 45128 Essen — We reserve the right to make technical alterations without prior notice. — GB — KN5107 — 05.02.2009

no longer available - archive entry

Alternative article: KQ6004

When selecting an alternative article and accessories please note that technical data may differ!