

L3309A



Type: Size 0 fuseholder

Rating: 15A @ 250Vac

Insulation Resistance: 100 Mohms @ 500v DC

Breakdown Voltage: 1500V AC for 1 Min

Approvals: UL/CSA

Fuse Size: 6.3 x 32mm

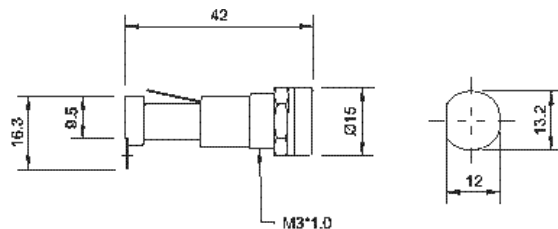

L3313



Type: Size 0 fuseholder

Rating: 10A @ 250Vac

Insulation Resistance: 100 Mohms @ 500v DC

Breakdown Voltage: 1500V AC for 1 Min

Approvals: UL/CSA

Fuse Size: 6.3 x 32mm

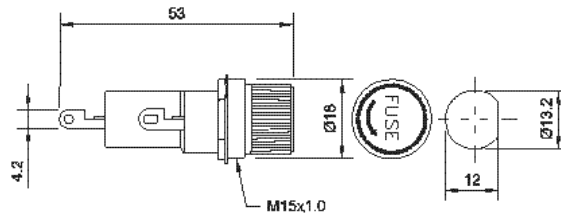

L3338



Type: Size 0 fuseholder

Rating: 10A @ 250Vac

Insulation Resistance: 100 Mohms @ 500v DC

Breakdown Voltage: 1500V AC for 1 Min

Approvals: UL

Fuse Size: 6.3 x 32mm

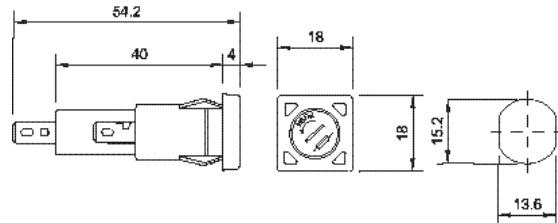

L3344A



Type: Size 0 fuseholder

Rating: 15A @ 250Vac

Insulation Resistance: 100 Mohms @ 500v DC

Breakdown Voltage: 1500V AC for 1 Min

Approvals: UL

Fuse Size: 6.3 x 32mm

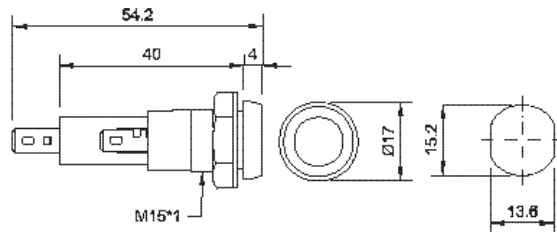

L3346A



Type: Size 0 fuseholder

Rating: 15A @ 250Vac

Insulation Resistance: 100 Mohms @ 500v DC

Breakdown Voltage: 1500V AC for 1 Min

Approvals: UL

Fuse Size: 6.3 x 32mm

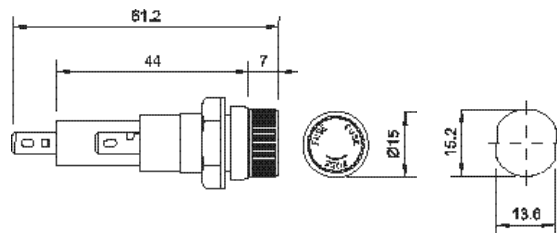

L3349A



Type: Size 0 fuseholder

Rating: 10A @ 250Vac

Insulation Resistance: 100 Mohms @ 500v DC

Breakdown Voltage: 1500V AC for 1 Min

Approvals: UL

Fuse Size: 6.3 x 32mm

