

USER GUIDE

kogan.com



C9 PRO CORDLESS 25.9V STICK VACUUM CLEANER

KAVACSTC09A

SAFETY & WARNINGS

Please Read Carefully This Manual Before Operating This Machine

- This vacuum cleaner is design for dry-use only; please do not use to suck liquids such as water, detergent or other wet objects. Do not allow water and other liquids on or into the machine in case of short circuit.
- Do not use this vacuum cleaner to suck small granule suck as flour, cement, gypsum, plaster powder; or large objects such as toys, debris, or paper balls. It will cause blockage and may result in permanent damage to the vacuum.
- Only use a dry cloth to clean the machine; do not use detergent. Doing so may risk cracks or discolouration to the product.
- Do not operate or store the machine in extreme high or low temperature environments. Recommended use for this product is between 0-40°C. Store only in a cool, dry place, free from long exposure to sunlight.
- For first time use, or when using after a long storage period, ensure the battery is fully charged. If storing this vacuum cleaner for a long period, make sure to operate and recharge every three months for better battery life.
- Unplug the adaptor when product is fully charged, if cleaning the product, or if performing maintenance tasks upon the product.
- Do not drag the power cord.
- Do not dispose of this product or battery as general waste. Contact your local council or waste management provider for advice on how to dispose of this vacuum cleaner and its battery in a safe and environmentally conscious manner.
- Battery cells in the battery unit can only be used for this machine and may not be used for other means. Only charge this vacuum cleaner with the adaptor that was provided.
- Do not disassemble the battery unit, and do not allow it to come into any contact with water or other liquids. Do not expose battery to extreme high or low temperatures. Do not insert sharp objects near the battery, or cause damage to the battery in any way.
- If the machine cannot be operated correctly, or some parts are broken, do not disassemble the machine. Cease use immediately and contact **help.kogan.com** for further assistance.
- Do not let children use or play with this machine or charge the batteries unit in case of any dangers.

OVERVIEW

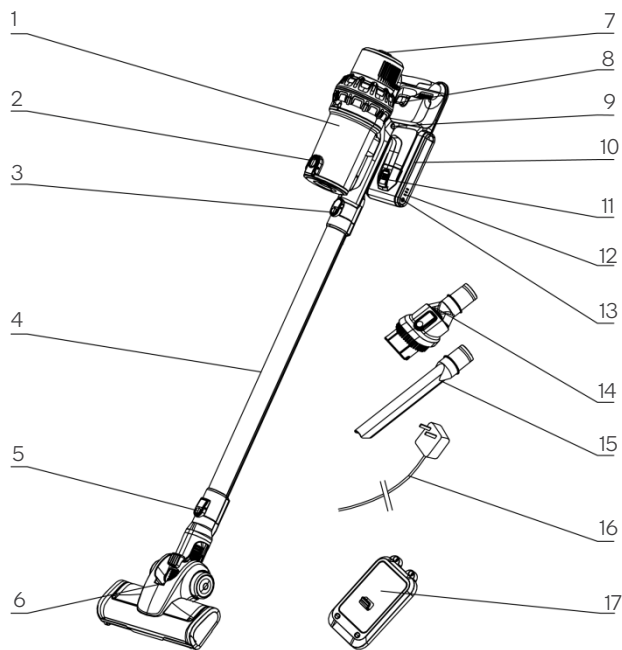

1. Dust cup assembly

2. Dust cup lid release button

3. Power tube release button

4. Aluminium power tube

5. Power brush release button

6. Power brush

7. Dust cup assembly release button

8. Power trigger

9. Speed adjust button

10. Battery pack

11. Battery pack release button

12. Capacity indicator

13. Power adapter port

14. 2-in-1 upholstery brush

15. Long crevice nozzle

16. Power adaptor

17. Wall-mount plate

ASSEMBLY INSTRUCTION

1. Installing battery pack

Insert the battery pack onto the bottom of the lower assembly until an audible 'click' is heard. Ensure the pack is securely connected before use.

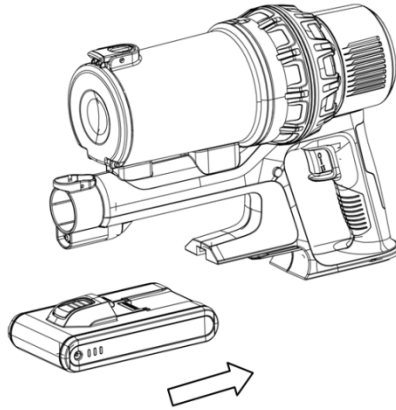

2. Attaching Upper Assembly with Lower Assembly

Align the hook of the upper assembly into the opening at the top of the lower assembly. Then press the rear of the upper assembly down onto the lower assembly until an audible 'click' is heard.

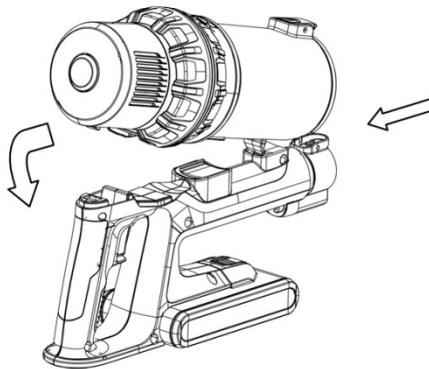

3. Attaching Power Brush to Power Tube

Align the opening at the top of the power brush with that of the lower end of the power tube, and insert until an audible 'click' is heard.

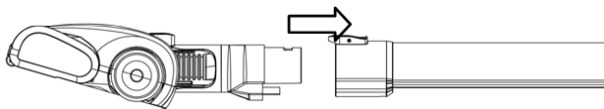

4. Attaching Power Tube to main assembly

Ensure upper and lower assembly have already been attached (Step 2, previous page) before this step. This forms the "main assembly" referenced here.

Align the opening at the top end of the power tube with the opening in the main assembly, and insert until an audible 'click' is heard.

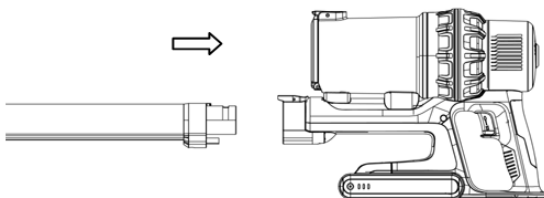

5. Attaching the Power Brush to main assembly

The power brush head can be directly attached to the main assembly, without the power tube in place. Follow the same steps as above, with just the power brush inserting into the main assembly.

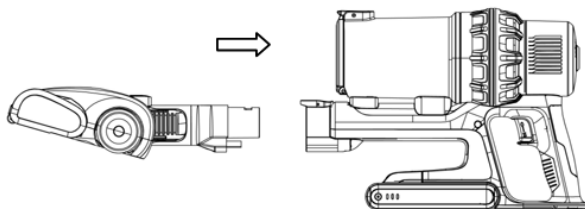

6. Assembly of Accessory Brushes with Vacuum Cleaner

These same steps are also applicable for the long crevice nozzle and 2-in-1 upholstery brush.

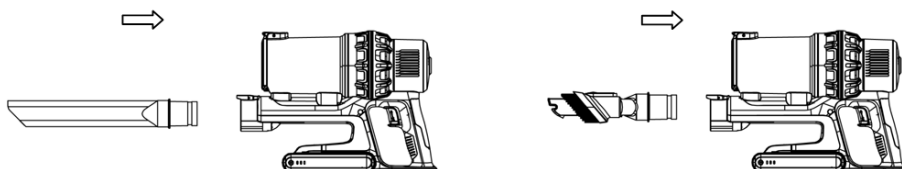

7. Installing the wall-mount (optional)

- Fix the wall-mount plate to the wall using the screws provided.
- The vacuum cleaner should be mounted to the wall only as depicted here:

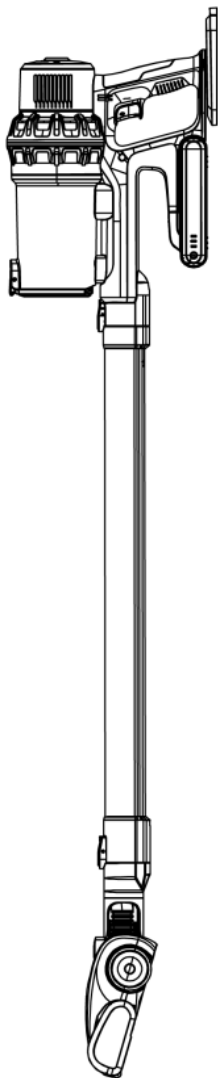

OPERATION

Charging the vacuum cleaner

- Use only the supplied power adaptor to charge the vacuum cleaner.
- Plug the adaptor into a mains power outlet, and then connect to the vacuum cleaner. Charging will automatically occur when the power outlet is switched on, and will be evident from the LED lights. The lights will flash in sequence while charging, and all 3 will remain solid when fully charged.
- Disconnect once fully charged.
- When the battery is depleted, recharge to full capacity before continued use.
- The battery pack can be charged separately or while attached to the main assembly.
- If used for a long period of time and the battery pack is noticeably hot, wait until the unit has cooled down before charging. If attempting to charge while the battery pack is at high temperature, the 3 LED lights will remain solid as an error warning. Disconnect the adaptor and wait for the unit to cool down before charging.

Power On and Speed Adjust Button

- After charging to full capacity, the vacuum cleaner is ready for use.
- Press the speed adjust button to select between low and high speed, and pull the trigger to power the device on.
- There are three modes for the vacuum operation: high speed, low speed, and power off.

Using accessory brushes

- Follow the steps in the Assembly Instruction pages of this user guide to see how to fit the various brush-heads.

Using the power brush

- With the power brush fitted, the vacuum cleaner can be used to clean carpets, tiles, and other general floor surfaces.

Using the 2-in-1 upholstery brush

- While using the 2-in-1 upholstery brush, push the brush head outwards and lock into place to clean items such as home appliances, bookshelves, wardrobes, tables, computer keyboard and other household furniture.
- Pull back the brush head of 2-in-1 upholstery brush and lock it into place for use with items such as beds, curtains, sofas and so on.

Using the long crevice nozzle

- With the long crevice nozzle accessory fitted, this can be used to clean crevices of sofas, or baseboards.

CLEANING & CARE

1. Emptying the dust cup

Press the dust cup assembly release button to release the dust cup assembly, then press the lower release button to remove the dust cup cover. It is recommended to remove and clean the dust cup after every use.

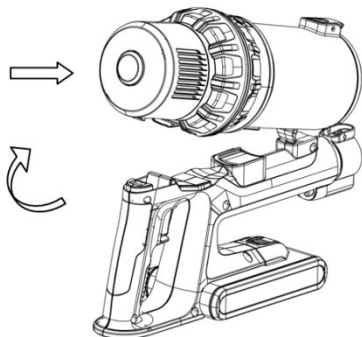

2. Full dust cup and filter cleaning

- Press the dust cup lid release button to open the dust cup lid and empty the dust.

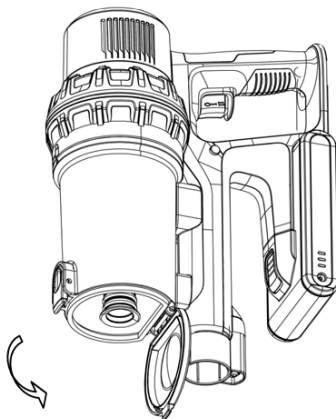

- Hold the dust cup with one hand and use the opposite hand to open the upper part of the dust cup, twisting in an anti-clockwise direction, and remove the upper part of the dust cup.

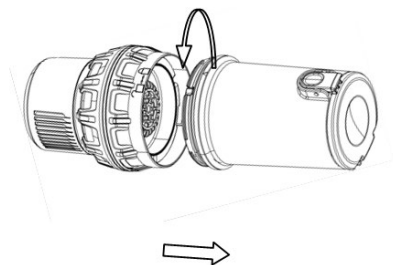

- Take out the filter (as shown) and clean or change it.

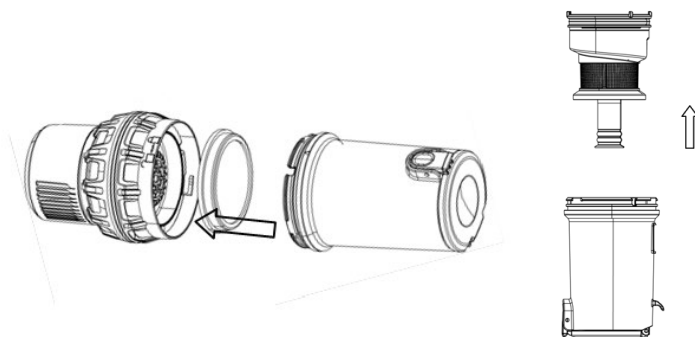

- Clean the filter under running water and dry it under sunlight. Ensure it is completely dry before refitting.

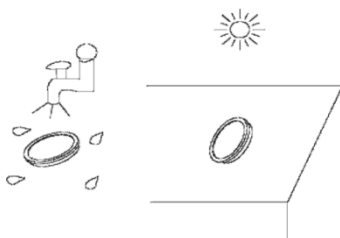

Cleaning the power brush head

1. Slide the lock clip from the back of the brush.
2. Remove the bristle from the brush. Do not wash the brush bristle.
3. Clean by shaking dust and debris into a bin, and using a dry towel to remove dust.
4. After cleaning, reassemble the bristle to the brush and lock the clip.

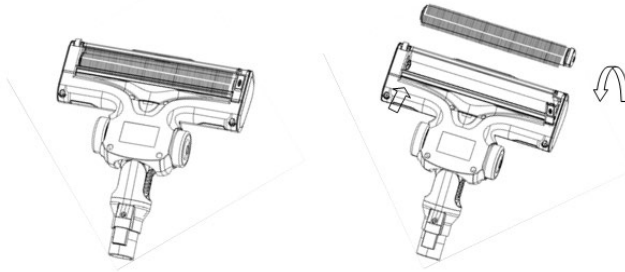

Note:

After long periods of use, the bristle may be jammed by hair or similar build-up, requiring occasional cleaning to ensure efficient operation.

TROUBLESHOOTING

If experiencing problems, first try the following steps.

| ISSUE | CAUSE | SOLUTION |
|---|--|---|
| Vacuum cleaner is not powering on, or only giving weak power. | <ul style="list-style-type: none">• No power in battery• Not charged for long enough | <ul style="list-style-type: none">• Charge the battery to full capacity. The LEDs will light up in sequence when charging, and all 3 will remain solid when fully charged. |
| Vacuum not picking up much dust. | <ul style="list-style-type: none">• Dust cup full• Filter is blocked• Bristle not rotating | <ul style="list-style-type: none">• Empty dust cup• Clean or change filter• Clean motor brush |
| No charging indicator | <ul style="list-style-type: none">• Adapter not correctly connected | <ul style="list-style-type: none">• Ensure that the wall outlet is switched on• Ensure that the adapter is correctly attached to the vacuum |
| Run time decreased | <ul style="list-style-type: none">• Not charged for long enough | <ul style="list-style-type: none">• Ensure battery is charged to full capacity |
| Bristle in power brush not working | <ul style="list-style-type: none">• Power brush blocked by build-up of hair and other debris• Attempting to vacuum large objects or rubbish | <ul style="list-style-type: none">• Clean the bristle and work again• Avoid vacuuming large objects. The product is designed for dust, large objects should be cleared beforehand. |

If problems persist, please contact **help.kogan.com** for further assistance.

NOTES

This image shows a single page of white paper with horizontal ruling lines. The lines are evenly spaced and run across the width of the page. There are no margins, text, or other markings on the paper.

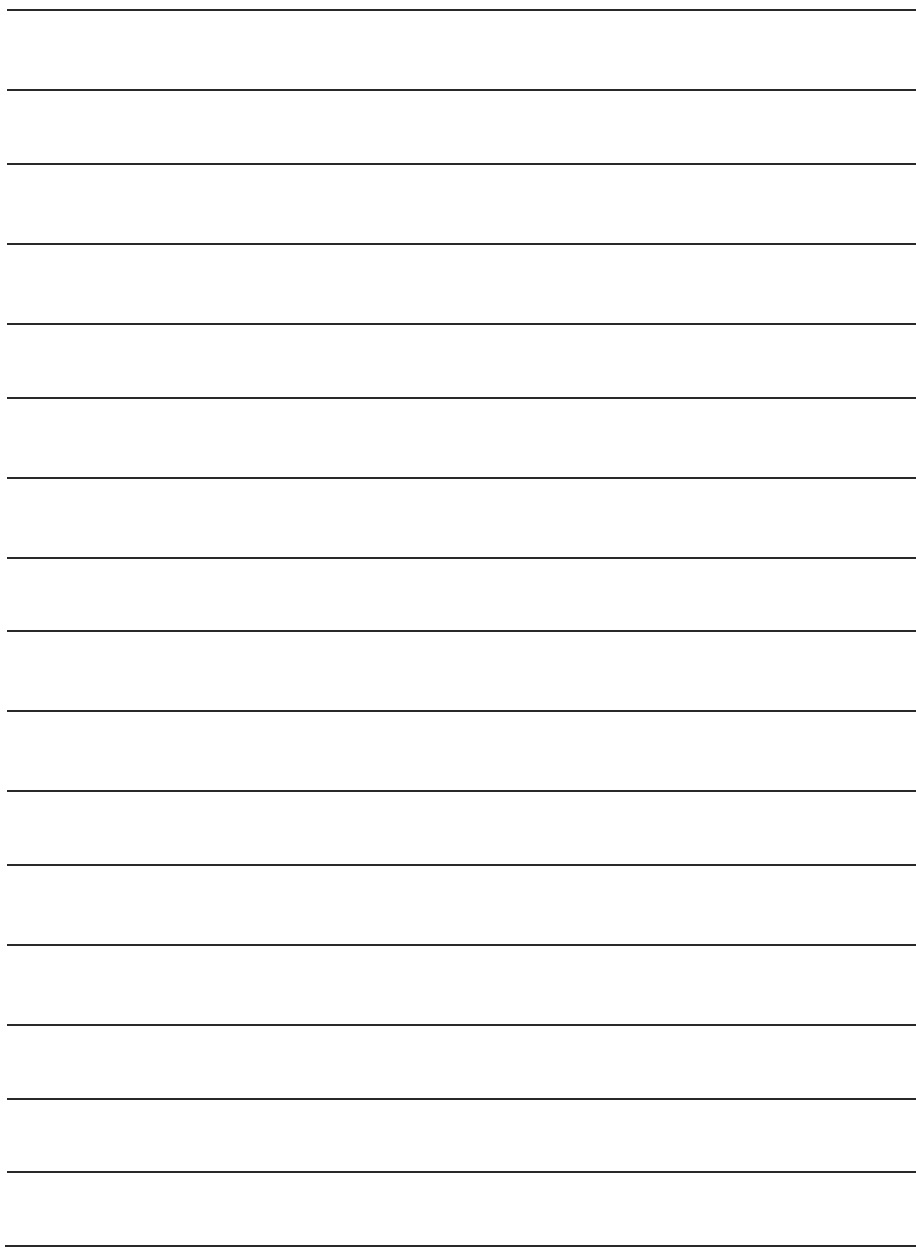

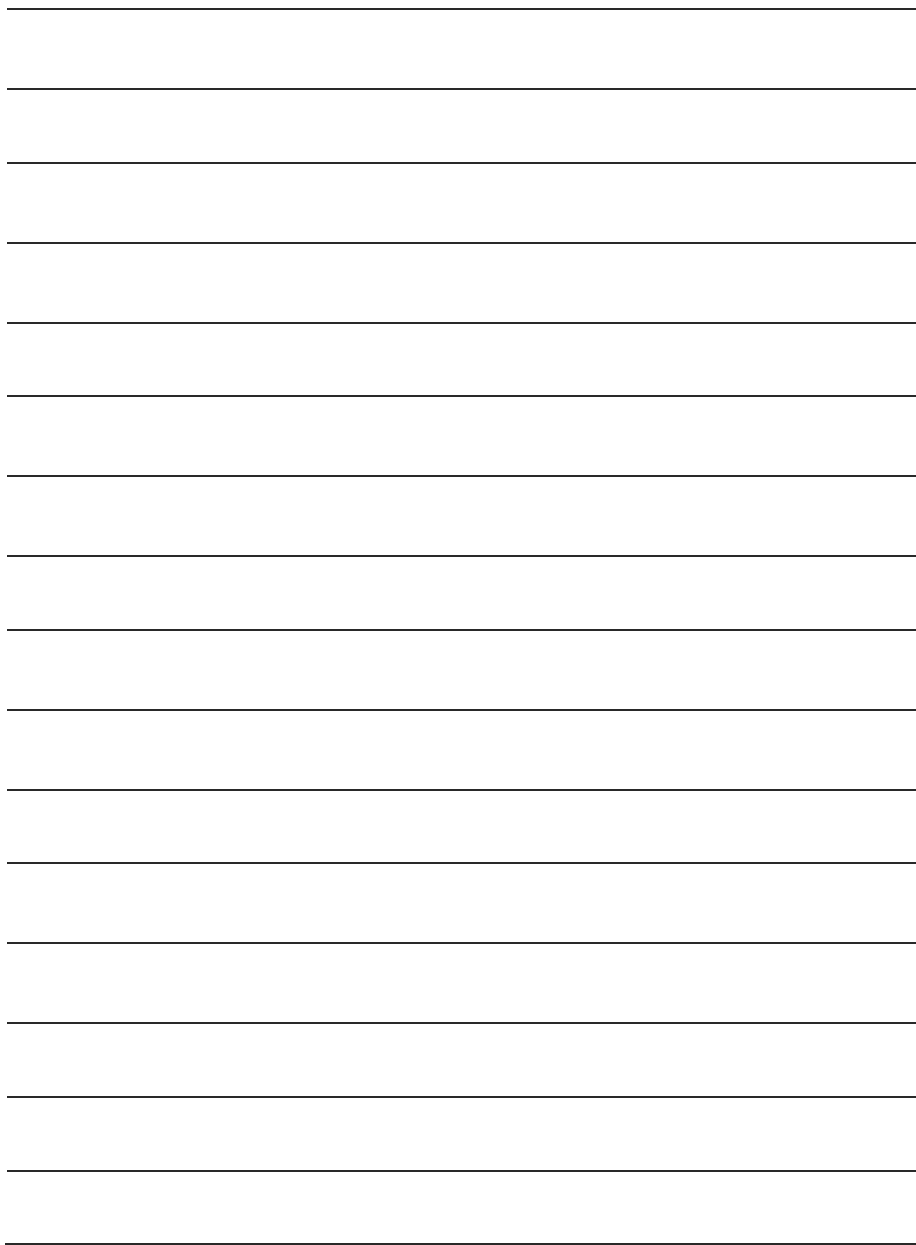

Need more information?

We hope that this user guide has given you the assistance needed for a simple set-up. For the most up-to-date guide for your product, as well as any additional assistance you may require, head online to **help.kogan.com**

kogan