



4270 Airborn Drive
Addison, TX 75001, USA
Toll Free 800.259.1986
Tel 972.248.1999
Fax 972.248.1991
info@startinternational.com
www.startinternational.com

1-26-14 Toshin-Cho
Itabashi-ku
Tokyo, Japan
Tel 81.3.3554.5608
Fax 81.3.5966.9591
japan@startinternational.com

06/07

instructions

LD
5000/5100/7000



CONTENTS

Read this user’s manual before use to ensure proper operation. Keep the manual on hand for reference in case there is a problem.

Warranty Information2

Features3

Notes3

Repair Policy3

Specifications3

Set-up4

Operation/Adjustments5

Maintenance6

Legend6

Exploded View7

WARRANTY POLICY FOR LD SERIES LABEL DISPENSERS

START International warrants all parts on LD series label dispensers against defects in design, materials and workmanship for a period of 360 days. Labor to replace defective parts will be performed at no charge for the first 120 days after date of purchase. Warranty does not cover transportation costs.

Our sole obligation under this warranty is limited to repair, replacement or credit of the purchase price, at our option, for the machines listed above, which do not perform properly the function for which they were designed.

Warranty repair is contingent upon our examination and determination that alleged defects have not been caused by misuse, abuse, improper installation or application, repair, alteration, accident or neglect in use, storage, transportation or handling.

The above warranty and remedy constitutes START International's sole liability hereunder and are in lieu and exclusive of all other warranties and remedies expressed, implied, or statutory, including, but not limited to, those of merchantability and fitness for a particular purpose.

EXPLODED VIEW

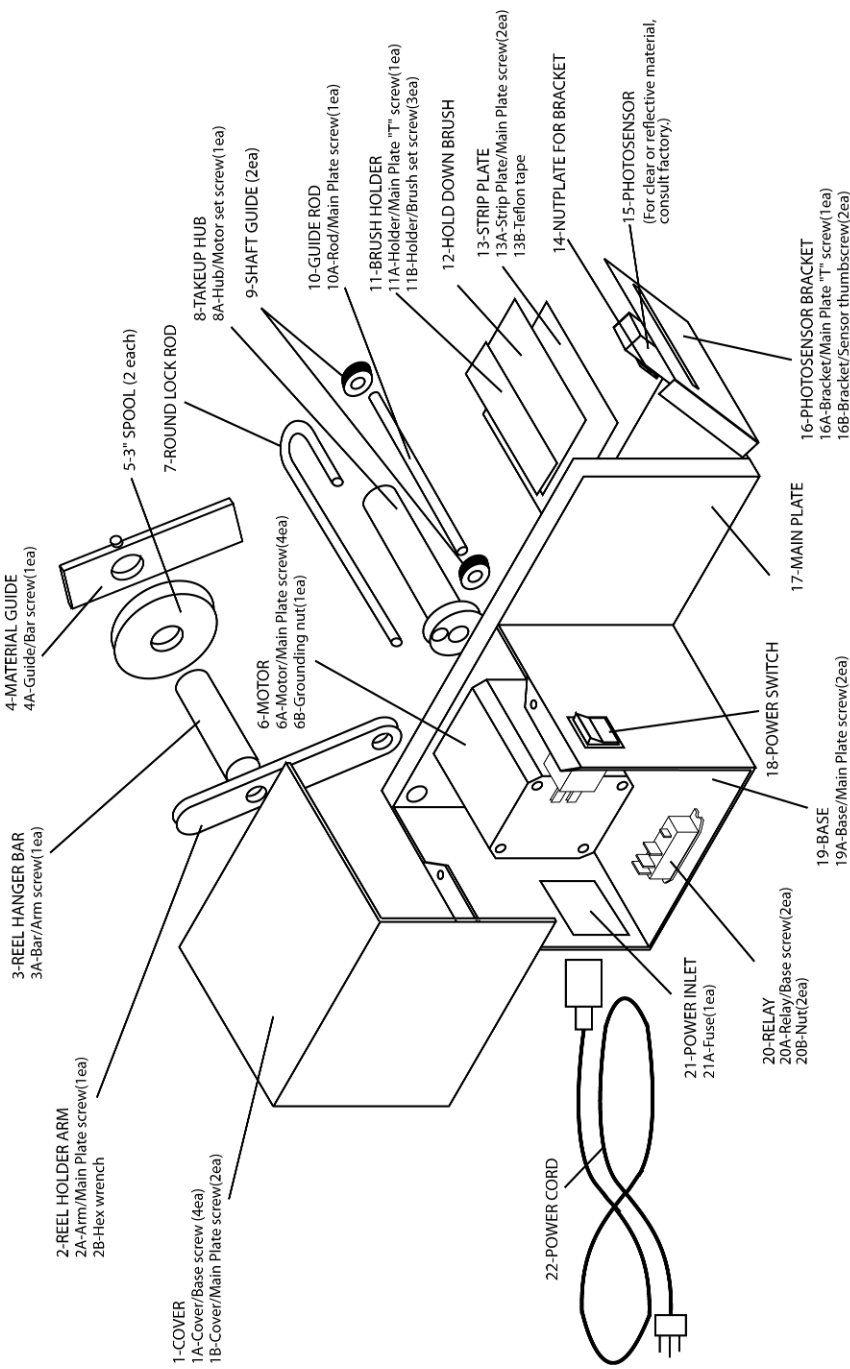

NOTE: Drawing not to scale – for reference only.

SET-UP INSTRUCTIONS

Using 5/32" (4mm) hex wrench, adjust reel holder arm to vertical.

Place the label roll on the 1" (25mm) reel hanger bar.

If roll has 3" (76.2mm) core, use plastic spool

Slide Material Guide onto reel hanger bar to hold roll against reel holder arm to ensure it is held straight.

(Hex wrench, Material Guide and spool included.)

Thread the liner under the guide rod, between the hold down pad and the strip plate, then back under the strip plate. Lay the liner across the slot in the take-up hub. Slide the lock rod into the slot to secure the liner. Align shaft guide on guide rod with edge of liner to keep material feeding straight.

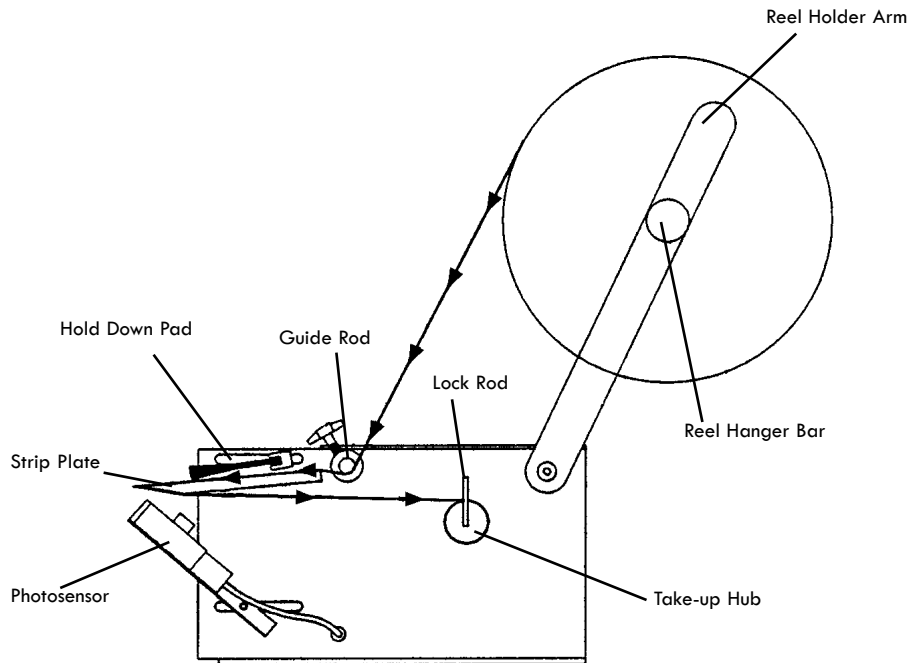

ADJUSTMENTS

Hold Down Pad:

Using the upper thumbscrew on the side of the machine, adjust the hold down pad for tensioning.

For best results, labels should be pressed firmly against the strip plate. If labels are held too tightly, they will cause excessive drag on the motor.

Photosensor:

The photosensor can be adjusted in any direction to accommodate virtually any label. Loosening the lower thumbscrew allows the photosensor to swivel and sets the overhang distance of the label over the strip plate. When the label is being fed the correct distance, tighten the lower thumbscrew.

Loosen the two screws on the front of the sensor holder to align the photosensor with the center of the label. If there are two or more labels across, align the photosensor with the last label to be removed. When these two screws are tightened, the machine is set.

Positioning of Photosensor

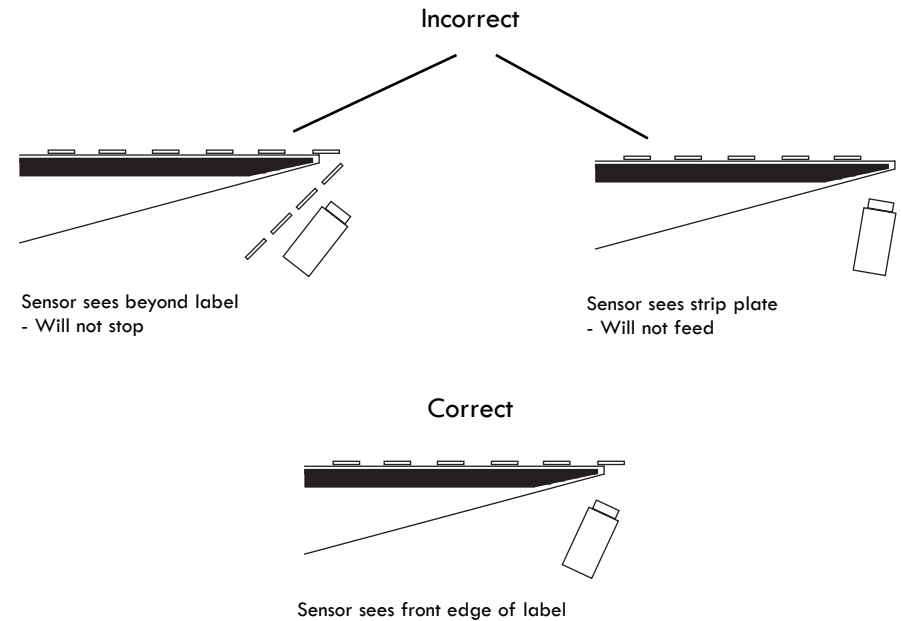

MAINTENANCE

Turn machine off when not in use. Remove liner material from take-up hub at approximately 3" in diameter or if motor appears to be straining. Do not operate machine without covers in place. Do not operate if inspection reveals a damaged power or sensor cord.

LEGEND

	Model LD5000	Model LD5100	Model LD7000
Item #	Part #	Part #	Part #
1	LD50008D	LD50008D	LD50008D
1A	LD50008-1	LD50008-1	LD50008-1
1B	LD50008-2	LD50008-2	LD50008-2
2	LD50010	LD50010	LD50010
2A	LD50010-1	LD50010-1	LD50010-1
2B	LD50010-2	LD50010-2	LD50010-2
3	LD50017	LD50017	LD70017
3A	LD50017-1	LD50017-1	LD50017-1
4	LD50023A	LD50023A	LD50023A
4A	LD50023-2	LD50023-2	LD50023-2
5	LD-SPOOL	LD-SPOOL	LD-SPOOL
6	LD50001A	LD50001B2	LD50001B2
6A	LD50001-2	LD50001-2	LD50001-2
6B	LD50018-2	LD50018-2	LD50018-2
7	LD50013D	LD50013D	LD70013B
8	LD50012D	LD50012D	LD70012C
8A	LD50012-1	LD50012-1	LD50012-1
9	LD50014-4	LD50014-4	LD50014-4
10	LD50014A	LD50014A	LD70014A
10A	LD50015-1	LD50015-1	LD50015-1
11	LD50026B	LD50026B	LD70026B
11A	LD50011-2A	LD50011-2A	LD50011-2A
11B	LD50026-1	LD50026-1	LD50026-1
12	LD50026A	LD50026A	LD70026A
13	LD50015A	LD50015A	LD70015
13A	LD50015-1	LD50015-1	LD50015-1
14	LD50011A	LD50011A	LD50011A
15	LD50002A	LD50002A	LD50002A
16	LD50011	LD50011	LD70011
16A	LD50011-2A	LD50011-2A	LD50011-2A
16B	LD50011-1	LD50011-1	LD50011-1
17	LD50007H	LD50007H	LD50007H
18	LD50003B	LD50003B	LD50003B
19	LD50009H	LD50009H	LD70009
19A	LD50007-1	LD50007-1	LD50007-1
20	LD50021S	LD50021S	LD50021S
20A	LD50005-1	LD50005-1	LD50005-1
20B	LD50021-1	LD50021-1	LD50021-1
21	LD50019	LD50019	LD50019
21A	LD50019F	LD50019F	LD50019F
22	LD50018C	LD50018C	LD50018C

FEATURES

- Will dispense butt-cut and die-cut material.
- Adjustable photosensor for pinpoint accuracy.
- Handled lock rod makes scrap removal easy.
- No tools required for adjustment.

NOTES

- Keep strip plate free of adhesive build-up.
- Clean photosensor with compressed air or dry cloth.
- Do not drop the dispenser or subject it to heavy shock.
- Turn off machine when not in use.

REPAIR POLICY

Contact START INTERNATIONAL to determine nature of problem.

Furnish START with the following information:

1. Who the unit was purchased from.
2. Model number and serial number.
3. Date purchased (copy of invoice or packing slip required).

START will issue an RGA (Return Goods Authorization) for repair.

Return machine to START by UPS, insured and prepaid.

START will notify the customer if there is a repair charge.

SPECIFICATIONS:

Model#	LD5000	LD5100	LD7000
Liner Capacity	.25" to 4.5" (6.35mm to 115mm)	.25" to 4.5" (6.35mm to 115mm)	.25" to 7" (6.35mm to 178mm)
Label Length	.125" to 7" (3.2mm to 178mm)	.25" to 7" (6.4mm to 178mm)	.25" to 7" (6.4mm to 178mm)
Roll Capacity	12" (30.5cm)	12" (30.5cm)	12" (30.5cm)
Feed Speed	1.3" / sec* (3.3cm / sec.)	2.6" / sec* (6.6cm / sec.)	2.6" / sec* (6.6cm / sec.)
Dimensions Inches	10.8 (L) x 10.8 (W) x 14.5 (H)	10.8 (L) x 10.8 (W) x 14.5 (H)	10.8 (L) x 13.2 (W) x 14.5 (H)
Centimeters	27.4 (L) x 27.4 (W) x 36.8 (H)	27.4 (L) x 27.4 (W) x 36.8 (H)	27.4 (L) x 33.5 (W) x 36.8 (H)
Weight	10.5 lb. (4.76 kg.)	10.5 lb. (4.76 kg.)	11.3 lb. (4.76 kg.)
Electrical Requirements	117V 50/60Hz, <1 amp (220V 50/60Hz available)	117V 50/60Hz, <1 amp (220V 50/60Hz available)	117V 50/60Hz, <1 amp (220V 50/60Hz available)

*at start-up