

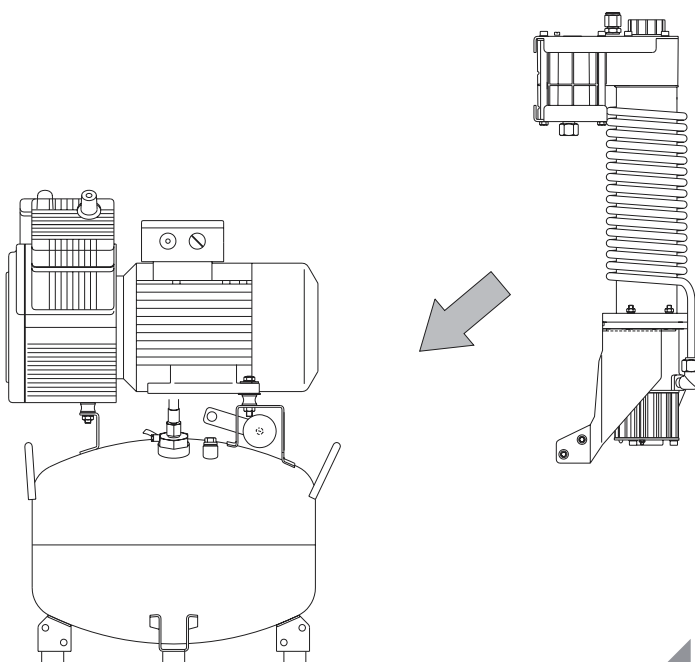

Conversion kit 1640-500-52 for compressors 51../52..



9000- 610- 23



Conversion kit 1640-500-52 for compressors 51../52..

Contents

| | |
|---|----|
| 1.Instructions | 24 |
| 1.1 Safety instructions | 24 |
| 1.2 Before conversion please note | 24 |
| 2.Contents | 24 |
| 3.Conversion | 25 |
| 3.1 Preparation of compressor without a dry air unit | 25 |
| 3.2 Close non-return valve | 25 |
| 3.3 Connect pressure hose to tank | 25 |
| 3.4 Installation of dry air system frames | 25 |
| 3.5 Mount dry air system on frames | 25 |
| 3.6 Connection of pressure hose to dry air system | 26 |
| 3.7 Mount the elbow joint on the dry air system | 26 |
| 4.System check | 26 |

1. INSTRUCTIONS

1.1 Safety instructions

When combining devices and when installing or repairing electrical devices, the relevant safety and test regulations have to be observed (VDMA 4363, VDE 0100-.., VDE 0105 Teil 1, VDE 0700 Teil 1, VDE 0701 Teil 1, VDE 0702 Teil 1, VBG1, VBG4, VBG5, VBG16. In other countries the corresponding local regulations must be observed (eg IEC, CEE).

Only use original parts for repairs, since otherwise the warranty and mark of conformity will become invalid.

1.2 Before conversion please note

Before conversion disconnect compressor from the mains supply and release air from the tank.

2. CONTENTS

Conversion kit for dry air system. 1640-500-52

| | | | |
|-----|---|--|-------------|
| 1) | 1 | Dry air system (TRL) | 1640-01 |
| 2) | 1 | Right frame | 1640-332-01 |
| 3) | 1 | Left frame | 1640-332-04 |
| 4) | 1 | Cross frame | 3411-000-01 |
| 5) | 2 | Hex. socket screws M8x60 8.8 DIN 912 | 0003-040-48 |
| 6) | 2 | Hex. nuts M8 DIN 934 | 0003-230-17 |
| 7) | 2 | Toothed washers J8,4 DIN 6797 | 0004-200-07 |
| 8) | 1 | Pressure hose | 5111-002-00 |
| 10) | 4 | Hex. nuts M6 DIN 934 | 0003-230-16 |
| 11) | 4 | Spring clips 6 DIN 7980 | 0004-700-04 |
| 12) | 2 | Coupling nuts | 9000-310-41 |
| 13) | 1 | Plug | 9000-310-63 |
| 14) | 1 | Sealing cap | 9000-412-08 |
| 15) | 1 | Elbow joint | 3910-001-01 |
| 17) | 1 | Double olive | 9000-310-42 |
| 18) | 1 | Collection tray | 3413-001-00 |
| | 1 | Instructions DÜRR Dry Air System model 1640-01 / -02 | 9000-610-34 |
| | 1 | Conversion kit 1640-500-52 for compressors 51../52... .. | 9000-610-23 |

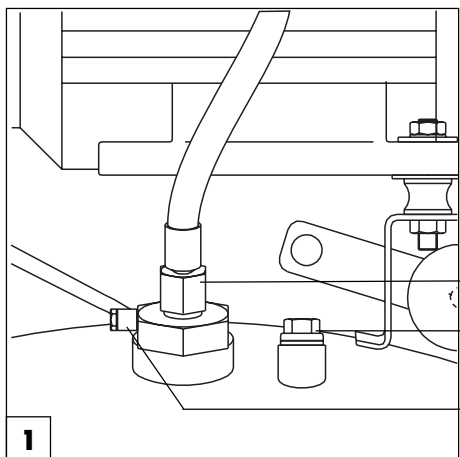

3. CONVERSION

The numbers 1-18 correspond to the numbers under **2. Contents** above.

3.1 Preparation of compressor without a dry air unit

- Drain any condensed water from tank.
- Disconnect at mains and release pressurized air from tank.
- Remove sealing cap (20).
- Unscrew pressure hose (21) at non-return valve.
- Unscrew pressure relief hose (22) from non-return valve and attach to pressure switch from relief valve.

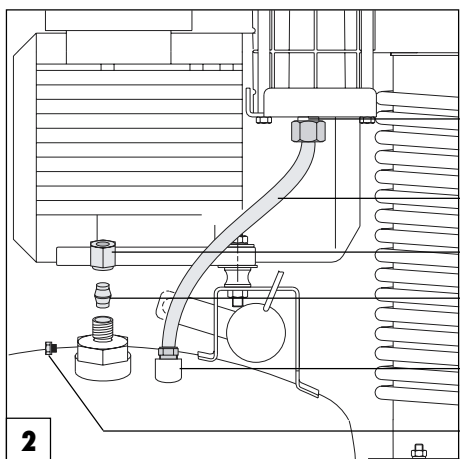

3.2 Close non-return valve

- Insert the blanking plug (14) from the side into non-return valve.
- Place plug (13) into threaded outlet at non-return valve and close with nut (12).

3.3 Connect pressure hose to tank

- Screw pressure hose (8) onto tank outlet (23).



Seal all couplings, e.g. with Teflon tape

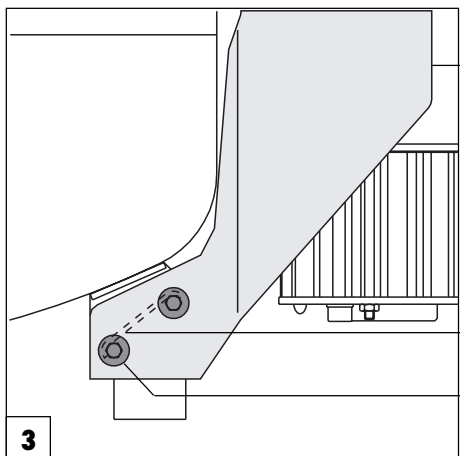

3.4 Installation of dry air system frames

- Fix right (2) and left (3) frames (for position see Fig. 4) with Hex. screws (5) M8x60, toothed washers (7) and Hex. nuts (6) to base of tank. Attach cross frame (4) as extra support onto tank floorplate over the screws.

3.5 Mount dry air system on frames

- Position the dry air system in the frame (for position see Fig. 4) and with 4 nuts (10) M6 and spring clips (11).
- Tighten the screws on the tank frames.

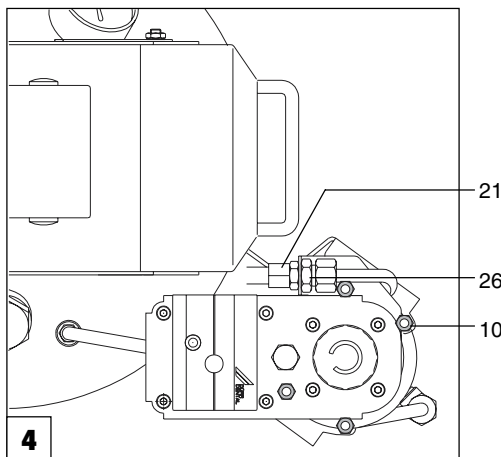

3.6 Connection of pressure hose to dry air system

- Screw the pressure hose (8) from the tank onto the outlet (24) (see Fig. 2).
- Connect the pressure hose from the compressor motor (21) onto the dry air system (26).

3.7 Mount the elbow joint on the dry air system

- Remove coupling nut (27).
- Remove plug (28) from outlet (29).
- Insert coupling nut (27) and double olive (17) into elbow joint (15) and screw tightly.
- Place plug (28) in elbow joint (15) and close with coupling nut (12).

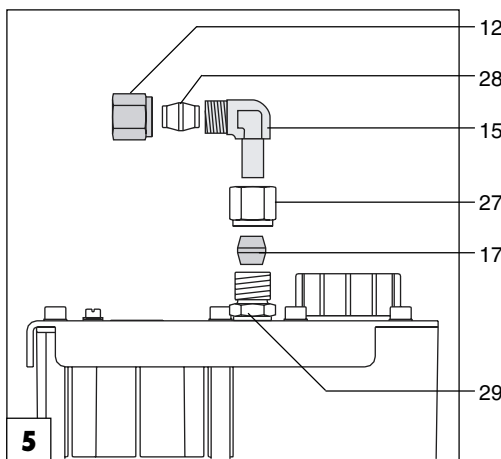

4. SYSTEM CHECK

- Check all screws and joints and tighten where necessary.

- Connect to mains and activate pressure switch.

Check On and Off-switch pressures via Manometer:

ON: 5.8bar

OFF: 7.8bar

In the case of the pressure switch needing adjustment please refer to compressor installation instructions.

- Check all joints are sealed.
- Place condensation collecting tray (18) under the dry air system.

During the first few hours of operation the compressor may restart automatically after a short period of being switched off - even when no air is being taken from the tank. In this phase the air in the tank, which is too full of moisture, is being dried.

A slight hissing noise can be heard at the muffler of the dry air system: this is moisture being removed as steam.