



IndigoVision

Complete IP Video Security Solutions



## BX600 HD Bullet Camera

Seamless Open Standard HD Video

IndigoVision's BX600 HD Bullet Camera forms part of our complete IP video security solution, fully integrated with IndigoVision's SMS4™ management software and Network Video Recorders.

The IndigoVision BX camera range provides an open standards solution while retaining the resilience of IndigoVision's unique distributed serverless architecture, with no bottlenecks and no single-point-of-failure.

- ☐ 2 Megapixel HD Progressive Scan
- ☐ Remote Zoom & Focus
- ☐ Built-in IR Illumination
- ☐ ONVIF Conformant
- ☐ H.264 Compression with up to 30fps
- ☐ Day/Night with Auto Mechanical IR filter





IndigoVision's BX camera range provides a 1080p HD resolution and conformance to the ONVIF open standard. The cameras are designed to integrate seamlessly to SMS4™ and form part of our end-to-end solution.

Built-in IR illumination provides maximum image quality in low light without the need for an additional lighting source.

A powerful remote zoom and focus feature is available as standard. This enables the camera lens to be remotely driven on-demand by any authorized user from anywhere on the IP network, simplifying installation and reducing on-going cost of ownership.

## Camera Product Codes

	Standard Lens with Remote Zoom and Focus	
	PAL Region*	NTSC Region
BX600 HD Bullet Camera	511767	511766

\* Default frame rate for PAL Region is 25fps, configurable up to 30fps.

## Recording Codes

The BX camera range conforms to the ONVIF Standard and can be recorded to any of the IndigoVision NVR-AS range. Licenses for recording can be purchased separately.

Number of Channels	1	Additional 1	1 Failover	Additional 1 Failover	Multivolume Unlimited	Multivolume Unlimited Failover
NVR-AS 3000 Recording	314001		314071		N/A	N/A
Windows NVR-AS Recording*	312001*	312551	312071*	312072	312700*	312099

\*Recording of cameras from the IndigoVision BX range requires a USB license dongle for each Windows recording server. The Windows NVR-AS software is included on the SMS4™ management software CD, **product code: 317802**

\*Includes dongle

Dimensions

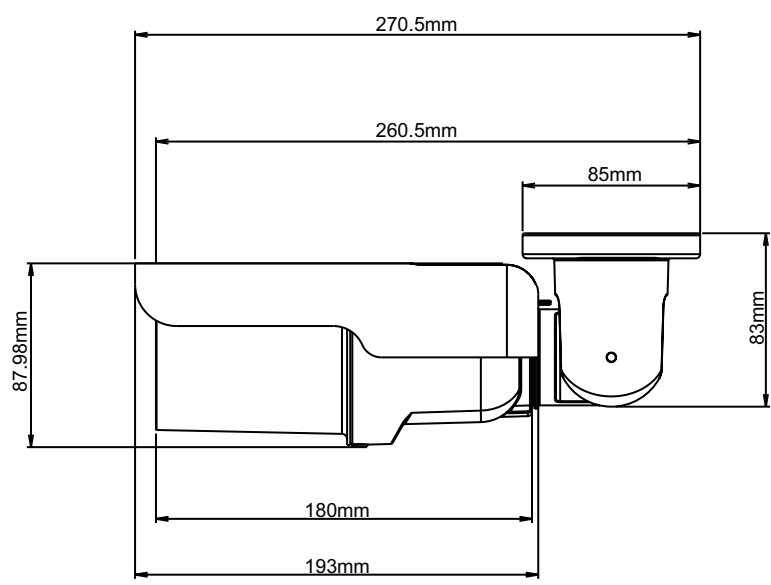

Mounting Hole Pattern

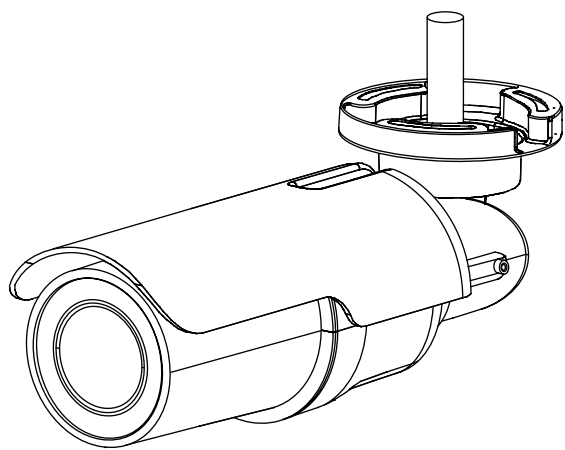
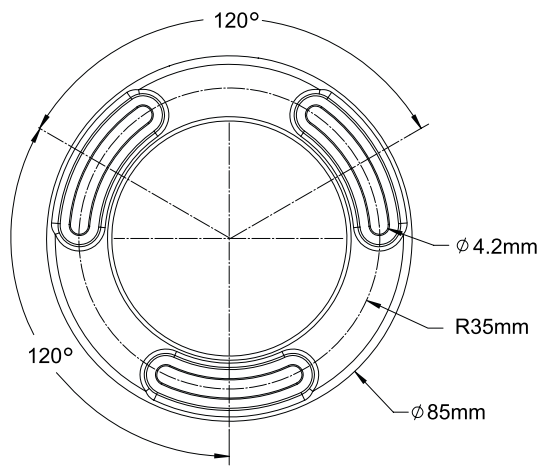

# Specification

## Camera Features

Image Sensor	1/2.7" Progressive CMOS														
Active Pixels	2 Megapixel														
Lens Options	Standard: 3mm - 9mm, Horizontal view angle 103.5° (W) 34.3° (T) , F1.2, Vari-focal, M14 mount with Remote Zoom/Focus														
Day/Night	True day/night with Mechanical IR Cut Filter														
Sensitivity (30IRE, F1.2)	Day: 0.2 lux; Night: 0.02 lux														
in IR Illuminator	850nm wavelength, effective distance 25m														
Iris Control	Auto-iris DC drive lens as standard														
WDR	Low/Medium/High														
Dynamic Range	69dB														
Gain Control	Automatic or fixed manual setting across a 40dB range														
Shutter Speeds	1 to 1/10000 sec														
White Balance Mode	Auto; Manual; ATW														
Back Light Compensation	On or Off														
Mirror Mode	On or Off														
Video Compression	Full frame rate, full color: H.264/MJPEG ; up to 30fps														
Video Bit Rate	User-configurable bit rates from 64Kbps up to 8Mbps														
Multi-streaming	<table><tr><td>Stream 1</td><td>Stream 2</td><td>Framerate</td></tr><tr><td>1080p</td><td>D1</td><td>@ 30fps</td></tr><tr><td>1080p</td><td>1080p</td><td>@ 15fps</td></tr><tr><td>720p</td><td>720p</td><td>@ 30fps</td></tr></table>			Stream 1	Stream 2	Framerate	1080p	D1	@ 30fps	1080p	1080p	@ 15fps	720p	720p	@ 30fps
Stream 1	Stream 2	Framerate													
1080p	D1	@ 30fps													
1080p	1080p	@ 15fps													
720p	720p	@ 30fps													
Resolution	1080p: 1920 x 1080 pixels; 720p: 1280 x 720 pixels; D1: 720 x 480 pixels														
Audio Input	Line in, Mic in														
Audio Output*	Line out														
Binary Input/Output	1 input ; 1 solid state opto-isolated relay output														
Analytics**	Motion Detection														
Network interface	IEEE802.3 and IETF standards: 10/100 Base-T Ethernet, TCP, UDP, ICMP, IGMP, SNMP, HTTP Up to 4 simultaneous unicast video users or unlimited multicast users														
Time	Embedded real-time clock, NTP client														
Regulatory	EN 55022(1998) ITE - Class A; EN 55024(1998) ITE immunity standard; CFR47(1995) Part 15 subpart B -Class A														
Electrical	Camera only: Power over Ethernet (802.3af Class 0) or 12V DC / 24V AC; Power consumption: 5.5W Camera including heater: 12V DC / 24V AC; Power consumption: 24W (Power supply not included)														
Housing	Diecast Aluminium Alloy with Polycarbonate sun shade														
Dimensions/Weight	84mm (dia.) x 193mm (h)/0.94Kg (with sun shade)														
Ingress Protection	IP66														
Operating Temperature	PoE powered: 0°C(32°F) to +50°C (122°F) External PSU: -30°C(-22°F) to +50°C (122°F)														
IndigoVision System Software Requirements	SMS4™ r3 or later														

\* Not currently supported in IndigoVision SMS4™

\*\* Supported with SMS4™ r5 or later