

## Type 0250

### Chain cross sections

in accordance with section in schematic illustration

### Design 0250.030

Hinged on one side,  
openable **to the outside**

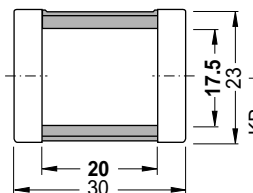
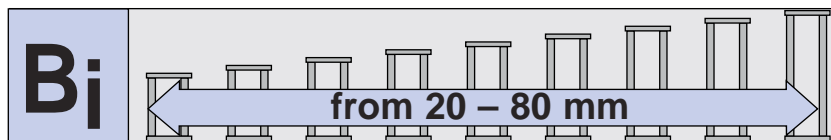
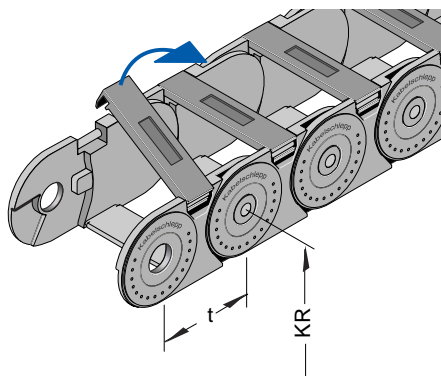

0250.030.020  
 $G_k = 0.26 \text{ kg/m}$

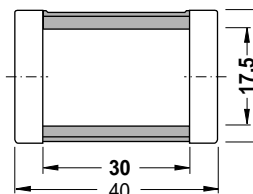

0250.030.030  
 $G_k = 0.31 \text{ kg/m}$

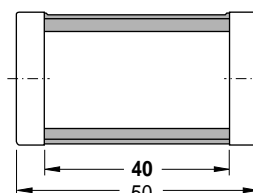

0250.030.040  
 $G_k = 0.33 \text{ kg/m}$

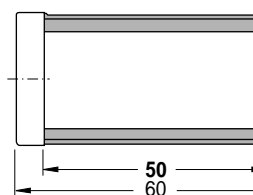

0250.030.050  
 $G_k = 0.35 \text{ kg/m}$

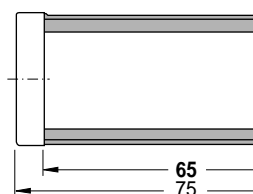

0250.030.065  
 $G_k = 0.38 \text{ kg/m}$

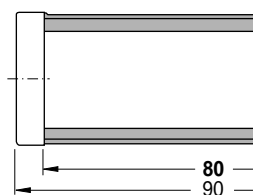

0250.030.080  
 $G_k = 0.41 \text{ kg/m}$

## Divider system TS 0

without height subdivision

$s_T = 2 \text{ mm}$

$a_{T \text{ min}} = 3 \text{ mm}$

$a_{x \text{ min}} = 6 \text{ mm}$

Please state the number of dividers/cross section  $n_T$  when ordering.

### Sample order:

Divider system  $T_S 0/n_T3$

The divider system can be planned by you or by our engineers on the basis of the information you supply about the configuration of the cable carrier.

As standard, the divider system is fitted on every 2nd chain cross section!

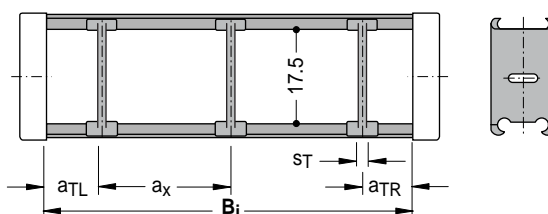

The dividers can slide along the chain cross section!